



# Churchill Gardens

, London, SW1V

**Asking price £425,000**

**\*\* SOLD OFF MARKET - SIMILAR REQUIRED \*\*** Nestled in the charming Churchill Gardens area of SW1V, this delightful one-bedroom ground floor apartment offers a perfect blend of comfort and convenience. Spanning an inviting 434 square feet, the property is in good condition and boasts an abundance of natural light, creating a warm and welcoming atmosphere throughout.

The apartment features a well-proportioned reception room, ideal for relaxation or entertaining guests. The bedroom provides a peaceful retreat, while the bathroom is thoughtfully designed for modern living. One of the standout features of this property is the private, secluded garden at the rear, offering a tranquil outdoor space to unwind and enjoy the fresh air.

Built in 1965, this apartment has been well-maintained and is ready for its new owners to move in and make it their own. With a long lease of 171 years remaining, this property presents an excellent opportunity for both owner-occupiers and investors alike.

Situated in a vibrant community, residents will benefit from easy access to local amenities, transport links, and the picturesque surroundings of Churchill Gardens. Don't miss the chance to view this charming property and experience all it has to offer.

Local Authority: Westminster  
Service Charge: Approx £2350 per annum including hot water and heating charges  
Ground Rent: £10 per annum

- One Bedroom Apartment
- Ground Floor
- Long Lease (171 Years)
- Private Garden
- Lots of Natural Light
- No Chain

## Viewing

Please contact our Intra Capital Estates Office on 0207 183 6676 if you wish to arrange a viewing appointment for this property or require further information.



## Floor Plan

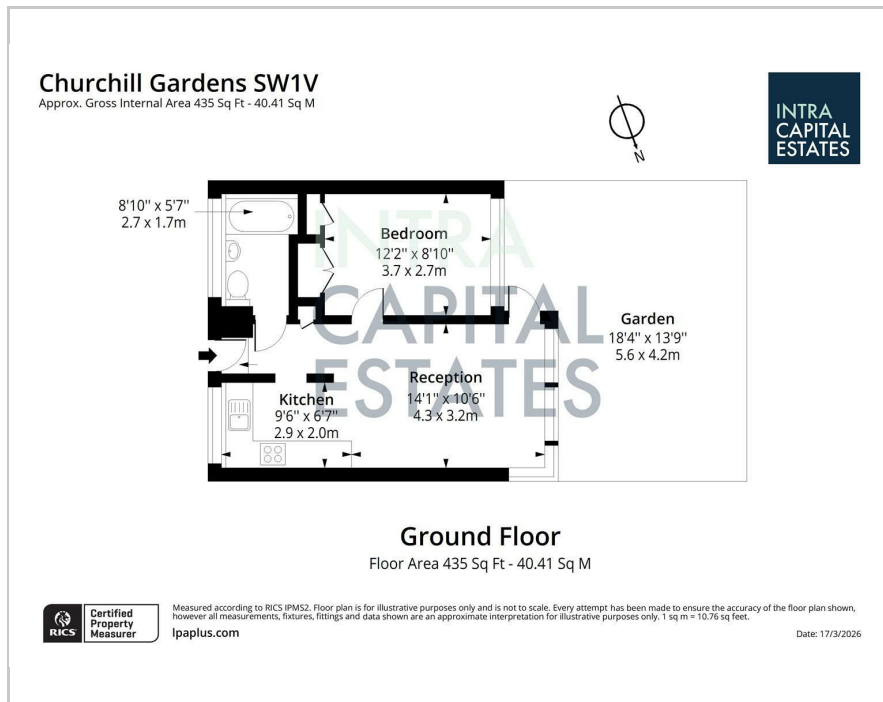

## Area Map

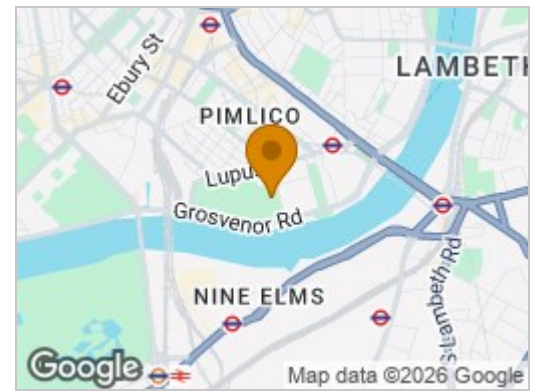

## Energy Efficiency Graph

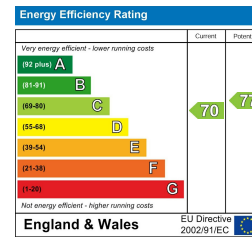

These particulars, whilst believed to be accurate are set out as a general outline only for guidance and do not constitute any part of an offer or contract. Intending purchasers should not rely on them as statements of representation of fact, but must satisfy themselves by inspection or otherwise as to their accuracy. No person in this firm's employment has the authority to make or give any representation or warranty in respect of the property.

## INTRA-CAPITAL ESTATES

Paddington Works, 8 Hermitage Street, London, W2 1BE

Tel: 0207 183 6676 Email: info@intra-capital.co.uk

www.intra-capital.co.uk

Intra-Capital Estates is a trading name of Intra Capital Estates Limited, a private limited company registered in England and Wales.  
Registered number: 11840427. VAT registration number: 31763281. Registered office Paddington Works, 8 Hermitage Street, London, W2 1BE.

## MODERN APPROACH TRADITIONAL VALUES

