

13 New Road, Darley Abbey, Derby, DE22 1DR

Offers Over £250,000

Freehold



- Three Storey Character Cottage
- Located in the Heart of Darley Abbey Village
- Ecclesbourne School Catchment Area
- Wealth of Character & Charm
- Entrance Hallway & Utility Cupboard
- Dining Kitchen & Stylish Lounge
- Three Bedrooms & Bathroom
- Small Paved Terraced Garden
- On Street Car Parking
- Close to Darley Park





Summary

CLOSE TO DARLEY PARK - This three bedroom cottage located in the heart of Darley Abbey Village and just a moments walk away from Darley Park.

The property comprises: entrance hallway, lounge, dining kitchen and utility cupboard. The first floor landing leads to bedroom two, bedroom three and bathroom. The second floor leads to bedroom one.

The property stands back from the road in an elevated and prominent position offering accommodation over three floor with character features.

To the front of the property there is a small paved garden with stone wall.

F&C

The Location

Darley Abbey Village is situated approximately 1 mile north from Derby City centre and offers an historic church, public house (The Broadway) and a regular bus service operates along Duffield Road (A6).

The beautiful Darley Park which borders Darley Abbey village offers a café, fine dining at the restaurant, Darleys, cricket ground, children's play area, canoe club and very pleasant walks along the banks of the River Derwent. It also has a nature reserve known as Nutwood.

This property is within the catchment area for Ecclesbourne Secondary School situated in Duffield. Excellent transport links are nearby with fast access on to the A6, A38, A50 and A52 leading to the M1 motorway.

Accommodation

Ground Floor

Entrance Hallway

8'2" x 3'8" (2.51 x 1.12)

Entrance through double glazed entrance door with inset glazed window into the hallway. Fitted with attractive patterned ceramic tiled flooring and fitted shelving, latched door giving access to the utility room and doorway leading to the dining kitchen.

Utility

3'8" x 3'4" (1.12 x 1.04)

Having tiled flooring, power, light, and plumbing for automatic washing machine.

Well Appointed Dining Kitchen

15'0" x 9'0" (4.58 x 2.75)

Fitted with a range of wall, base and drawer units with work surface over, stainless steel sink unit with swan neck style mixer tap, built in electric fan assisted oven, built in Zanussi four ring stainless steel gas hob with extractor hood over, display cabinet with wine rack, low level appliance space and plumbing for a slimline dishwasher and panelled glass window to the front elevation.



Lounge

14'9" x 11'8" (4.51 x 3.56)

Having a feature fireplace with inset electric fire, fitted base cupboard, beams to ceiling, oak effect laminate flooring, TV point, central heating radiator, two feature glass panelled windows to the front elevation. There is also a useful understairs storage cupboard and staircase leading to the first floor landing.



First Floor

Landing

Having further staircase leading through to the second floor landing.

Bedroom Two

10'2" x 8'10" (3.12 x 2.70)

Having built in double storage cupboard which houses the wall mounted Ideal combination boiler, central heating radiator, beams to ceiling and sash style glass panelled window to the front elevation.



Bedroom Three

8'11" x 7'1" (2.74 x 2.17)

Having central heating radiator and sash style glass panelled window to the front elevation.

Bathroom

7'6" x 5'6" (2.30 x 1.69)

Fitted with a white three piece suite comprising; bath with chrome shower over and glazed screen door, wash hand basin with storage cupboard beneath, low level WC, wall mounted mirrored cabinet, fully tiled walls and floor, extractor fan, modern chrome ladder style heated towel rail and upvc double glazed window to the side elevation.



Second Floor

Bedroom One

12'0" x 10'2" (3.68 x 3.11)

Having two built in wardrobes, central heating radiator, oak effect flooring, telephone point and sash style glass panelled window to the front elevation. There is also access to the roof space.



Outside

The property stands on an elevated and prominent position, set back from the road behind an attractive stone wall and also has a small paved garden and pathway leading to the front door.



Council Tax Band C

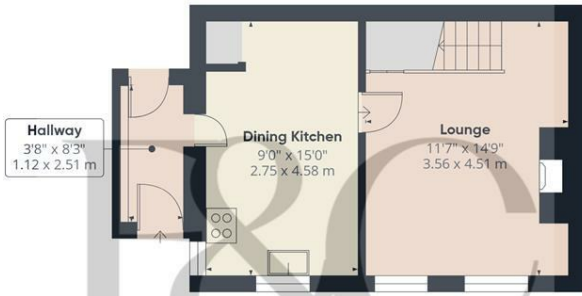

Floor 0

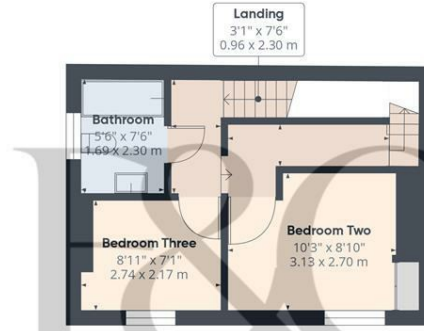

Floor 1



Floor 2

Approximate total area⁽¹⁾
739 ft²
68.7 m²

(1) Excluding balconies and terraces

Calculations reference the RICS IPMS 3C standard. Measurements are approximate and not to scale. This floor plan is intended for illustration only.

GIRAFFE360



Duffield Office

Duffield House
Town Street
Duffield
Derbyshire
DE56 4GD

01332 843390
duffield@fletcherandcompany.co.uk

Derby Office

15 Melbourne Court
Millennium Way
Pride Park
Derby
DE24 8LZ

01332 300558
derby@fletcherandcompany.co.uk

Willington Office

3 The Boardwalk
Mercia Marina
Findern Lane
Willington
Derbyshire
DE65 6DW

01283 241500
willington@fletcherandcompany.co.uk

13 New Road
Darley Abbey
Derby
DE22 1DR

Council Tax Band: C
Tenure: Freehold



Energy Efficiency Rating

	Current	Potential
<i>Very energy efficient - lower running costs</i>		
(92 plus) A		
(81-91) B		88
(69-80) C		
(55-68) D	56	
(39-54) E		
(21-38) F		
(1-20) G		
<i>Not energy efficient - higher running costs</i>		
England & Wales	EU Directive 2002/91/EC	