



EASTCOMBE AVENUE, SE7

£500,000

Terraced house
Two bedrooms
Two reception rooms
One bathroom
South facing garden
Victorian

@marshandparsons
marshandparsons.co.uk

MARSH &
PARSONS



ABOUT THE PROPERTY

This two bedroom Victorian terrace house is the perfect blank canvas. Featuring two double bedrooms, two reception room, a kitchen, and a south facing garden, the property offers excellent potential, with a scheme of works required.

Located in the highly desirable Charlton Slopes, the house is just a short walk from both Charlton and Westcombe Park stations, as well as local shops and the highly regarded Sherington Primary School. Offered chain-free.



STEP INSIDE EASTCOMBE AVENUE

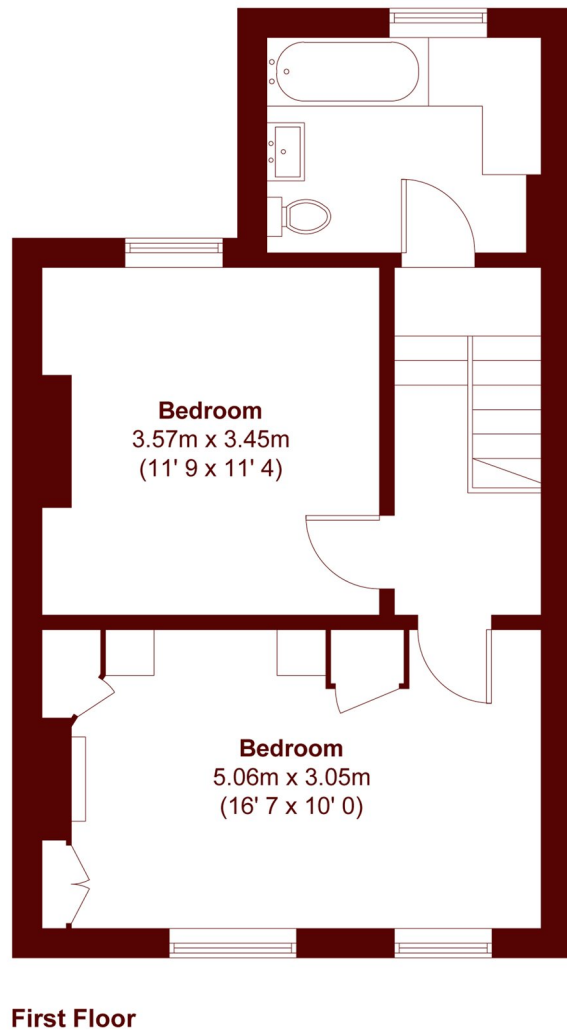
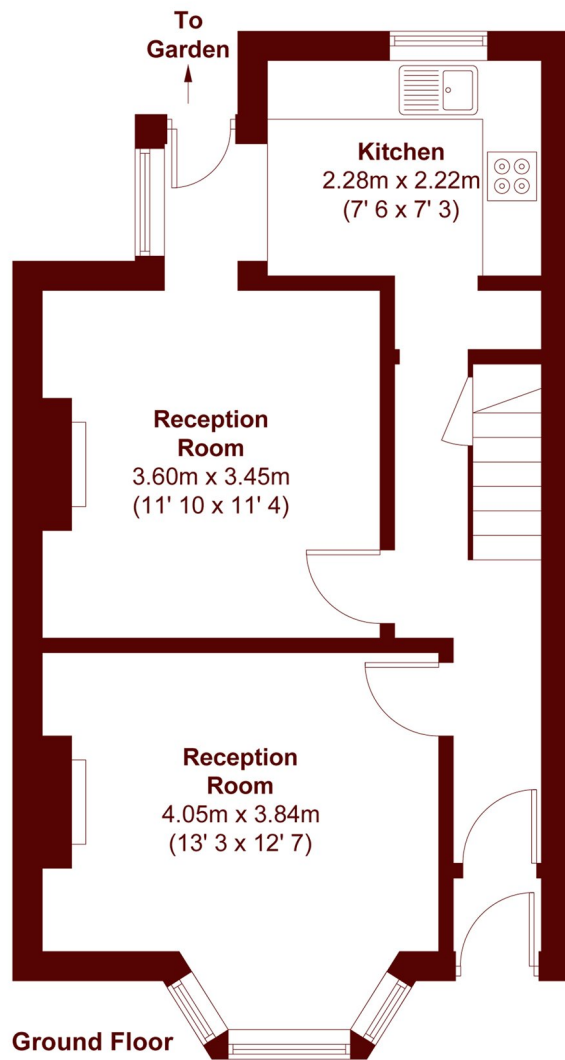

APPROX. GROSS INTERNAL FLOOR AREA
917 SQFT / 85.2 SQM

Charlton
020 8293 0454

Energy Rating: We aim to make our particulars both accurate and reliable. However, they are not guaranteed; nor do they form part of an offer or contract. If you require clarification on any points then please contact us, especially if you're traveling some distance to view. Please note that appliances and heating systems have not been tested and therefore no warranties can be given as to their good working order

**MARSH &
PARSONS**