

# KEYSTONE



St. Matthews Street, Ipswich, IP1 3EW

£500 Per Month

- Studio Apartment - West Ipswich Town Centre
- Suitable for SINGLE OCCUPIER ONLY - too small for a couple
- You will still need to pay Electric & Council Tax
- BRAND NEW REFURBISHMENT - NEW FLOORING, NEW BATHROOM, NEW SHOWER ROOM
- Gas central heating & Double Glazed
- EPC rating D
- Please note there is NO PARKING AT ALL WITH THIS PROPERTY >>>
- GAS & WATER BILLS INCLUDED
- AVAILABLE NOW

GROUND FLOOR

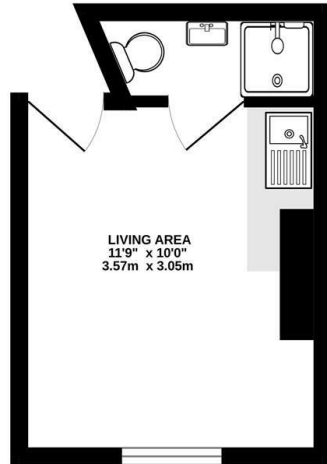

While every attempt has been made to ensure the accuracy of the floorplan contained here, measurements of doors, windows, stairs and any other items are approximate and no responsibility is taken for any error, omission or mis-statement. This plan is for information purposes only and should be used in conjunction with any prospective purchase. The services, systems and appliances shown have not been tested and no guarantee as to their operation or efficiency can be given.  
Made with Metropen 12/2016

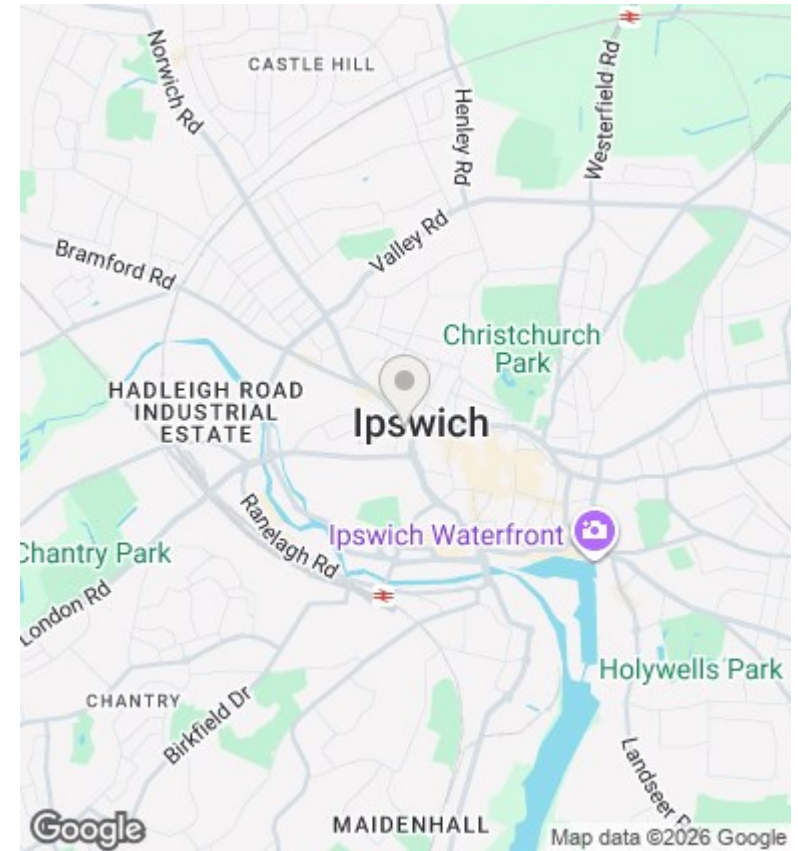

## Directions

## Viewings

Viewings by arrangement only. Call 01473 221 399 to make an appointment.

EPC Rating:  
D

Energy Efficiency Rating		Current	Potential
<i>Very energy efficient - lower running costs</i>			
(92 plus) <b>A</b>			
(81-91) <b>B</b>			
(69-80) <b>C</b>			
(55-68) <b>D</b>		59	65
(39-54) <b>E</b>			
(21-38) <b>F</b>			
(1-20) <b>G</b>			
<i>Not energy efficient - higher running costs</i>			
<b>England &amp; Wales</b>		EU Directive 2002/91/EC	