



**77, BANNOCKBURN
STREET, GREENOCK, PA16 9DF**





Description

This upgraded, beautifully presented three bedroom SEMI DETACHED VILLA offers an excellent family home within a highly desirable location. A particular feature is the driveway offering space for two cars which leads to the garage which can also be reached by a courtesy door from the rear garden.

Enjoys a corner setting at the junction with Waverley Street. Set within enclosed spacious gardens. The front garden offers a lawned area with views to cherry tree beyond. The generous sized south facing rear garden benefits from lawned and paved sections, plus a hardstand area and further plot which could be developed to create a decked area.

Specification includes: double glazing and gas central heating. Loft accessed by wooden pull down ladder with single glazed skylight. Exterior has been re-rendered in recent years. Conveniently situated for local primary and secondary schooling, amenities and transport facilities.

The stylish family apartments comprise: Entrance Hallway by UPVC double glazed door with inbuilt cupboard which has a front facing window. The bright dual aspect Lounge features windows to the front and rear with feature shelved alcove and focal point recess for housing a TV.

There is a rear facing Kitchen which with quality white high gloss units, grained style work surfaces and matching splashback. Appliances include: extractor hood, gas hob and electric oven. A UPVC double glazed door leads to the rear garden.

The downstairs luxury Shower Room with side window features a quality three piece suite offering: vanity wash hand basin set within white high gloss unit, wc and double sized shower cubicle with chrome style shower. Additional benefits include: wet wall panelling, chrome heated towel rail and decorative panelled ceiling with downlighters.

A staircase leads to the Upper Landing with front window and hatch to the loft. There are three double sized Bedrooms which is perfect for family living.

Viewing is essential. EPC = C.

Measurements

Hallway

Lounge

3.33m x 5.61m (10'11 x 18'5)

Kitchen

1.93m x 3.91m (6'4 x 12'10)

Downstairs Shower Room

Upper Landing

Bedroom 1

2.90m x 4.42m (9'6 x 14'6)

Bedroom 2

4.39m x 2.79m (14'5 x 9'2)

Bedroom 3

3.35m x 2.54m (11'0 x 8'4)

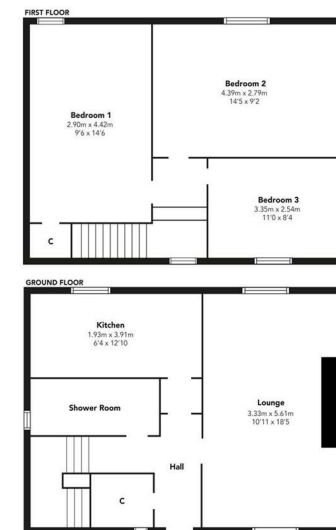

Floorplans are indicative only - not to scale
Produced by Pushplains Ltd











The
next
step..



To view call 01475 888400. Speak to us 7 days a week until 11pm every day to book your viewing appointment.

House to sell or rent?

Call 01475 888400 to book your free market appraisal.

Require a solicitor?

Ask us to supply a free legal quotation from Neill Clerk & Murray, Solicitors.
www.neillclerkmurray.co.uk

Stay fully up-to-date by following Neill Clerk on:



**60 West Blackhall Street
Greenock
Renfrewshire
PA15 1UY**

t: 01475 888400

e: sales@neillclerk.co.uk

w: www.neillclerk.co.uk



Agents Notes:

These sales particulars are set out as a general outline only, issued in good faith, but do not constitute representations of fact and do not form part of any offer or contract. Any services, equipment, appliances, fittings or central heating systems have not been tested and no warranty is given or implied that these are in working order. All measurements are approximate and for guidance only.

Neither Neill Clerk Estate Agents nor any of its employees or agents has any authority to make or give any representation or warranty whatever in relation to this property.