



## Woodcock Lane

, Lincoln, LN1 2BE

Offers over £150,000



An impressive luxury lodge situated in the private and quiet exclusive location of Burton Waters. The development is fully serviced by Burton Waters security with electric gates and telecom entry. Burton Waters is conveniently located within a ten minute drive from the Cathedral city of Lincoln with regular bus routes and has it's own access of restaurants and David Lloyd leisure centre.



## Description

Over 45's - An impressive luxury lodge situated in the private and quiet exclusive location of Burton Waters.

The accommodation briefly comprises of an entrance hallway, living / dining room, kitchen, two bedrooms, master with en-suite shower room and a main bathroom, further benefiting from a driveway, garden to one side and a balcony with stunning lakeside views. The lodge in total is 40fy x 21ft .

## Hallway

The lodge is entered through the side upvc into the hallway with carpet and storage cupboard.

## Lounge / Diner 21'2" x 18'4" (6.47m x 5.59m)

The lounge / diner is a generous size with dual aspect windows with two sets of UPVC French doors looking out over the water, carpet and a centre feature of a fire place with an electric fire as secondary heating. There are wall lights and recess ceiling lights in the pine panelled ceiling.

## Kitchen

The kitchen is open plan with a side facing window and Velux window, recess lighting, a range of wall and base units of a timeless cream in colour, integrated fridge / freezer, Samsung induction four ring hob, fan assisted oven, with a Candy chrome extractor and microwave. The worktops are butcher block effect with a breakfast bar for less formal dining. The central heating boiler, Ideal Logic Combi C30 is located in a larder cupboard in the kitchen.

## Master Bedroom 12'4" x 10'4" (3.78m x 3.16m)

The master bedroom is a double room to the back of the lodge with bed side cabinets and chest of drawers, carpet and side facing window, recess lighting and radiator.

## Dressing Area

Leading through from the master bedroom there is a dressing area with three double built in wardrobes leading on to the en suite.

## En Suite 7'2" x 5'9" (2.20m x 1.76m)

A modern shower room en suite with a corner cubicle and pump fed shower, wc and circular hand basin in a dark wood unit with a mirror. Recess lighting and part tiled walls.

## Bedroom Two 11'1" x 10'3" (3.40m x 3.14m)

A double bedroom with a side facing upvc window, built in wardrobe, carpet, radiator, and bed side cabinets.

## Bathroom 7'5" x 7'3" (2.27m x 2.22m)

In the same design as the en suite there is a modern bathroom comprising of a bath, wc and circular hand basin in a dark wood unit with a mirror. Part tiled walls and recess lighting.

## Outside

The park home is a gated secure park. There is a side garden and parking. Views over looking the water from the wrap round veranda.

## Disclaimer

1. MONEY LAUNDERING REGULATIONS: Intending purchasers will be asked to produce identification documentation at a later stage and we would ask for your co-operation in order that there will be no delay in agreeing the sale.
2. General: While we endeavour to make our sales particulars fair, accurate and reliable, they are only a general guide to the property and, accordingly, if there is any point which is of particular importance to you, please contact the office and we will be pleased to check the position for you, especially if you are contemplating travelling some distance to view the property.
3. Measurements: These approximate room sizes are only intended as general guidance. You must verify the dimensions carefully before ordering carpets or any built-in furniture.
4. Services: Please note we have not tested the services or any of the equipment or appliances in this property, accordingly we strongly advise prospective buyers to commission their own survey or service reports before finalising their offer to purchase.
5. THESE PARTICULARS ARE ISSUED IN GOOD FAITH BUT DO NOT CONSTITUTE REPRESENTATIONS OF FACT OR FORM PART OF ANY OFFER OR CONTRACT. THE MATTERS REFERRED TO IN THESE PARTICULARS SHOULD BE INDEPENDENTLY VERIFIED BY PROSPECTIVE BUYERS OR TENANTS. NEITHER Clark Estates OR ANY OF ITS EMPLOYEES OR AGENTS HAS ANY AUTHORITY TO MAKE OR GIVE ANY REPRESENTATION OR WARRANTY WHATEVER IN RELATION TO THIS PROPERTY.

## Area Map



## Floor Plans

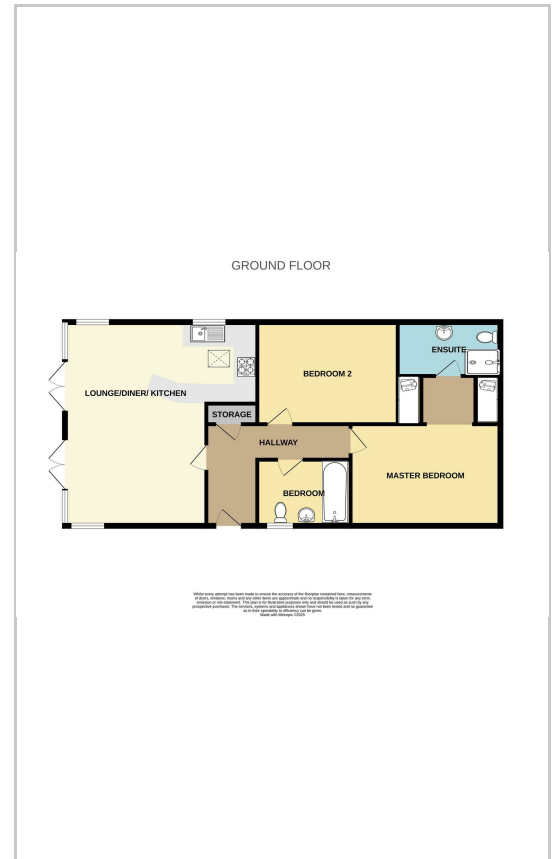

## Energy Efficiency Graph

Energy Efficiency Rating		
	Current	Potential
Very energy efficient - lower running costs		
(92 plus) A		
(81-91) B		
(69-80) C		
(55-68) D		
(39-54) E		
(21-38) F		
(1-20) G		
Not energy efficient - higher running costs		
England & Wales		EU Directive 2002/91/EC

These particulars, whilst believed to be accurate are set out as a general outline only for guidance and do not constitute any part of an offer or contract. Intending purchasers should not rely on them as statements of representation of fact, but must satisfy themselves by inspection or otherwise as to their accuracy. No person in this firm's employment has the authority to make or give any representation or warranty in respect of the property.

14-16 Eldon Street, Tuxford, NG22 0LH

Tel: 01777 801 901 Email: dawn@clark-estates.co.uk www.clark-estates.co.uk