

# Henleaze Road

## HENLEAZE

APPROXIMATE FLOOR AREA  
92 SQM / 990 SQFT



FIRST FLOOR

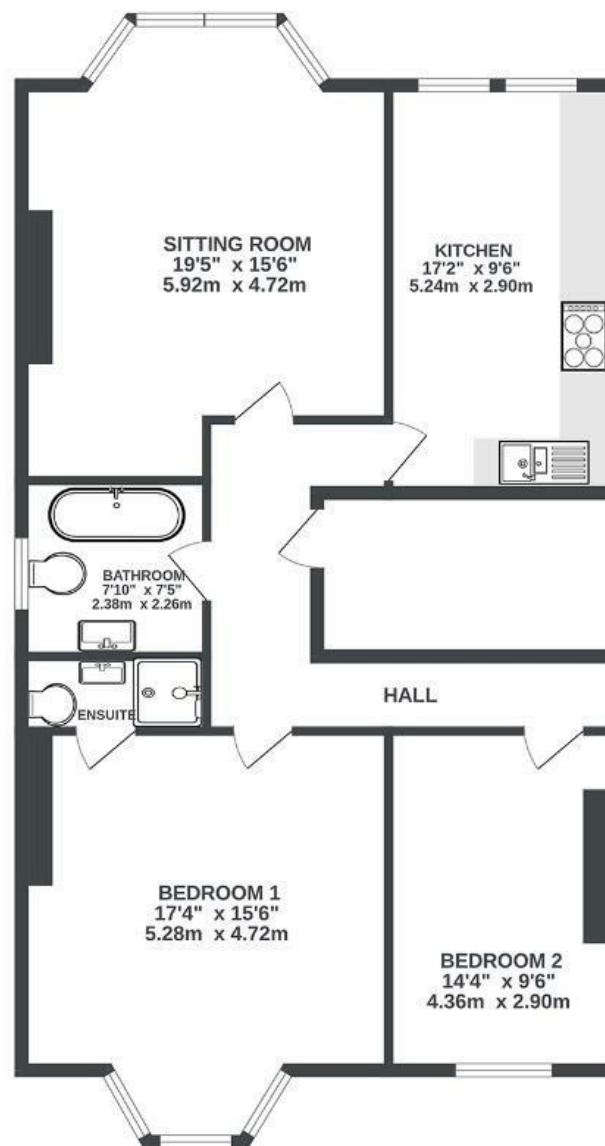

GARAGE

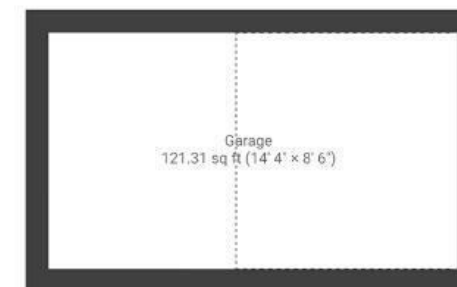

Boardwalk

# Henleaze Road

, BRISTOL

£

£475,000



BS9 4EY

zzz

2 Bedrooms



2 Bathrooms

*"We have many happy memories of living here! We love sitting in the lounge as the sun shines through the stained glass windows and enjoy watching peaceful sunsets from the bedrooms. We often wander into Henleaze to grab a coffee, go to the gym or browse the shops. It is a wonderful community and we often bump into friends on the high street. The Downs are at the end of the road, where we love to go for a run. We are sad to leave, but hope the next owners enjoy it here as much as we have!"*

