



37 Darwin Crescent, Torquay - TQ2 7FL

Offers Over **£360,000**

ABSOLUTE
SALES & LETTINGS





37 Darwin Crescent

Torquay

A beautifully upgraded 4 bedroom townhouse with parking, garage, superb landscaped garden, hot tub, and spacious family accommodation.

Council Tax band: D

Tenure: Freehold

EPC Energy Efficiency Rating:

EPC Environmental Impact Rating:

- Spacious four bedroom semi-detached townhouse set within Phase 3 of The Willows development.
- Extensively updated and improved by the current owners.
- Driveway parking for two vehicles, covered carport with EV charger and large integral garage.
- Flexible ground floor double bedroom, ideal for guests, teenagers or home working.
- Generous kitchen dining room with peninsula, pull out pantry and integrated appliances.
- Full width lounge with French doors opening directly onto the garden.
- Beautifully landscaped rear garden with outdoor kitchen, hot tub and lighting.
- 4 double beds, 2 shower rooms, 2 separate WC
- Principal bedroom with built in wardrobe and upgraded en-suite shower room.
- Cul de sac location within a popular and convenient residential area.



37 Darwin Crescent

Torquay

Darwin Crescent sits within the popular Willows area of Torquay, forming part of a modern residential development well placed for families, professionals and buyers relocating into the area.

The property is positioned in Phase 3 of the newer section of The Willows, with the benefit of a cul de sac setting while still being close to everyday conveniences. For shopping and day to day amenities, The Willows is one of Torquay's most practical locations. Wren Retail Park is nearby and includes major national retailers, with M&S Foodhall, Sainsbury's, Boots, Next and other useful stores in the area, making weekly shopping and errands very straightforward. The wider retail offering around The Willows, Bridge Retail Park and nearby out of town shopping areas gives buyers excellent convenience without needing to travel into the town centre. Families are well served locally, with a choice of primary and secondary schooling within the wider Torquay area. Nearby options include schools around Shiphay, Barton and The Willows, while Torquay Boys' Grammar School, Torquay Girls' Grammar School and Torquay Academy are all established secondary options in Torquay.

Absolute Sales & Lettings

Absolute Sales & Lettings Ltd, 13 Ilsham Road - TQ1 2JG

01803 214214

torquay@movewithabsolute.co.uk

movewithabsolute.co.uk/



Ground Floor

Approx. 34.2 sq. metres (368.3 sq. feet)

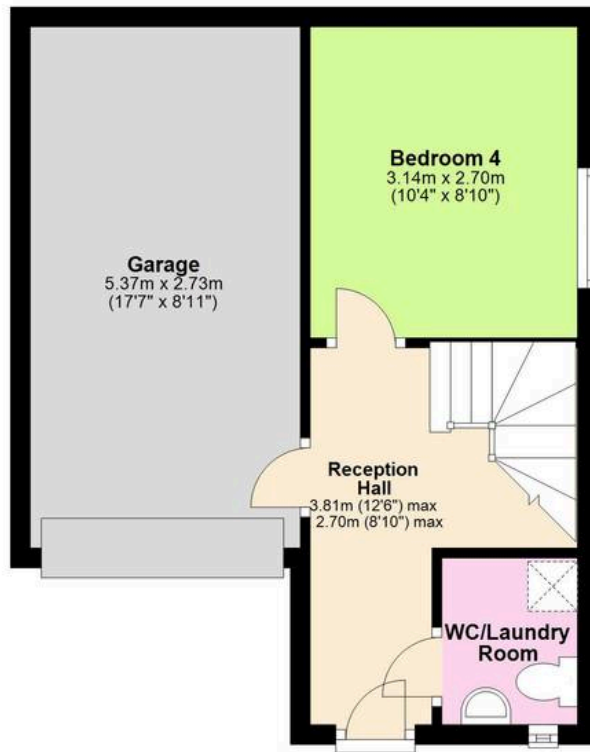

First Floor

Approx. 42.5 sq. metres (457.9 sq. feet)

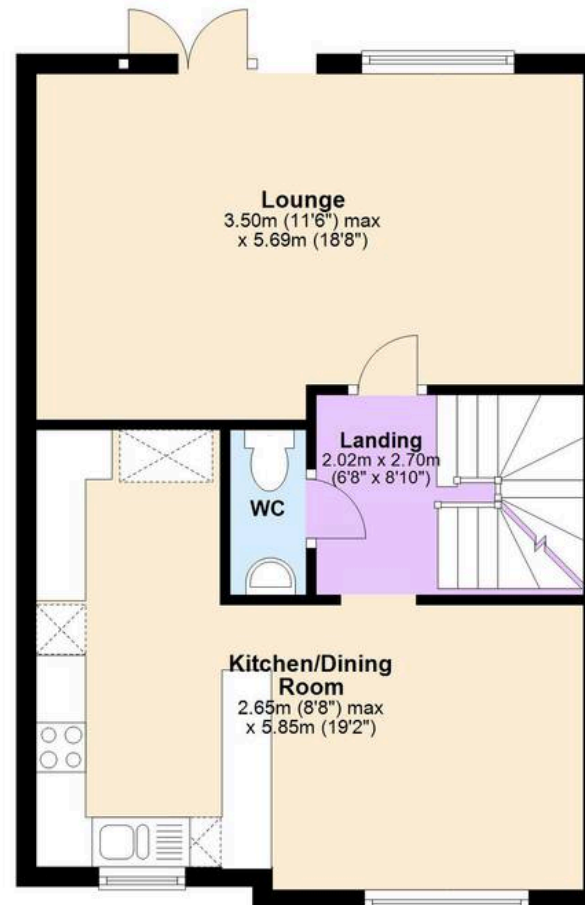

Second Floor

Approx. 47.2 sq. metres (508.0 sq. feet)

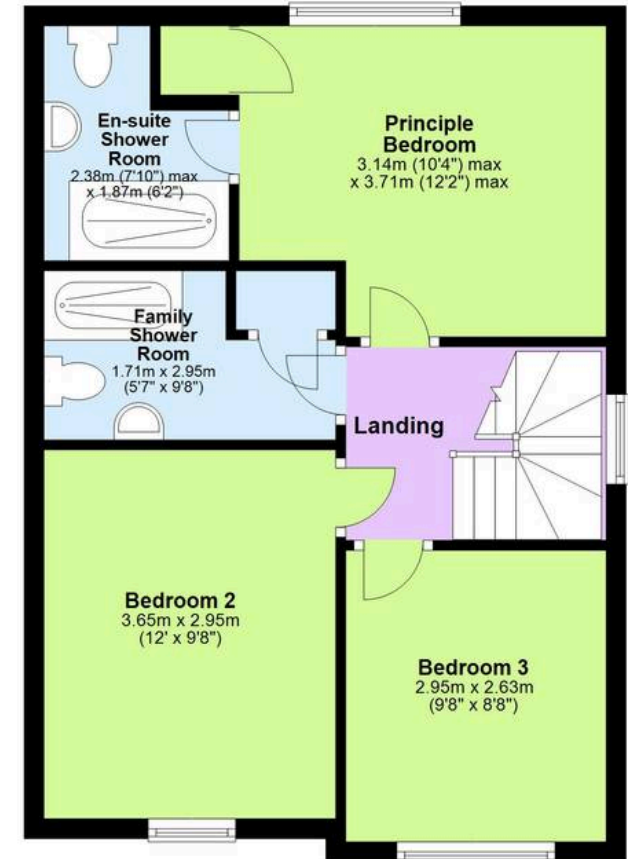

Total area: approx. 123.9 sq. metres (1334.1 sq. feet)