



42D 070035 Park Square North, Leeds, West Yorkshire, LS1 2NP

£1,350 PCM

**SW**  
RESIDENTIAL

- Grade II Listed Building
- First Floor
- Southerly Aspect
- Two Double Bedrooms
- Council Tax Band E
- Newly Decorated And New Carpets
- Excellent Views Over Park Square
- Property Has No Parking
- Furnished
- Available Now

## THE PROPERTY

Welcome to this charming apartment located in the sought-after Park Square North in Leeds. This Grade II listed building boasts a rich history and is filled with original features that add character and charm to the property.

The apartment features a light, spacious living area, two double bedrooms and two bathrooms, convenience is key in this property, ensuring that you have privacy and comfort. The older age of the property adds to its unique appeal, making it a standout choice for those who appreciate historical architecture.

The apartment has recently undergone a facelift with new carpets, decor and lighting give it a new fresh look throughout.

Situated in the heart of Leeds, this apartment offers a prime location with easy access to amenities, transport links, and green spaces. Whether you enjoy a leisurely stroll in the park or exploring the vibrant city life, this property caters to all lifestyles.

Don't miss the opportunity to own a piece of history in this Grade II listed building. Embrace the elegance of the past while enjoying the comforts of modern living in this delightful apartment. This property has not got Parking.

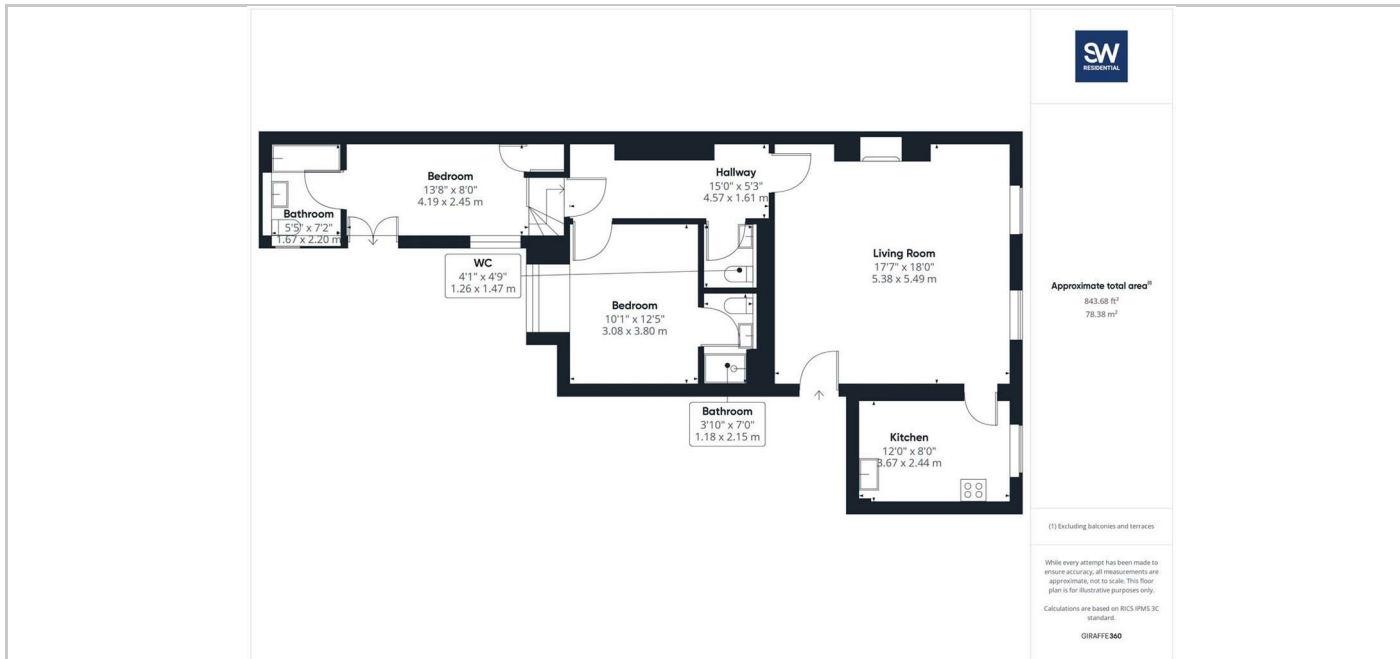

## SITUATION

## Directions

6th Floor Central Square, 29 Wellington Street, West Yorkshire, LS1 4DL  
 Tel: 0113 221 6000 Email: residential@sw.co.uk