



BRENNAN
BESPOKE

£220,000

Leeson Crescent

Kettering, NN15 6SY

PROPERTY SUMMARY

A beautifully presented two bedroom semi detached home, ideally located in the popular area of Barton Seagrave. Offering spacious living accommodation and an impressive rear garden, this property is perfect for first time buyers, downsizers or anyone looking for a home with great indoor and outdoor space.

Inside, the layout is both practical and welcoming. The kitchen diner provides a great space for everyday meals and entertaining, while the extended lounge diner offers a generous main living area with plenty of room to relax and host family and friends. The flow of the ground floor works brilliantly for modern living, with light filled rooms and a comfortable feel throughout. Upstairs, there are two double bedrooms and a family bathroom, making this an ideal home for a range of buyers.

Outside, the large rear garden is a real highlight, offering excellent space for outdoor dining, play, gardening or simply enjoying the warmer months.

2



1



1





BRENNAN
BESPOKE

OFFICE ADDRESS
BRENNAN BESPOKE
2 The Tithe Barn Glendon Lodge Farm
Glendon
Kettering
Northamptonshire
NN14 1QF

OFFICE DETAILS
01536 904400
info@brennanbespoke.co.uk
<https://www.brennanbespoke.co.uk>

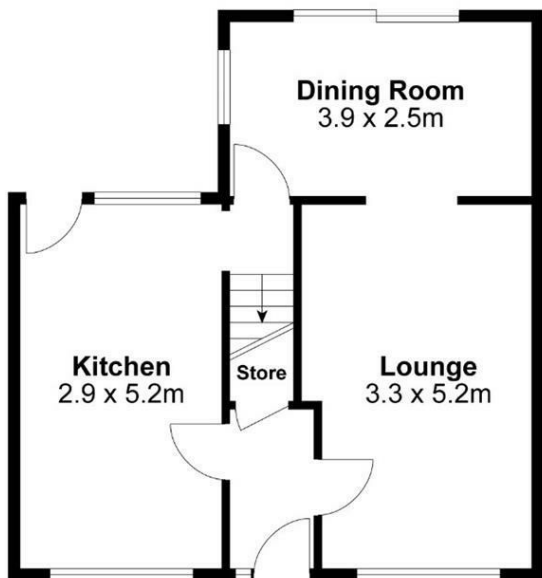

Ground Floor



First Floor

Internal Area Approx. : 968 ft²

For identification only not to scale

BRENNAN
BESPOKE

LOCAL AUTHORITY
North Northamptonshire

TENURE
Freehold

COUNCIL TAX BAND
A

VIEWINGS
By prior appointment only

Energy Efficiency Rating		Current	Potential
Very energy efficient - lower running costs			
(92 plus) A			
(81-91) B			
(69-80) C			
(55-68) D			
(39-54) E			
(21-38) F			
(1-20) G			
Not energy efficient - higher running costs			
England & Wales		EU Directive 2002/91/EC	

Agents Note: Whilst every care has been taken to prepare these particulars, they are for guidance purposes only. All measurements are approximate and are for general guidance purposes only and whilst every care has been taken to ensure their accuracy, they should not be relied upon and potential buyers/tenants are advised to recheck the measurements