



5 The Cottages, Lower Street, Salisbury, Wiltshire, SP2 8HB

£295,000 Freehold

About The Property

The property is a charming and characterful Grade II listed three double bedroom terraced house with accommodation arranged over three floors.

The property is in excellent order having been redecorated throughout and has some period features including fireplaces and exposed beam work.

The accommodation comprises a sitting room which has cupboards housing the gas and electric meters and a window to the front elevation. There is a doorway to access the stairs and the kitchen/breakfast room which has an excellent range of cream fronted base and wall units with tiled splashbacks, an integrated oven and hob and space for a fridge/freezer, washing machine and a table and chairs. There is also a useful understair storage cupboard.

A door leads in to a rear lobby where there is a cloakroom and a further door accesses the rear of the property.

On the first floor there are two double bedrooms with an en suite shower room and a staircase to the second floor accessed from the rear bedroom. The shower room has a white suite and a heated towel rail. On the second floor is a further bedroom with sloping ceilings, a velux window to the rear and eaves storage areas. Further benefits include gas central heating, a gravelled area to the rear as well as a useful solid storage shed.

The property is situated in a very popular area within walking distance of the city centre via the town path, and a primary school and convenience stores lie nearby. There are countryside walks nearby and there is also a bus service to the city centre. The hospital also lies approximately two miles away. The property is offered with no onward chain.



- Character three double bedroom house
- Grade II listed
- Sitting room
- Kitchen/breakfast room
- Rear lobby and cloakroom
- Two FF bedrooms
- En suite shower room
- Second floor bedroom
- Gravelled outside space
- No chain





Further Information

Local authority: Wiltshire Council

Council Tax: C - £2350.54 (2025/2026)

Tenure: Freehold

Services: Mains gas, electricity, water and drainage.

Heating: Gas heating with radiators.

Directions: Leave Salisbury via Exeter Street and continue over the roundabout into Newbridge Road. At the Harnham Gyratory turn right onto Harnham Road. Turn right after the second traffic lights into Lower Street where the property can be seen on the right hand side.

What3words: ///clips.shapes.unions



Ground Floor

Approx. 30.5 sq. metres (328.6 sq. feet)

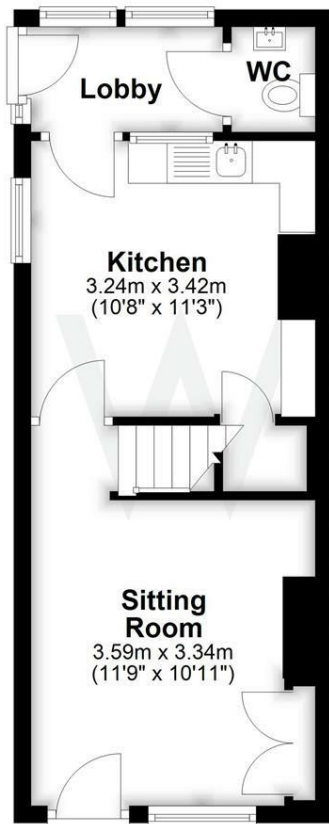

First Floor

Approx. 29.3 sq. metres (315.4 sq. feet)

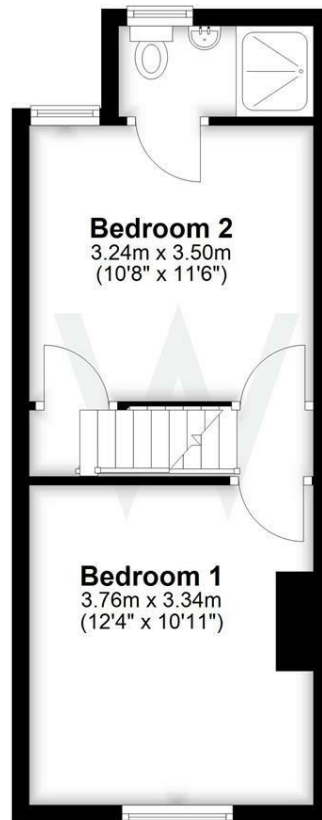

Second Floor

Approx. 17.3 sq. metres (186.2 sq. feet)

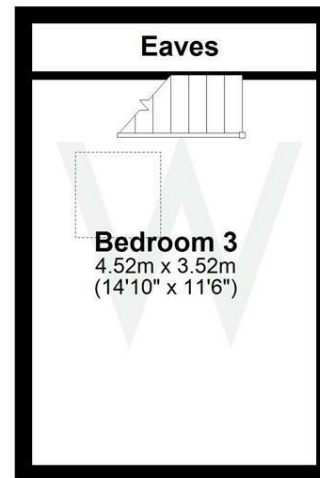

Total area: approx. 77.1 sq. metres (830.2 sq. feet)