



Ideal Family Home in Sought After Dersingham

what3words: emeralds.guessing.spoiled

£395,000

Bedrooms: 4 | Bathrooms: 2 | Receptions: 2

A Beautiful Family Home in the Heart of Dersingham

Nestled within the highly sought-after village of Dersingham, renowned for its strong sense of community, excellent local amenities and easy access to both the stunning North Norfolk coastline and the nearby Sandringham Estate, this beautifully presented four-bedroom detached home offers the perfect blend of space, comfort and versatility for modern family living.

Stepping through the front door, you're immediately welcomed by a bright and inviting entrance hall that sets the tone for the rest of the property. To your left, a dedicated home office provides the perfect space for remote working, studying or managing day-to-day life, while a convenient downstairs WC adds further practicality.

As you continue through the home, you'll discover a wonderfully spacious kitchen that is sure to become the hub of everyday living. Overlooking the rear garden, this well-equipped space offers an abundance of storage and generous worktop space, making everything from busy family breakfasts to entertaining friends a pleasure. Just beyond, the utility room provides valuable additional storage and direct access to the garden, helping to keep muddy boots, pets and outdoor adventures neatly contained.

The true heart of the home lies on the opposite side of the property. Here, a spacious living and dining room creates a welcoming environment where the family can come together, whether that's enjoying cosy evenings, hosting celebrations or simply unwinding after a busy day. Flowing seamlessly from this space is the delightful conservatory, a room flooded with natural light that beautifully connects the indoors with the garden beyond. It's the perfect spot to enjoy a morning coffee, lose yourself in a good book or watch the seasons change throughout the year.

Upstairs, the sense of space continues. The property offers three generous double bedrooms alongside a comfortable single bedroom, providing flexibility for growing families, guests or those seeking additional workspace. The principal bedroom enjoys the luxury of a modern en-suite shower room, creating a peaceful retreat at the end of the day, while the remaining bedrooms are served by a well-appointed family bathroom.

Outside, the property continues to impress. The rear garden has been thoughtfully designed to offer the best of both worlds, with a combination of lawn and seating areas creating space for children to play, summer barbecues with friends, or simply relaxing in the sunshine. To the side, ample off-road parking is complemented by an EV charging point, ensuring the home is ready for modern living. Adding even more versatility, the former garage has been converted into a contemporary office/snug, offering a fantastic additional space that could serve as a home workspace, hobby room, games room or cosy retreat.

Offering space to grow, areas to entertain and a location that perfectly balances village charm with everyday convenience, this wonderful home is ready for its next chapter.

Tenure: Freehold

Property Type: Detached House

- Detached House
- Four Bedrooms
- Perfect Family Home
- No Onward Chain
- Sought After Location
- Gas Central Heating
- En-Suite to Bedroom One
- Off-Road Parking
- Downstairs WC
- Conservatory

Disclaimer

1. To meet money-laundering regulations, all buyers will need to complete an ID check. We'll ask you to provide the necessary documents, and there's a small fee of £20.50 per client for this service.
2. We do our best to make sure our property details are fair, accurate, and up to date, but they're meant as a general guide only. If there's anything particularly important to you, please get in touch, we'll be happy to look into it further.
3. All measurements are provided as a guide and may not be exact.
4. We haven't tested any of the property's services, equipment, or appliances. We recommend that buyers arrange their own survey or service checks before making a final offer.
5. These details are provided in good faith, but they don't form part of any offer or contract. Buyers should verify any points that are important to them before proceeding.



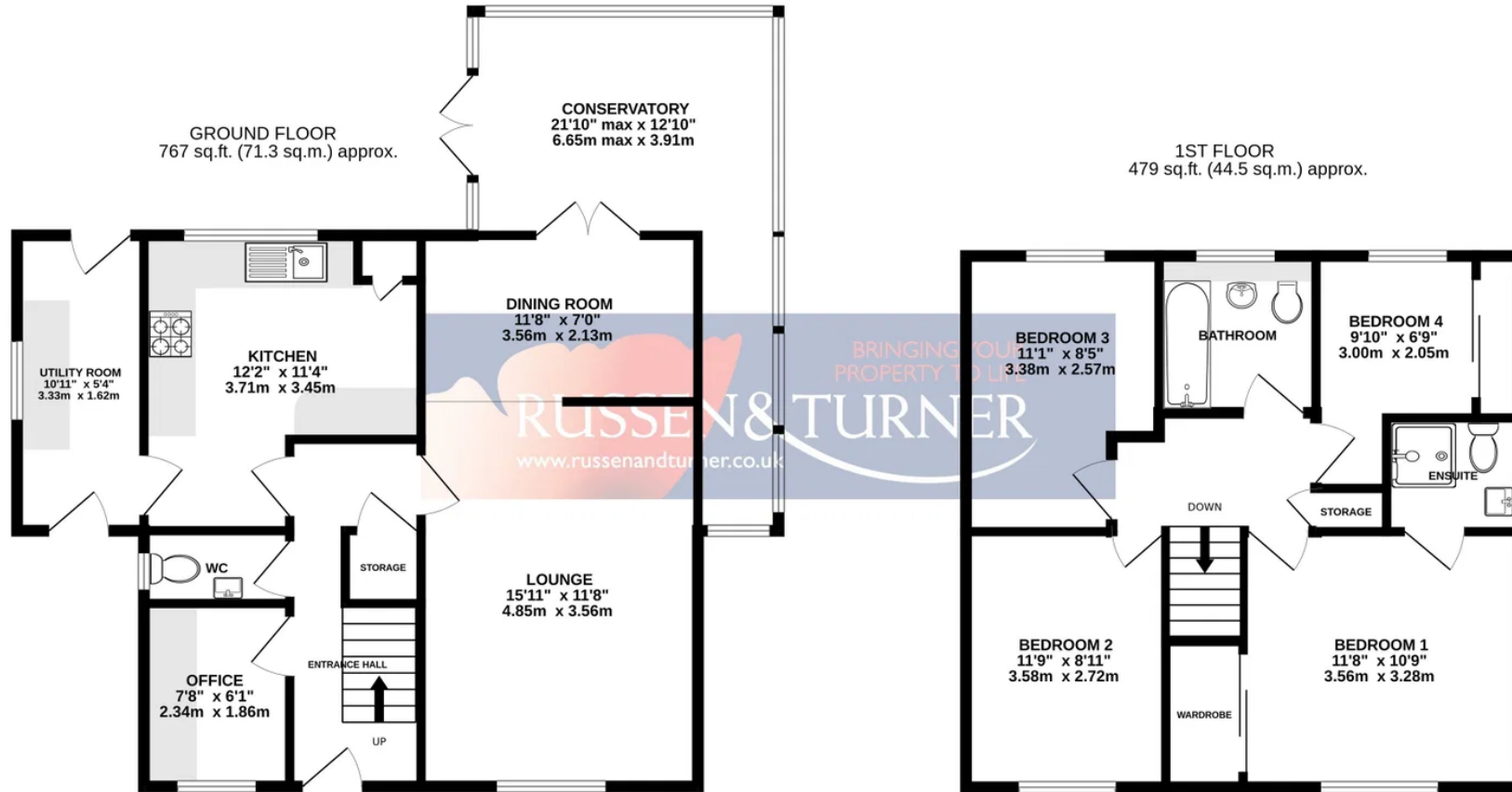

TOTAL FLOOR AREA : 1246 sq.ft. (115.8 sq.m.) approx.

Whilst every attempt has been made to ensure the accuracy of the floorplan contained here, measurements of doors, windows, rooms and any other items are approximate and no responsibility is taken for any error, omission or mis-statement. This plan is for illustrative purposes only and should be used as such by any prospective purchaser. The services, systems and appliances shown have not been tested and no guarantee as to their operability or efficiency can be given.
 Made with Metropix ©2026