



Orchard Mead House

, Finchley Road, NW11 8DJ

£550 Per Week

An extremely bright and spacious three bedroom apartment located on the 5th floor with lifts within t popular gated purpose built block, in charming Childs Hill, Finchley Road/Golders Green.

This fine property comprises of:- Welcoming entrance hallway, large reception/dining room with double door out to private balcony view of west London, two double bedrooms and one single bedroom (master having en-suite shower/WC) second bathroom/WC and separate fitted kitchen with large window overlooking Fincheley road.

The flat benefits from having wooden flooring, double glazing thru out, gas cooking and gas central heating, lift access, designated parking space for one car. Also on site caretaker.

The property is offered furnished and is available NOW for rental. Suitable for FAMILY rental and or sharers. An ideal home located for all amenities.

- Fifth Floor
- Three Bedrooms
- Small Balcony
- Private Garage
- Recently Refurbished
- Two Bathrooms
- Use of Gym

Viewing

Please contact our Messila Residential Office on 020 7586 6699 if you wish to arrange a viewing appointment for this property or require further information.



3



2



1



C

Floor Plan

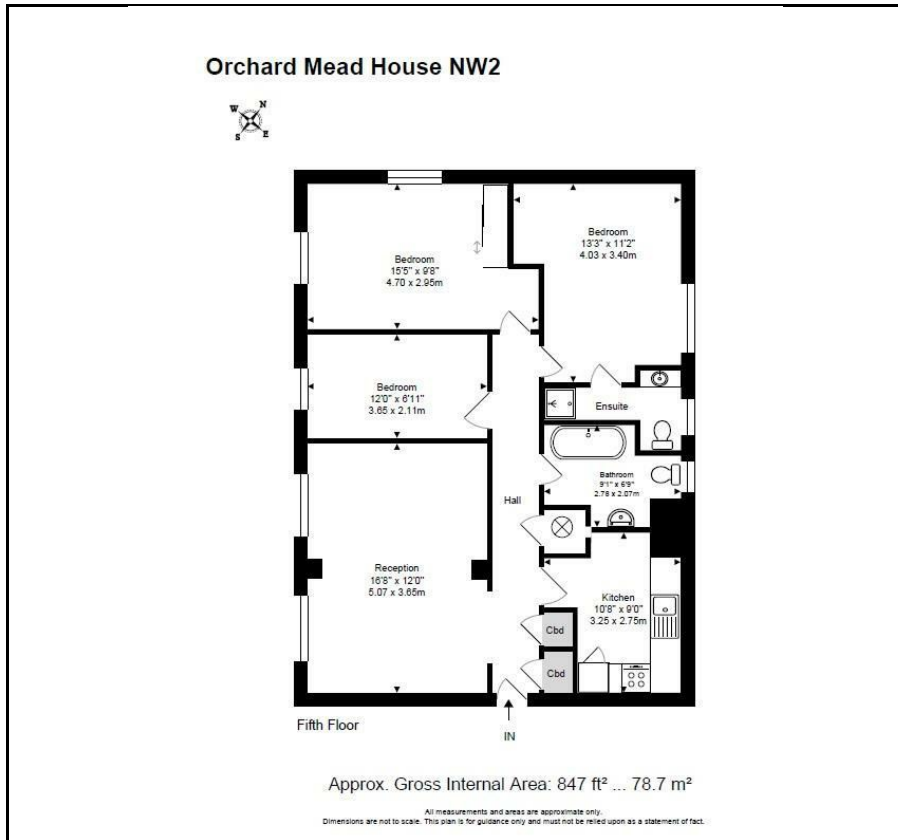

Area Map



Energy Efficiency Graph

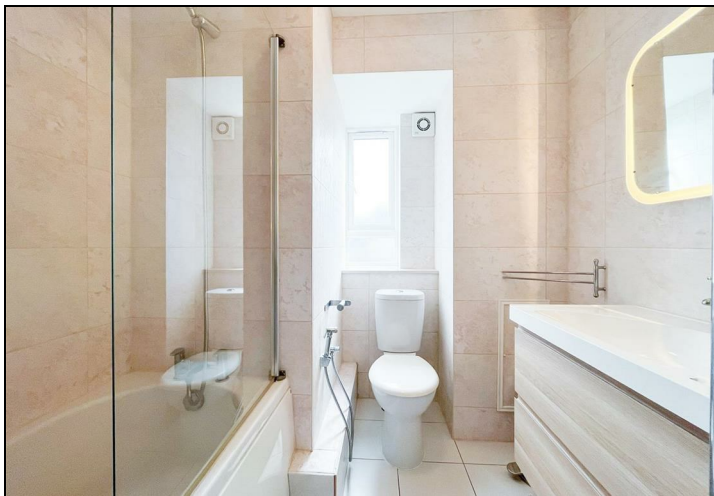
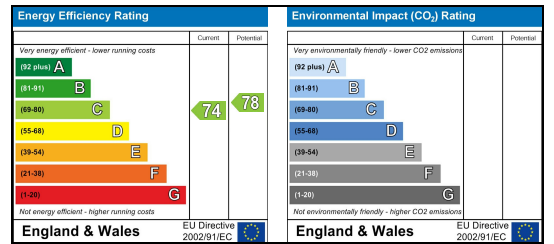

These particulars, whilst believed to be accurate are set out as a general outline only for guidance and do not constitute any part of an offer or contract. Intending purchasers should not rely on them as statements of representation of fact, but must satisfy themselves by inspection or otherwise as to their accuracy. No person in this firm's employment has the authority to make or give any representation or warranty in respect of the property.

Messila Residential

137 Park Road, London, NW8 7HT

T: 020 7586 6699 E: regentspark@messilaresidential.com W: messilaresidential.com