



## Brompton Park Crescent, SW6

£425,000

A well presented one double bedroom apartment set within a quiet, gated development, benefiting from designated parking and on-site amenities. The property boasts a bright, dual-aspect open-plan kitchen and living area, complemented by two private balconies overlooking the communal park.

Brompton Park Crescent is a charming gated community boasting allocated residents parking, beautifully maintained surrounds and a newly refurbished gym along with a swimming pool and concierge. It is ideally positioned within close proximity of Fulham Broadway and West Brompton.

### Features

- On Site Gym & Swimming Pool
- Two Private Balconies
- Designated Parking Space
- Gated Complex with Porter
- Chain Free
- Private Communal Gardens

# Brompton Park Crescent, London, SW6

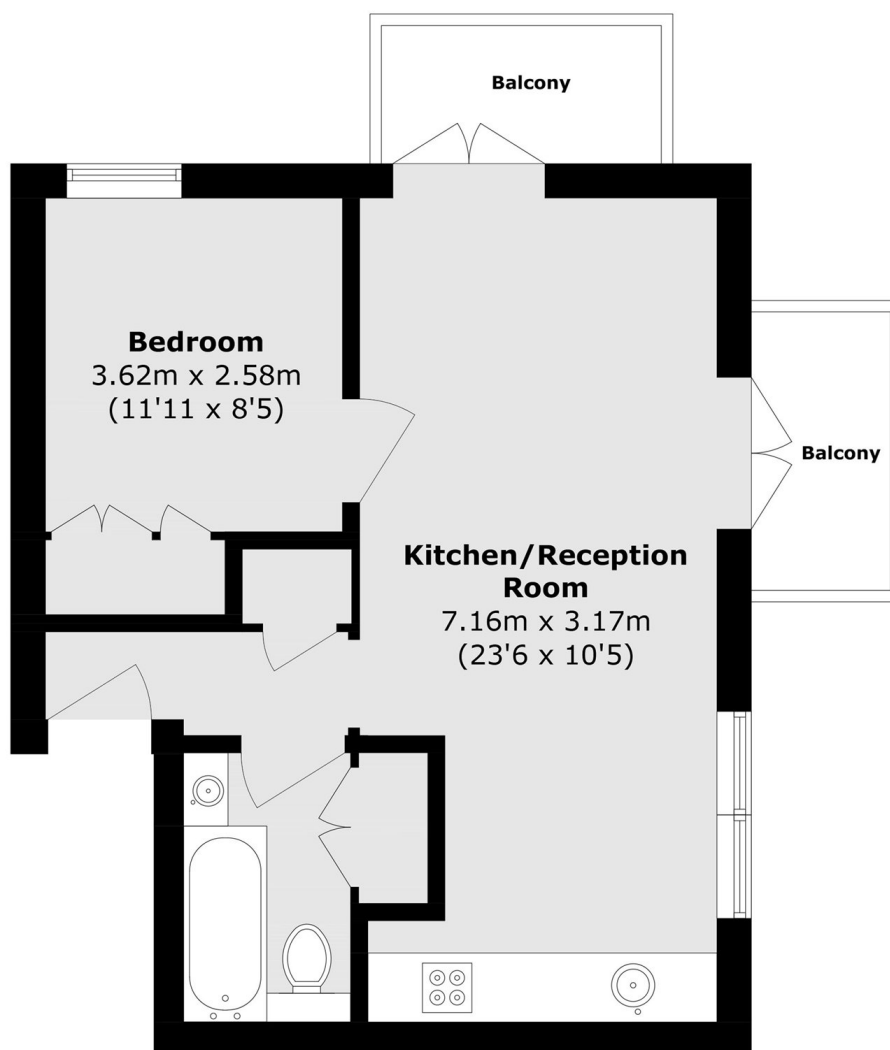

Total area (approx.): 38.5 sq. m (414.4 sq. ft)

Balcony area (approx.): 5.8 sq. m (62.4 sq. ft)