



68 The Flats, Paston Ridings, Peterborough
£750 pcm

 **NEWTON FALLOWELL**

68 The Flats

Paston Ridings, Peterborough

This GROUND FLOOR APARTMENT is AVAILABLE IMMEDIATELY and benefits from an open plan lounge diner, modern fitted kitchen, ONE DOUBLE BEDROOM and a contemporary family bathroom, offering a three-piece white suite with a shower over the bath, whilst there is also a balcony accessible from the lounge diner and outbuilding storage to the rear.

Council Tax band: A

Tenure: Leasehold

EPC Energy Efficiency Rating: C

EPC Environmental Impact Rating: C

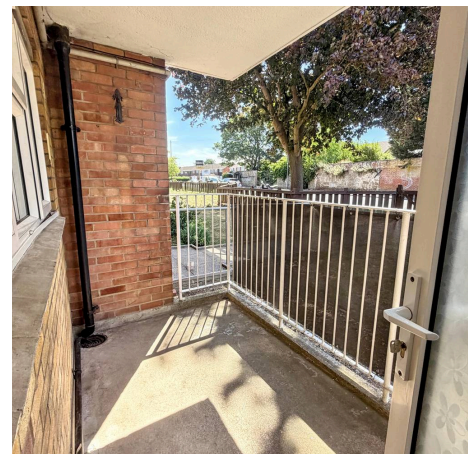



Entrance Hall

Lounge Diner

16' 0" x 11' 9" (4.88m x 3.58m)

Kitchen

9' 3" x 8' 4" (2.81m x 2.55m)

Bedroom

10' 9" x 11' 11" (3.27m x 3.62m)

Family Bathroom

6' 9" x 7' 3" (2.06m x 2.21m)

Balcony



Approx Gross Internal Area
52 sq m / 565 sq ft

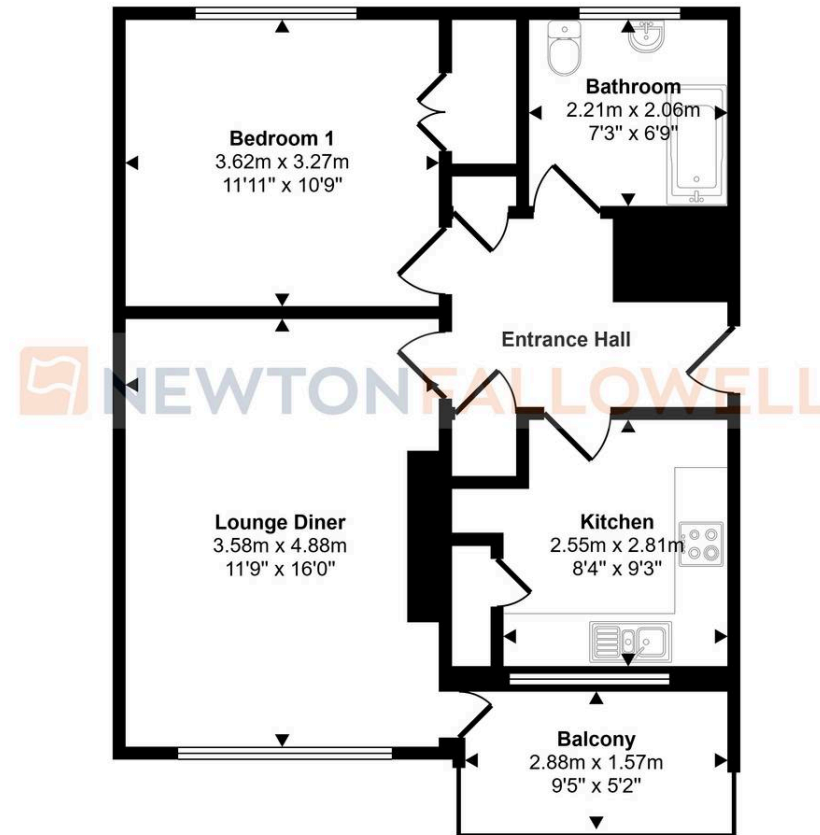

Floorplan

This floorplan is only for illustrative purposes and is not to scale. Measurements of rooms, doors, windows, and any items are approximate and no responsibility is taken for any error, omission or mis-statement. Icons of items such as bathroom suites are representations only and may not look like the real items. Made with Made Snappy 360.

Newton Fallowell - Peterborough

Newton Fallowell Estate Agents, 11 Skaters Way - PE4 6NB

01733 511225 · peterborough.lettings@newtonfallowell.co.uk · newtonfallowell.co.uk/peterborough