

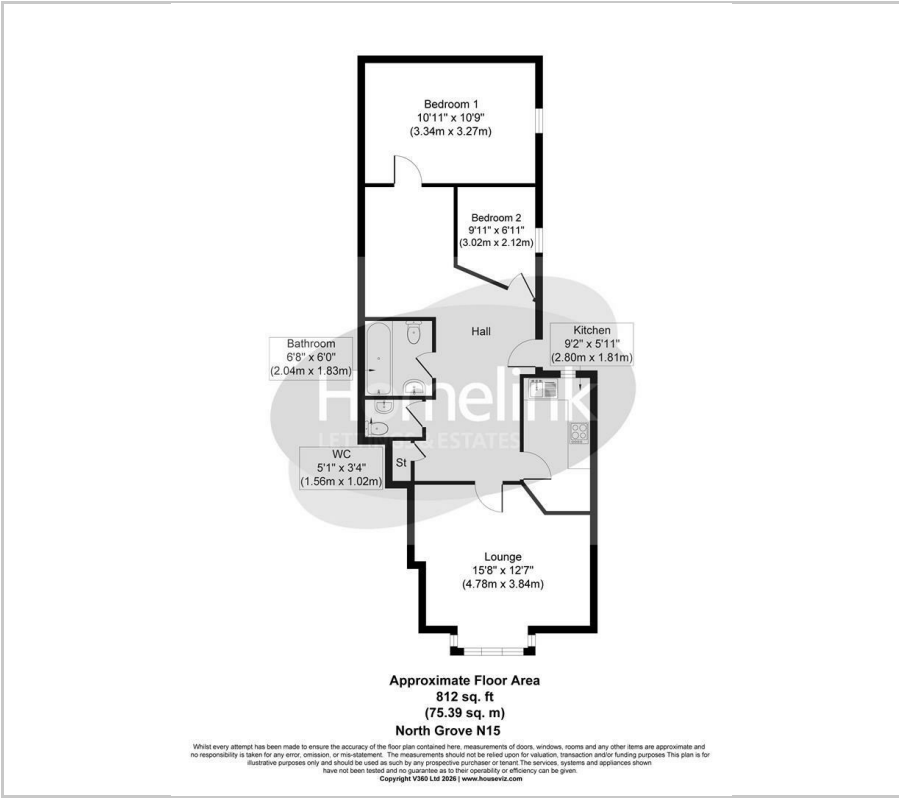

North Grove, Seven Sisters, N15

£1,800 PCM

Floor Plan



Area Map



Energy Efficiency Graph

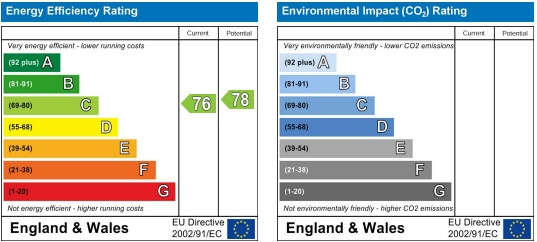

Viewing

Please contact our Homelink Lettings & Estates Office on 0208 882 2112 if you wish to arrange a viewing appointment for this property or require further information.

- Two Bedroom Flat
- Set on Ground Floor
- Double Glazing
- Ideal for Professionals
- Great Transport Links
- Newly Refurbished
- New Boiler + Gas C/H
- Close to Local Amenities
- Good Schools and Parks
- Available now

****BRAND NEW FLAT**** Homelet are delighted to offer for rent this newly refurbished ground floor two bedroom flat located close to Seven Sisters station and local amenities.

The flat has been totally refurbished throughout with new wood flooring, new boiler, new kitchen, new bathroom, toilets and new lighting. This ideal for a small family due to good local schools in the area or a couple who could work from home. The property is set behind gates giving extra security and will benefit from own section of outdoor space.

The property is a 10 minute walk from the Victoria line and Overground at Seven Sisters (Zone 3) and has quick and convenient access to central and east London. Additionally it is a short walk from the vibrant bars, cafes, and restaurants on Green Lanes. Also within a short walk are the leafy Downhills and Chestnuts Parks and several Ofsted 'Good' rated primary schools.

To arrange a viewing, call and speak to one of our friendly lettings team.

Haringey C/Tax Band 'C'
2025/26 C/Tax - £1,962.61



These particulars, whilst believed to be accurate are set out as a general outline only for guidance and do not constitute any part of an offer or contract. Intending purchasers should not rely on them as statements of representation of fact, but must satisfy themselves by inspection or otherwise as to their accuracy. No person in this firm's employment has the authority to make or give any representation or warranty in respect of the property.

Homelink Lettings and Estates
62 Chase Side, London N14 5PA
0208 882 2112 [homelink.co.uk](https://www.homelink.co.uk)

