



CROFTS ESTATE AGENTS

PASSIONATE ABOUT PROPERTY

CLEETHORPES
01472 200666

IMMINGHAM
01469 564294

LOUTH
01507 601550

SALES LETTINGS NEW HOME SALES LAND PROPERTY MANAGEMENT AUCTIONS FINANCIAL ADVICE AND MORTGAGES ENERGY PERFORMANCE PROVIDER



81 Brackenborough Road
Louth
LN11 0AD

Offers in the Region Of £365,000

CLEETHORPES: 62 St Peters Avenue, Cleethorpes, DN35 8HP

IMMINGHAM: 21 Kennedy Way, Immingham, DN40 2AB

LOUTH: 3 Market Place, Louth, LN11 9NR

Email: Cleethorpes:

Email: Immingham :

Email: Louth :

info@croftsestateagents.co.uk

immingham@croftsestateagents.co.uk

louth@croftsestateagents.co.uk

www.croftsestateagents.co.uk



Property Description

Coming to the market, early viewing is advised on this most beautiful and stunning two/three bedroom detached bungalow which has been superbly refurbished and modernised to create a beautiful home along with lovely and good sized rear garden. Situated on Brackenborough Road in the popular market town of Louth and therefore close to many local amenities, the property creates an ideal purchase for a variety of buyers. This lovely, versatile detached property benefits from uPVC double glazing, and gas central heating and comprises main hallway, with lounge, two double bedroom, shower room and the superb kitchen off. Further accommodation includes a conservatory, second hallway, utility/cloakroom and a versatile reception room which could be used as a third bedroom. Ample off road parking to the front. The property sits on a large plot with good sized enclosed rear gardens which enjoy a southerly facing aspect along with a great degree of privacy.

Entrance Hall

uPVC double glazed entry door to the front elevation with adjoining glazed panels. Neutrally decorated and having loft access. Central heating radiator.

Bedroom One

11' 5" x 11' 5" (3.48m x 3.49m)

PLeasantly decorated the first of the double bedrooms has a uPVC double glazed window to the front elevation. Central heating radiator.

Bedroom Two

8' 11" x 11' 5" (2.71m x 3.48m)

The next double bedroom is located to the rear and has a uPVC double glazed window. Central heating radiator.

Shower Room

5' 9" x 5' 2" (1.74m x 1.57m)

With two uPVC double glazed windows this modern shower room has a walk in shower, and w.c and wash basin set into a modern unit. Chrome effect central heating towel radiator. Electric shaving point. Chrome effect central heating radiator.

Lounge

11' 5" x 14' 7" (3.48m x 4.45m)

Offering ample natural light with uPVC double glazed bay window to the front elevation and a further double glazed window to the side. Two central heating radiators. Inset gas fire creating a pleasant focal point.

Kitchen / Diner

Cleethorpes 01472 200666
 Immingham 01469 564294
 Louth 01507 601550

www.facebook.com/croftsestateagents

facebook

12' 7" x 21' 3" (3.825m x 6.485m)

One of the key selling features to this superb home has to be that of this most beautiful kitchen diner. Equipped with a base and larder styled units along with dekton work top, an island and a breakfast bar. Induction hob with ground fed extractor. Integrated oven and microwave. Integrated fridge, freezer and dishwasher. Under worktop sink. A focal point of the room is created by the inset multi fuel stove set into the wall. Column radiator. The room is flooded with natural light with two uPVC double glazed windows to the front and French doors to the rear. Opening through to the conservatory.

Conservatory

9' 11" x 10' 4" (3.03m x 3.14m)

With central heating radiator, the conservatory opens from the superb dining kitchen and is uPVC double glazed with French doors out to the garden. Central heating radiator.

Utility/Cloakroom

6' 4" x 5' 2" (1.923m x 1.577m)

A superb addition is this useful space accommodating both a utility area and a cloakroom. Equipped with a w.c and sink and drainer along with plumbing for a washing machine. Central heating radiator.

Bedroom Three

14' 10" x 8' 3" (4.520m x 2.510m)

A versatile space that is currently used as a office / hobby room but makes a lovely sized third bedroom. uPVC double glazed window. Central heating radiator.

Garage

9' 1" x 9' 3" (2.779m x 2.807m)

Personal door from the property and an up and over door to the front. Internal light and power.

Outside

Set upon this good sized plot with ample frontage with lawn and block paved driveway creating off parking for several vehicles. Another selling point has to be this great sized rear garden which offers a great degree of privacy and a southerly facing aspect. Attractively presented to create an ideal garden for entertaining with a large expanse of lawn and having paved footpath and central seating area. Timber summer house with electric. Established shrubs and plants complement the garden.



Tenure

Believed to be Freehold, awaiting solicitors' formal confirmation. All interested parties are advised to make their own enquiries.

Services

All mains services are understood to be connected, however Crofts have not inspected or tested any of the services or service installations & purchasers should rely on their own survey.

Broadband and Telecom Communications

Broadband and mobile speeds and availability can be assessed via the Ofcoms checker website.

<https://www.ofcom.org.uk/phones-and-broadband/coverage-and-speeds/ofcom-checker>



Viewings

Please contact the relevant marketing office and all viewings are strictly by appointment only please.

Council Tax Information

Band C: To confirm council tax banding for this property please view the website www.voa.gov.uk/cti

Free Valuations

We offer a free valuation with no obligation, just call the relevant office or visit www.croftsestateagents.co.uk seven days a week to arrange for your free valuation.

Property Management

We offer a full property management service, offering full and comprehensive credit and referencing checks detailed photographic inventories and regular property inspections to name just a few of our services.



OPEN 7 DAYS A WEEK

Monday to Friday
Saturday
Sunday

9am to 5.30pm (Tuesday opening 9.30am)
9am to 3.00pm
11am to 2.00pm (Louth & Immingham closed)

GROUND FLOOR
115.7 sq.m. (1246 sq.ft.) approx.

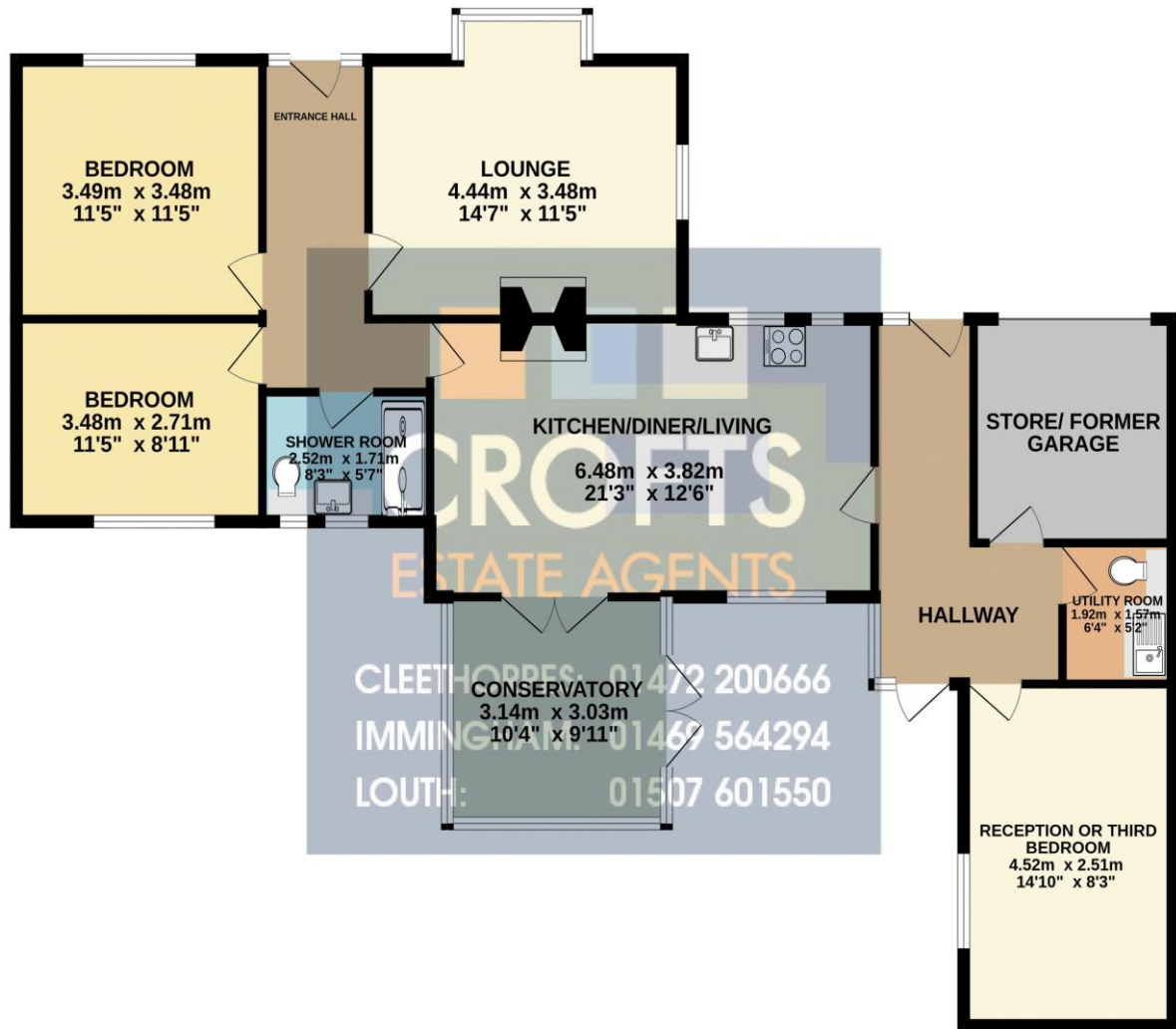

TOTAL FLOOR AREA : 115.7 sq.m. (1246 sq.ft.) approx.

Whilst every attempt has been made to ensure the accuracy of the floorplan contained here, measurements of doors, windows, rooms and any other items are approximate and no responsibility is taken for any error, omission or mis-statement. This plan is for illustrative purposes only and should be used as such by any prospective purchaser. The services, systems and appliances shown have not been tested and no guarantee as to their operability or efficiency can be given.
Made with Metropix ©2026