

Wyke Road Raynes Park, SW20 8RP

£1,500 PCM



Well presented one bedroom purpose build flat with lift to the building. Centrally located just a few minutes walk from Raynes Park station and High Street features a range of gyms, coffee shops, Waitrose and independent restaurants. Features a spacious reception and bedroom, modern kitchen with dishwasher, and contemporary bathroom, and double glazing. The building has a communal boiler with **HOT WATER AND HEATING COSTS INCLUDED IN THE RENT.**

Council tax band B. EPC band C.

Langham Court

Approximate Gross Internal Area = 45.4 sq m / 489 sq ft

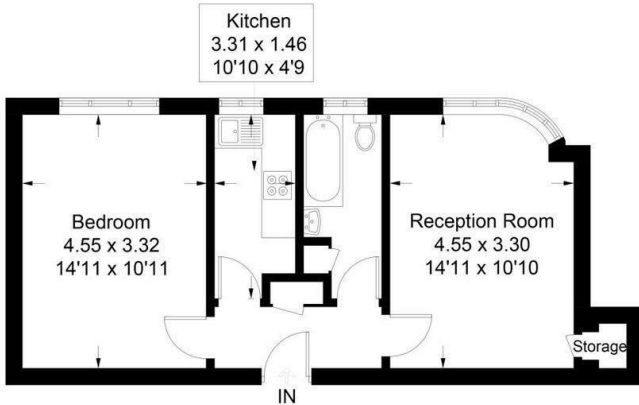
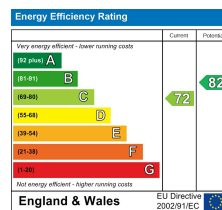

Illustration for identification purposes only, measurements are approximate, not to scale. floorplans.uk/sketch.com © (ID457510)



- Spacious one bedroom flat
- Modern kitchen with dishwasher
- Lift to the building
- Close to Raynes Park station
- Hot water and heating included in the rent
- First months rent in advance
- Five weeks security deposit
- Holding deposit = one weeks rent
- EPC band C
- Council tax band B



Although these particulars are believed to be correct, their accuracy is not guaranteed and they do not form part of any contract.

Celebrating 30 years of successful Sales and Lettings in Merton

