



Semi-Detached Bungalow

52 Parkhouse Road, Ardrossan, KA22 8AN



taylorandhenderson.co.uk

2		2		1		F	EPC rating
---	--	---	--	---	--	---	----------------------

52 Parkhouse Road

Taylor and Henderson are delighted to bring to the market this semi detached bungalow which is situated within easy access of all amenities including shops, bus routes and train station. The accommodation which is in need of modernisation comprises entrance vestibule, hallway, lounge with bay window, 2 double bedrooms, bathroom, dining kitchen and door to the rear porch with access to the rear garden on one level. The garden ground to the front of the house has a paved driveway providing off street parking leading up the side of the property to the detached garage in the rear garden, decorative chipped area bounded by hedgerow. The enclosed rear garden has a section of mature shrubs plants and chipped area with a paved patio area to the rear. Ardrossan and nearby Saltcoats offer a range of local amenities including beach, local shops, supermarket, restaurants, schools, train station and bus services. There is a regular ferry service to the Isle of Arran from Ardrossan Marina and a summer ferry service also provides regular sailings to the Kintyre peninsula. This excellent property is conveniently situated for all local amenities including road and regular rail links to Glasgow and all West Coast towns and thus is well located for travel throughout West Central Scotland.

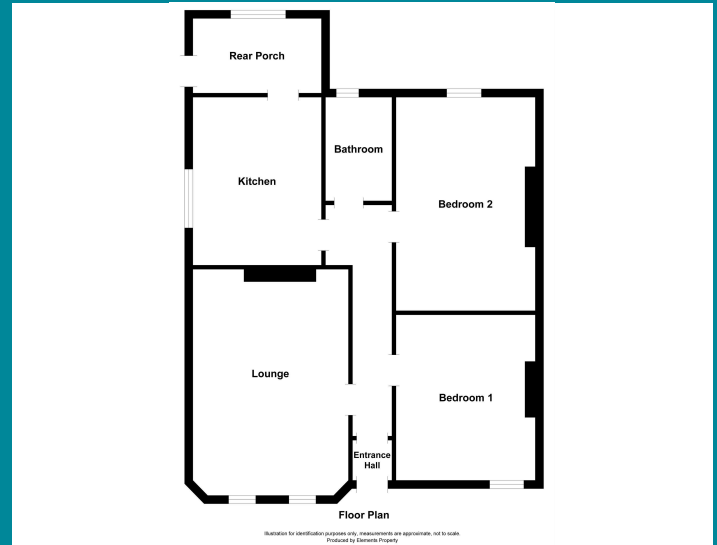
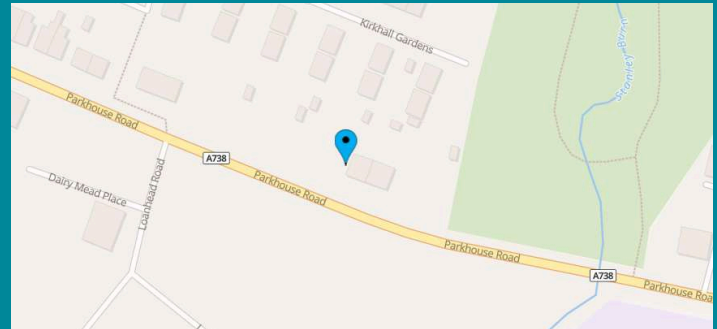

Entrance Vestibule	3'0 x 3'1
Hall / Landing	1'40 x 5'0
Lounge	16'0 x 11'1
Bedroom 1	12'0 x 10'0
Bedroom 2	14'0 x 10'0
Bathroom	8'0 x 5'0
Kitchen	12'0 x 10'0

Viewing
Through solicitors on 01294 606700

Email
property@taylorandhenderson.co.uk

Reference E507142



DISCLAIMER: Whilst we endeavour to make these particulars as accurate as possible, they do not form part of any contract of offer, nor are they guaranteed. Measurements are approximate and in most cases are taken with a digital/sonic-measuring device and are taken to the widest point. We have not tested the electricity, gas or water services or any appliances. Photographs are reproduced for general information and it must not be inferred that any item is included for sale with the property. If there is any part of this that you find misleading or simply wish clarification on any point, please contact our office immediately when we will endeavour to assist you in any way possible.