



Edinburgh Drive, Bedlington, NE22 6NY

Offers Over £265,000

**Harpers** | POWERED BY **exp**™ UK  
property people

**Bedrooms: 3 | Bathrooms: 2 | Receptions: 2**

Set in a sought-after residential location, this beautifully presented detached family home offers spacious, flexible living across three levels, making it ideal for growing families. The property features three generous double bedrooms plus a versatile loft room, which could easily serve as a guest room if required. A modern family bathroom & en-suite shower room provide stylish and practical convenience. The living spaces are equally impressive, with a spacious lounge/diner complete with feature log burner and an extended sun-room with direct access to the garden: perfect for relaxing or entertaining. A modern, well-appointed kitchen completes the ground floor. Externally, the home boasts a good-sized South-facing garden with patios, ideal for enjoying the sunshine, along with internal access to a single garage. With its excellent presentation, generous layout & highly desirable location, this is a property that delivers on comfort, character & lifestyle.

- Detached Family Home
- Three Double Bedrooms
- Loft Room (could be used as 4th bedroom if required)
- Modern Family Bathroom & En-Suite Shower Room
- Spacious Lounge/Diner With Feature Log Burner
- Extended Sun Room With Direct Garden Access
- Modern Well-Appointed Kitchen
- Internal Access To Single Garage
- Good-Sized South Facing Garden & Patios
- Sought After Residential Location





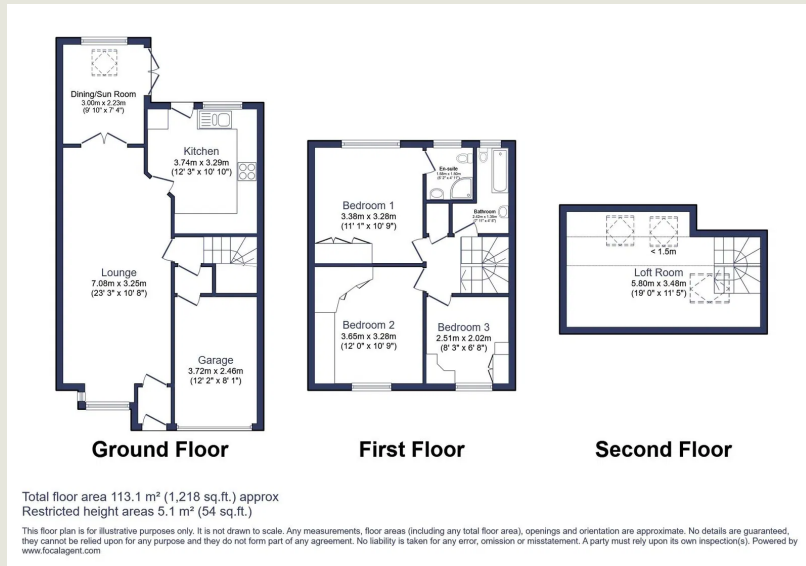

## Harpers Property People

19 Hartford Road East Bedlington Northumberland NE22 6HZ

07813 673 606

ali@harpersproperty.com

<https://harpersproperty.com>

