

FREEHOLD



Apartment - First Floor (EPC Rating: B)

**APARTMENT 21, ELM HOUSE ARLESEY ROAD,
STOTFOLD, HITCHIN, HERTS, SG5 4HA**

Offers Over

£300,000



First Step



2 Bedroom Apartment - First Floor located in Hitchin

CHAIN FREE... Entertaining Kitchen with ISLAND... Integrated BOSCH appliances... SHARE OF THE FREEHOLD 999 year lease... TWO allocated parking spaces & EV CHARGER... COLOUR CHOICE of Kitchen and flooring still available... Underfloor heating with AIR SOURCE HEAT PUMPS... Luxury open plan living...

First Floor - Apartment 21

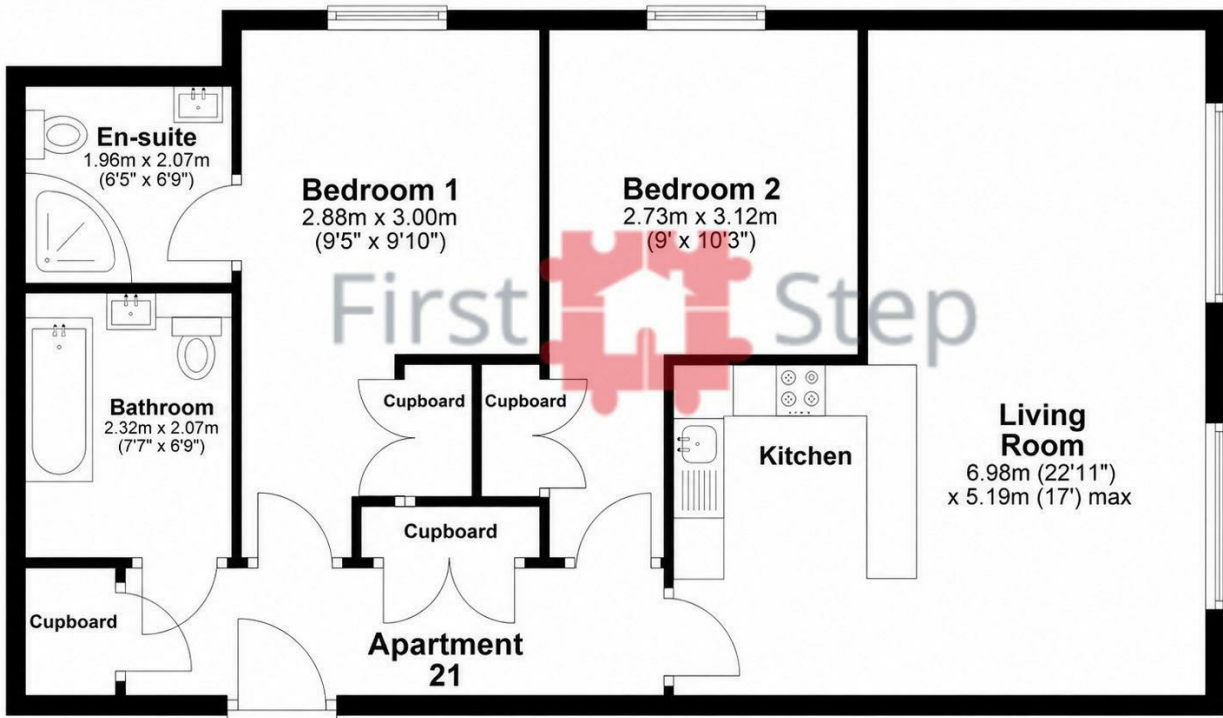

Council Tax Band

B

Energy Performance Graph

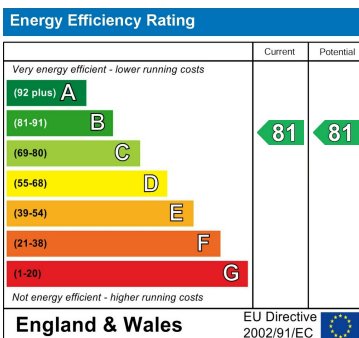

Call us on

01462 659 730

sales@firststep.ltd

www.firststep.ltd

Agents Note: Whilst every care has been taken to prepare these particulars, they are for guidance purposes only. All measurements are approximate and are for general guidance purposes only and whilst every care has been taken to ensure their accuracy, they should not be relied upon and potential buyers are advised to recheck the measurements.



First Step