

RENT ME



WILLOW CLOSE, BRANDON

£1,215 PCM



2



1



1



C

# 2 Bedroom House located in Brandon

**\*\*AVAILABLE NOW\*\*** Two bedroom semi-detached house, in the village of Brandon. Set in a cul-de-sac location, this property is close to local amenities. The property offers living room, kitchen, two bedrooms and bathroom. With rear enclosed garden and off-road parking.

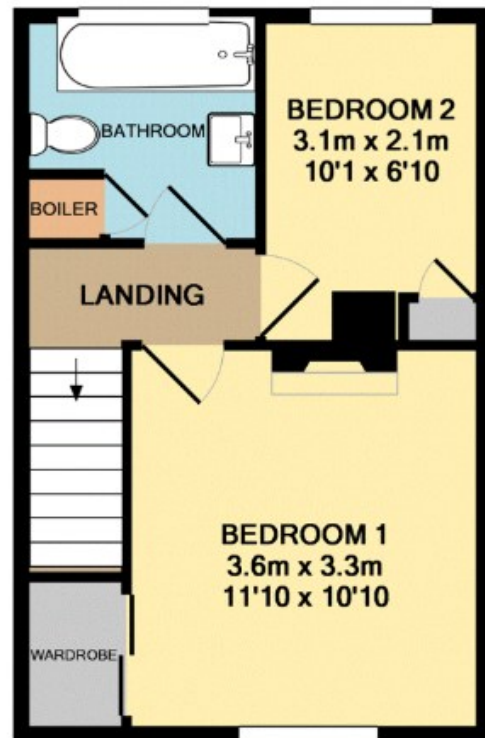
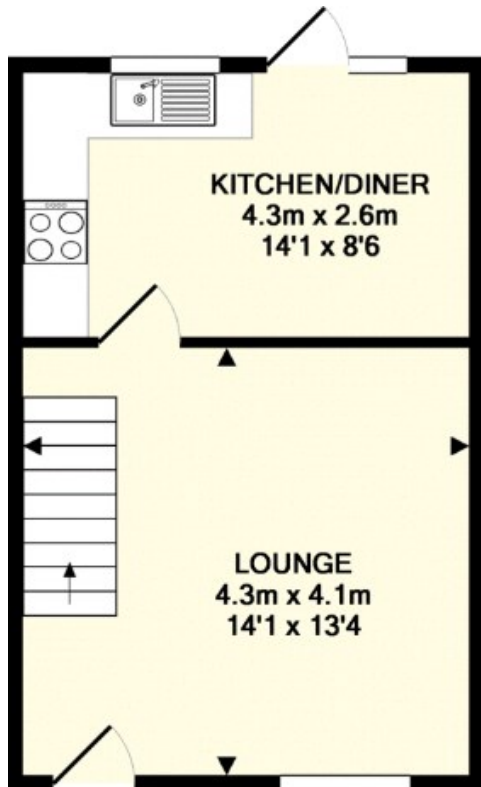

Council Tax Band

A

Energy Performance Graph

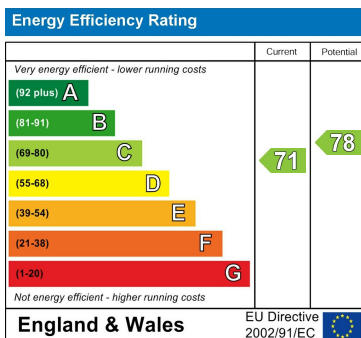

Call us on

01638 551551

[enquiries@lodge-lettings.co.uk](mailto:enquiries@lodge-lettings.co.uk)

[www.lodge-lettings.co.uk](http://www.lodge-lettings.co.uk)

Agents Note: Whilst every care has been taken to prepare these particulars, they are for guidance purposes only. All measurements are approximate and are for general guidance purposes only and whilst every care has been taken to ensure their accuracy, they should not be relied upon and potential buyers are advised to recheck the measurements.