

33 St. Peters Drive, Askern , Doncaster, DN6 0BL

Guide Price £160,000 - £170,000!! This stunning two-bedroom semi-detached property offers a fantastic opportunity for first-time buyers and those seeking a stylish, turn-key home in a convenient location. Finished to a high standard throughout and carefully maintained, this property blends modern comfort with practical living.

Upon entering, you are welcomed into a light and inviting lounge, perfect for relaxing or entertaining. To the rear, the contemporary fitted kitchen is the heart of the home, complete with a dedicated breakfast area, and a useful cloakroom. A ground floor W/C adds further convenience.

Upstairs, there are two spacious double bedrooms, with the second benefitting from built-in storage. The home is finished throughout with sleek solid oak white internal doors, enhancing the modern aesthetic.

The property further benefits from double glazing, gas central heating, Council Tax Band A, and an impressive EPC Rating B, making it both energy-efficient and cost-effective.

Externally, the property continues to impress with beautifully landscaped front and rear gardens, providing the perfect space for outdoor enjoyment. A tarmac driveway to the front offers off-road parking for approximately two vehicles.

Situated in a sought-after area, the property enjoys excellent transport links and is within easy reach of local shops, schools, and amenities — offering convenience right on your doorstep.

Guide price £160,000

33 St. Peters Drive, Askern

, Doncaster, DN6 0BL



- Attractive modern semi-detached property
- Ground floor W/C
- Spacious lounge ideal for modern living
- EPC Rating B | Council Tax Band A
- Two double bedrooms with storage in bedroom two
- Beautifully maintained front & rear gardens
- Ideal first-time buyer home
- Stylish fitted kitchen with breakfast area & cloakroom
- Tarmac driveway with parking for two cars
- Excellent transport links & close to local amenities

Lounge

12'3" x 14'0" (3.75 x 4.27)

Kitchen/Diner

12'4" x 8'0" (3.78 x 2.44)

W/C

Master bedroom

12'2" x 10'3" (3.71 x 3.13)

Bedroom 2

12'3" x 7'7" (3.75 x 2.32)

Bathroom

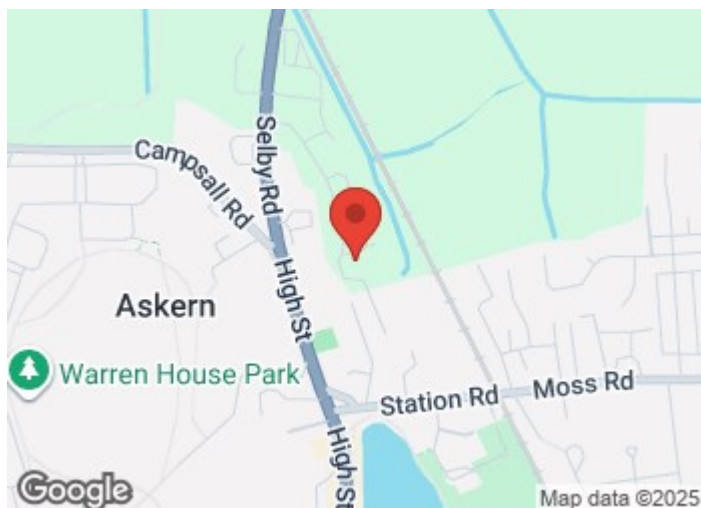

Directions

The village lies 9 miles (14 km) south of Pontefract, and 7 miles (11 km) north of Doncaster. The village offers an array of local amenities, schools, doctors and supermarket. The focal point is Askern lake, offering a lovely walk and cafe stop.



Floor Plan

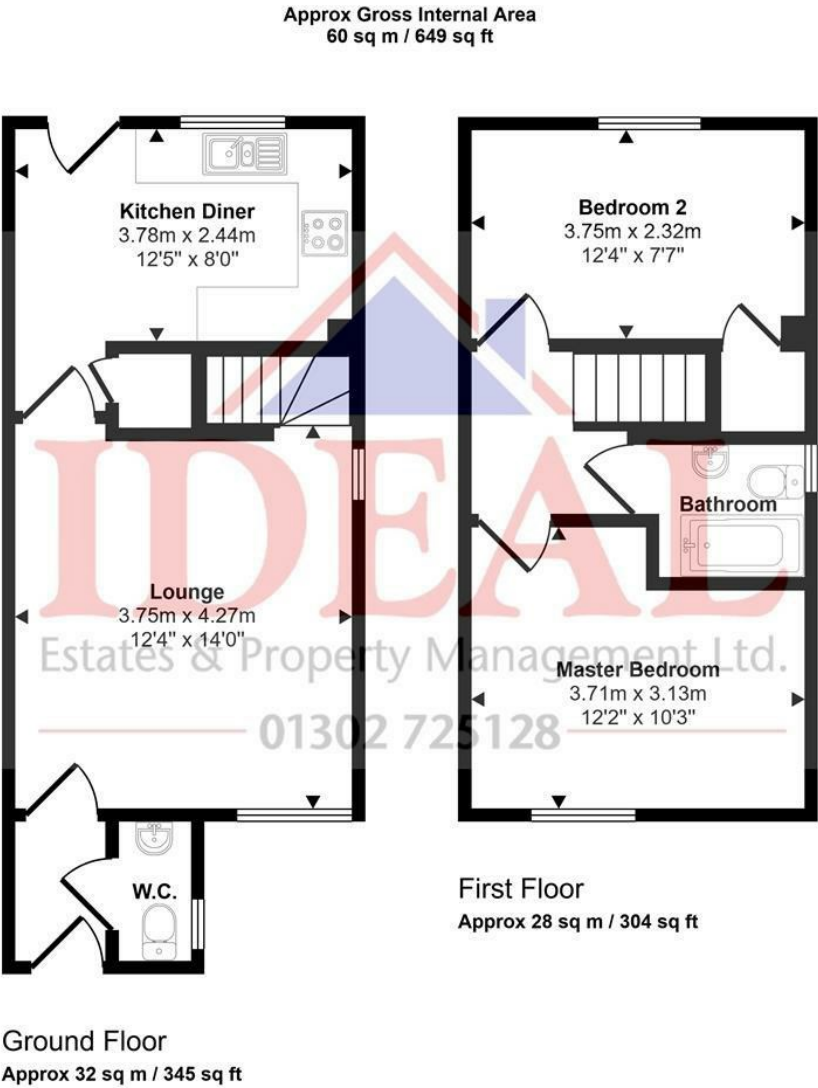

This floorplan is only for illustrative purposes and is not to scale. Measurements of rooms, doors, windows, and any items are approximate and no responsibility is taken for any error, omission or mis-statement. Icons of items such as bathroom suites are representations only and may not look like the real items. Made with Made Snappy 360.

These particulars, whilst believed to be accurate are set out as a general outline only for guidance and do not constitute any part of an offer or contract. Intending purchasers should not rely on them as statements of representation of fact, but must satisfy themselves by inspection or otherwise as to their accuracy. No person in this firms employment has the authority to make or give any representation or warranty in respect of the property.

