



7 Maple Furlong, Benson, Oxon, OX10 6FP

£1,450 PCM - 12th June 2026

- Newly Constructed Two Bedroom House
- Benson Village
- Two Double Bedrooms
- Ensuite to Bedroom One
- EPC Rating B

7 Maple Furlong, Oxon OX10 6FP

Presented to a high specification, two bedroom house located on popular Cala Homes development within walking distance of Benson village centre. Comprising of fully fitted kitchen with gas hob, oven, washing machine, dishwasher, fridge/freezer, sitting room with doors leading to a spacious garden, downstairs cloakroom, two double bedrooms, ensuite to bedroom one, family bathroom. Gas central heating. Two allocated parking spaces. Good size garden. EPC Rating B. Council Tax Band C



Council Tax Band: C



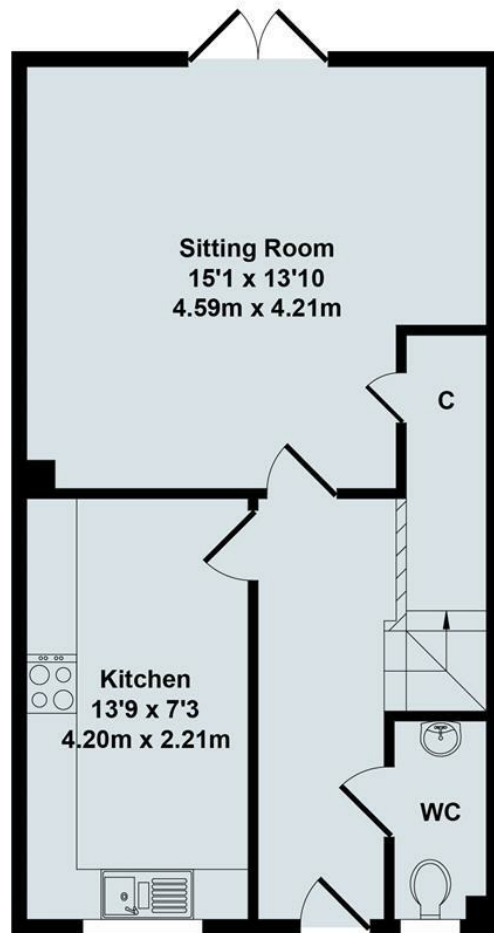

Ground Floor

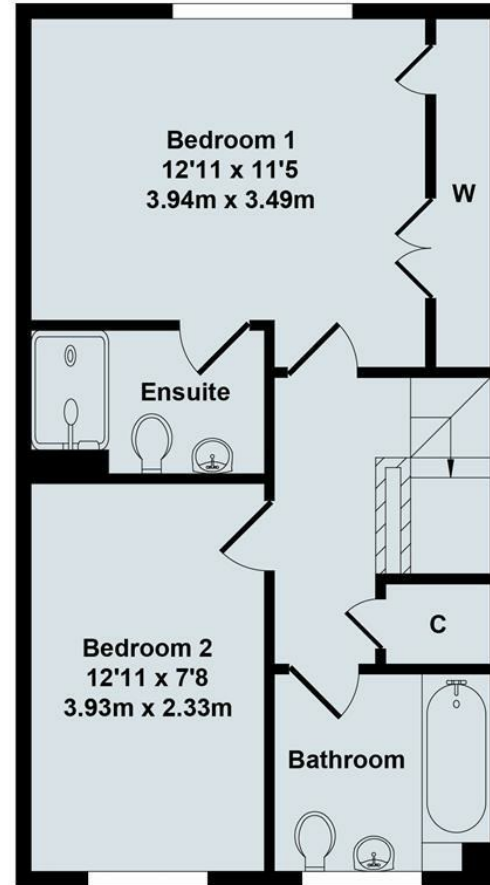

First Floor

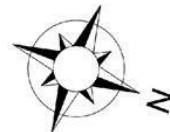

Total Approx. Floor Area 841 Sq.Ft. (78.10 Sq.M.)

All items illustrated on this plan are included in the "Total Approx Floor Area"

Energy Efficiency Rating

	Current	Potential
Very energy efficient - lower running costs		
(92 plus) A		96
(81-91) B	84	
(69-80) C		
(55-68) D		
(39-54) E		
(21-38) F		
(1-20) G		
Not energy efficient - higher running costs		
England & Wales	EU Directive 2002/91/EC	

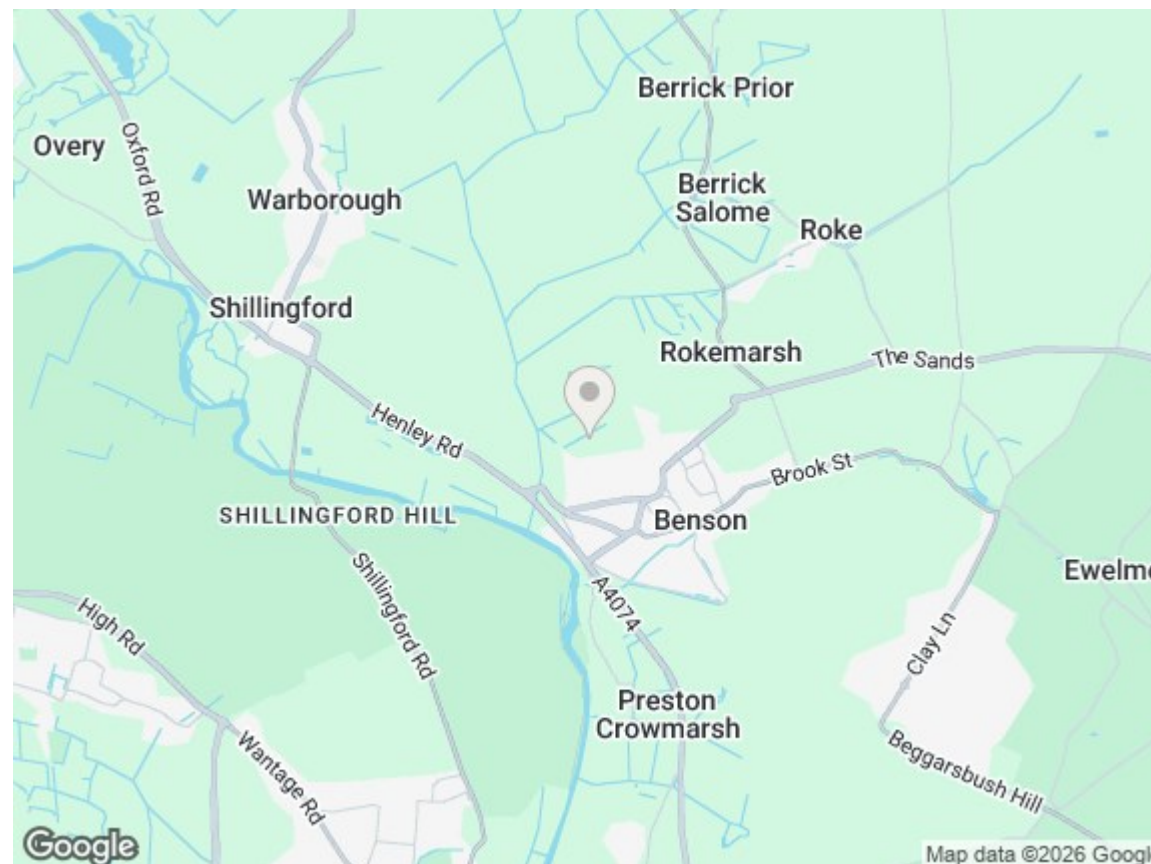

Directions

Viewings

Viewings by arrangement only. Call 01235 514267 to make an appointment.

Council Tax Band

C