



Frampton Road, TW4

£1,448 Per calendar month

A well presented one bedroom house offering over 680 sq ft of accommodation, with a spacious open plan living area and private parking available. Ideal for a professional single or couple.

Frampton Road is ideally located in Hounslow, offering excellent transport links including nearby rail connections and easy access to Heathrow Airport. The area provides a range of local amenities, green spaces, and convenient routes into central London.

Features

- One Bedroom House
- Open-Plan Living
- Good Condition
- Over 680 Sq.Ft
- Private Parking
- Close To Heathrow

Frampton Road,
Hounslow, TW4

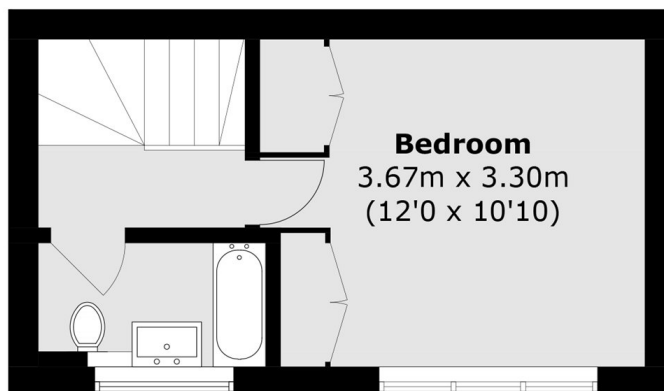

First Floor

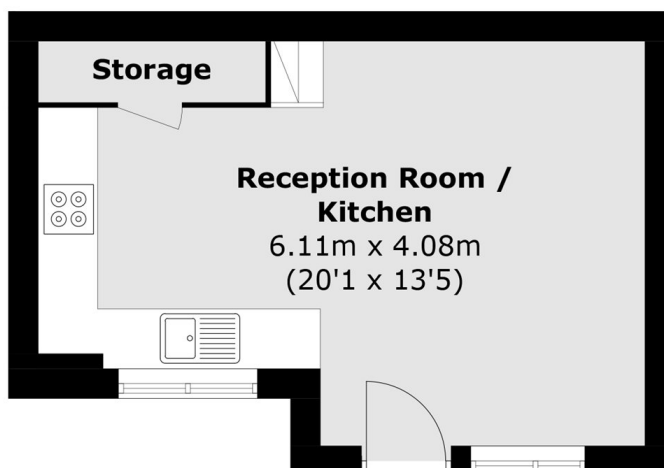

Ground Floor

Total area (approx.): 43.0 sq. m (462.8 sq. ft)