

Hampton Road, Redland BS6 6JB

Asking Price £290,000

- One Bedroom Top Floor Flat
- Well Presented Throughout
- Modern Fitted Kitchen
- Open Plan Living / Dining Room
- Double Bedroom with Built-In Storage
- Family Bathroom
- Separate Utility / Storage Cupboard
- Short Walk to Shops and Restaurants on Whiteladies Road

SUMMARY

This charming and beautifully presented top-floor flat offers stylish open-plan living and is ideally located just a short walk from Whiteladies Road. Accessed via a spacious communal hallway with stairs leading to the top floor, the apartment opens into a welcoming entrance hall with ample space for coats and shoes. The hallway leads through to a bright and airy open-plan living and dining area, featuring a large window and a decorative fireplace. A wide window hatch connects the reception room to the kitchen, enhancing the space. The fitted kitchen includes base units with wooden worktops, an integrated oven and four-ring hob, and space for a freestanding fridge and freezer. The generous double bedroom benefits from built-in wardrobes and a large storage cupboard housing the boiler, and space for a washing machine. Completing the accommodation is a family bathroom, comprising a bath with mains-fed shower, WC, sink and built-in storage. This property



Hampton Road, Redland, Bristol BS6 6JB

Approx. Gross Internal Area
612.2 Sq.Ft - 56.9 Sq.M

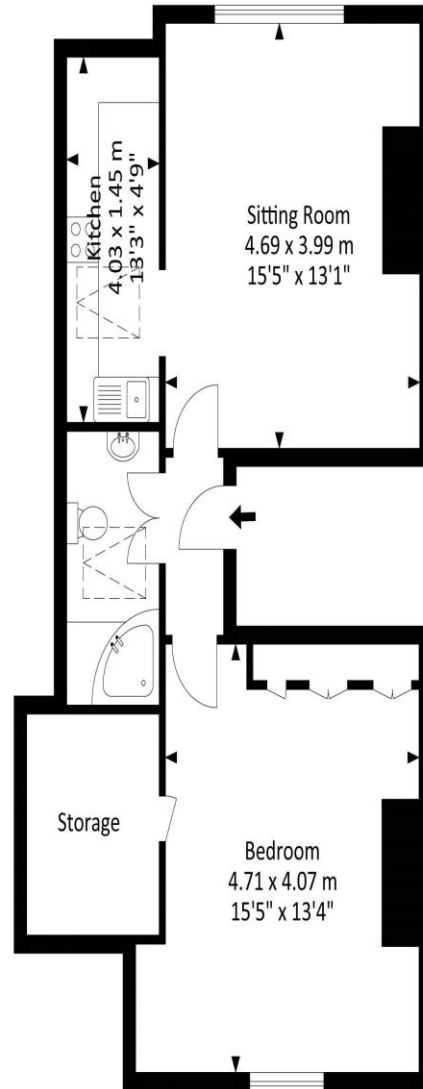

For illustrative purposes only. Not to scale.

Whilst every attempt has been made to ensure accuracy of the floor plan all measurements are approximate and no responsibility is taken for any error, omission or measurement.



Tenure
Leasehold

EPC Rating
D

Council Tax Band
A

Services

Clifton : 01179 744 766
Long Ashton : 01275 393 956
Southville : 01174 523 700

