

40 Castle Street - £210,000

Thetford Norfolk IP24 2DP

**chilterns**

Estate & Letting Agents



*"Consistently providing outstanding service to our clients"*

# £210,000

## The Property

Castle Street in Thetford, this delightful Edwardian mid-terrace house offers a perfect blend of character and modern living. With its prime location just a stone's throw from the town centre, residents will enjoy easy access to local amenities, shops, and transport links.

Upon entering, you will be greeted by a well-presented reception room that exudes warmth and charm, making it an ideal space for relaxation or entertaining guests. The spacious kitchen is a standout feature, providing ample room for family dinners or hosting gatherings, ensuring that every culinary experience is enjoyable.

The property boasts two generously sized bedrooms, including a modern downstairs bathroom.

One of the highlights of this property is the large garden space, which is designed for low maintenance, allowing you to enjoy the outdoors without the hassle of extensive upkeep. This outdoor area is perfect for summer barbecues, gardening, or simply unwinding.

In summary, this Edwardian mid-terrace house on Castle Street is a wonderful opportunity for those seeking a characterful home with a modern twist. With its spacious interiors, convenient location, and low-maintenance garden, it is sure to appeal to families and professionals alike. Do not miss the chance to make this charming property your new home.

## AGENTS NOTE

Property images may have been digitally enhanced, edited, or virtually staged using artificial intelligence and may not accurately reflect the property's current presentation, condition, furnishings, or contents. Floorplans and measurements are provided for guidance only and should not be relied upon.

## Features

- CLOSE TO TOWN CENTRE
- VERY WELL PRESENTED THROUGHOUT
- IDEAL FIRST TIME PURCHASE
- CASTLE PARK AND MELFORD COMMON ON YOUR DOORSTEP
- TWO GENEROUS SIZE BEDROOMS
- CHARACTER PROPERTY
- SPACIOUS KITCHEN
- WELL KEPT - LOW MAINTENANCE GARDEN
- EASY ACCESS TO TRANSPORT
- VIEWINGS HIGHLY ADVISED!





These sales particulars have been produced as a general guide only and we would draw to your attention that we have not carried out a detailed Survey of the property nor have we tested services, appliances or specific fittings. Whilst measurements and statements given within the details are provided in good faith, their accuracy should not be relied upon. If there are any points about which you may be uncertain or would like further clarification, we would suggest that you telephone this office and speak to our staff who will endeavour to assist you.

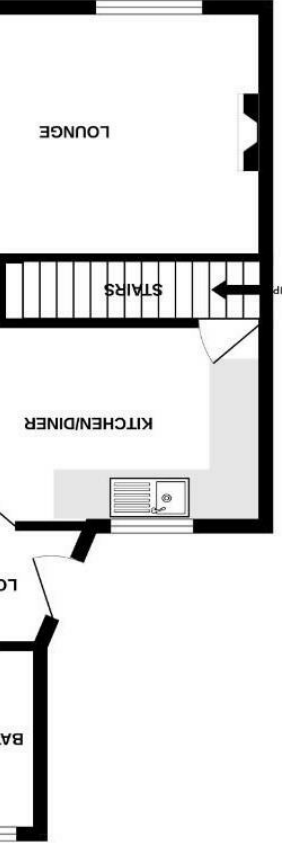

GROUND FLOOR (361 sq.ft.) approx.

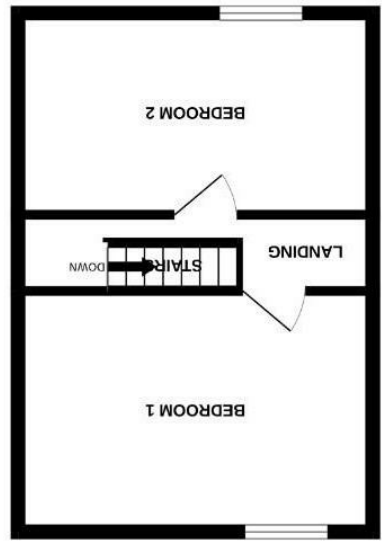

1ST FLOOR (295 sq.ft.) approx.

What every attempt has been made to ensure the accuracy of the floorplan contained here, measurements of doors, windows, doors and any other items are approximate and no responsibility is taken for any omission or mis-statement. This plan is for illustrative purposes only and should be used as a guide only. prospective purchaser. The services, systems and appliances shown have not been tested and no guarantee is given as to their operability or efficiency can be given.

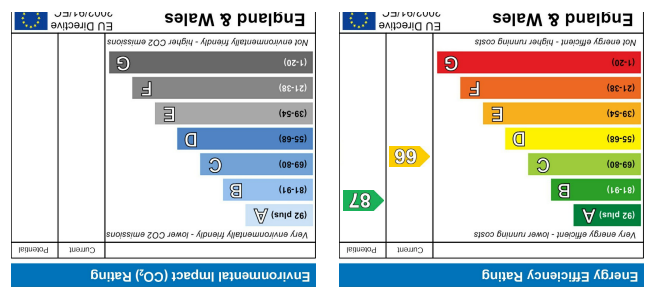

14 Bridge Street, Thetford, Norfolk, IP24 3AA  
 T: 01842 754161  
 E: thetford@chilternsstateagents.co.uk