



**OVER 60?**

Secure this property  
for up to **59% less!**

**Price**

**£325,000**

**Freehold**

3x  1x  1x 

**Cricketers Close,  
Harrietsham, Maidstone,  
Kent, ME17**

*Wards*  
Helping you move forwards





## Main features

- Driveway providing off road parking as well as garage too
- Open plan layout to downstairs, ideal for entertaining guests
- Manageable rear garden providing sunny aspect
- Walking distance to Harrietsham Train Station and local primary school
- Great commuter location with M20 within easy reach

## Accommodation

### GROUND FLOOR

Porch

Lounge: 14'6 x 10'4 (4.42m x 3.15m)

Dining Area: 9'2 x 7'9 (2.80m x 2.36m)

Kitchen: 9'3 x 7'6 (2.82m x 2.29m)

### FIRST FLOOR

Landing

Bedroom 1: 11'5 x 10'0 (3.48m x 3.05m)

Bedroom 2: 10'0 x 8'7 (3.05m x 2.62m)

Bedroom 3: 8'6 x 8'2 (2.59m x 2.49m)

Bathroom: (L-shaped) 7'0 x 5'7 (2.14m x 1.70m) plus 3'9 x 0'11 (1.14m x 0.28m)

### OUTSIDE

Garage

Driveway

Rear Garden

### Ground Floor

Approx. 46.5 sq. metres (500.5 sq. feet)

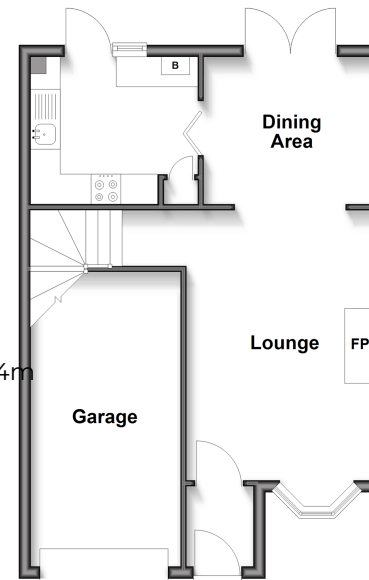

### First Floor

Approx. 41.0 sq. metres (441.2 sq. feet)

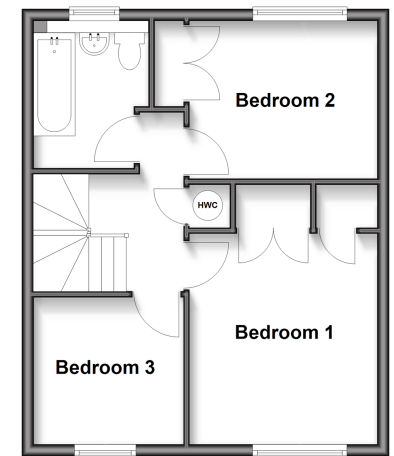

**Call Bearsted - 01622 730955 ■ [wardsofkent.co.uk](http://wardsofkent.co.uk)**

■ Legal advice should be taken to verify fixtures/fittings, planning, alterations and/or lease details  
 ■ Through a Homewise Home For Life Plan people aged 60+ can secure this property for up to 59% less, by purchasing a Lifetime Lease.

■ Appliances & services are untested, dimensions are approximate and floor plans are not to scale



12323349/20250701/DF/DF