



Homenash House St Georges Lane North, Worcester

Offers in the region of £60,000



Key Features

- One bedroom flat
- Retirement Property for 60+years only
- Communal garden, Communal Parking
- Within walking distance to City Centre
- Residents' lounge with a conservatory
- EPC rating C, Leasehold
- 24/7 emergency call system
- Service Charge approximately £2799
- Ground Rent £438 per year
- Communal Laundry facilities





One-bedroom second-floor retirement apartment

Situated within the sought-after Homenash House development, this property forms part of a purpose-built retirement complex constructed by McCarthy & Stone, comprising 66 apartments arranged over four floors and serviced by a lift.

Designed with comfort and peace of mind in mind, the development benefits from an on-site Development Manager, as well as a 24-hour Appello emergency call system for periods when the manager is off duty. Emergency assistance can be accessed from various points within the apartment.

The accommodation includes a welcoming entrance hall with useful storage and airing cupboard, leading through to a bright living room with a window, feature lighting, and access to the kitchen. The kitchen is fitted with a range of wall and base units, work surfaces, and space for essential appliances.

The bedroom is a good-sized double, featuring a built-in wardrobe and ample natural light. Bathroom has a low-level WC, vanity wash hand basin, low level

bath with recently placed shower over the bath, and tiled walls.

Ground Floor has the Communal Entrance Hall with Stairs/lift to the first floor where the property is located. A Communal Conservatory with beautiful garden views.

Residents must be aged 60 or over, or in the case of a couple, one resident must be over 60 and the other over 55.



Homenash House, St. Georges Lane North, Worcester, WR1

Approximate Area = 423 sq ft / 39.3 sq m
For identification only - Not to scale

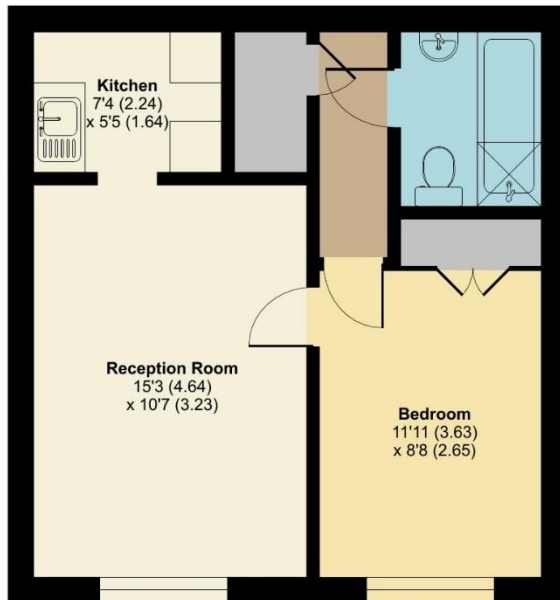

FIRST FLOOR



Floor plan produced in accordance with RICS Property Measurement 2nd Edition, incorporating International Property Measurement Standards (IPMS2 Residential). © nchecom 2026. Produced for Northwood. REF: 1441458