



698 Huddersfield Road, Lees, Oldham, OL4 3PZ

£215,000

🛏 2 🚿 2 🛋 1



- Semi-Detached Property
- Two Double Bedrooms
- Four Storey
- In Demand Location
- Open Plan Kitchen/Dining/
Living Space
- Fantastic Views To The Rear
- Carport Parking
- EPC Rating - C



A great opportunity to purchase a unique, generously proportioned, Two Double Bedroom, Semi-Detached property positioned on Huddersfield Road, benefiting from excellent access to local amenities, schools, and transport links into Oldham, Manchester and the wider North-West. With great outdoor walks on your doorstep such as Strinesdale Reservoir and open countryside a stones throw away. As well as being just a ten minute equidistant drive to both Saddleworth villages and Oldham Town Centre from this property. The property's accommodation over four floors comprises of:- Entrance Hallway, Bathroom and Utility Room to the Ground Floor. The First Floor features an Open Plan Kitchen/Dining & Living Space. From the Dining Space a spiral staircase leads to the Second Floor Double Bedroom with En-Suite. The Lower Ground Floor Double Bedroom also has it's own WC. To the rear there is an enclosed garden area and to the front there is an integrated

Ci

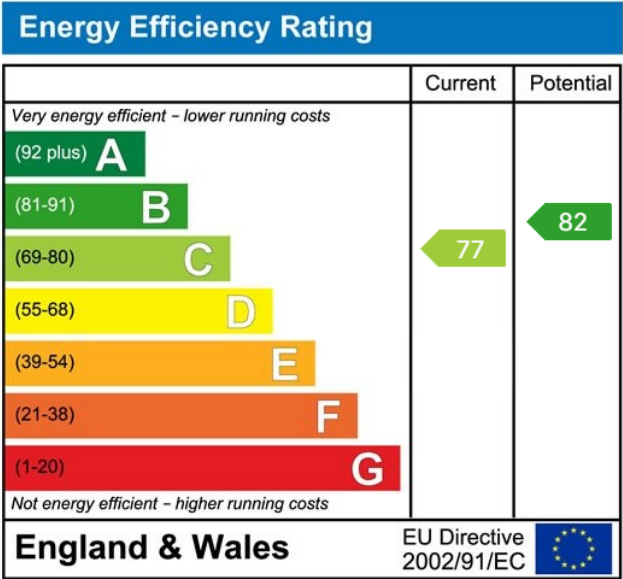
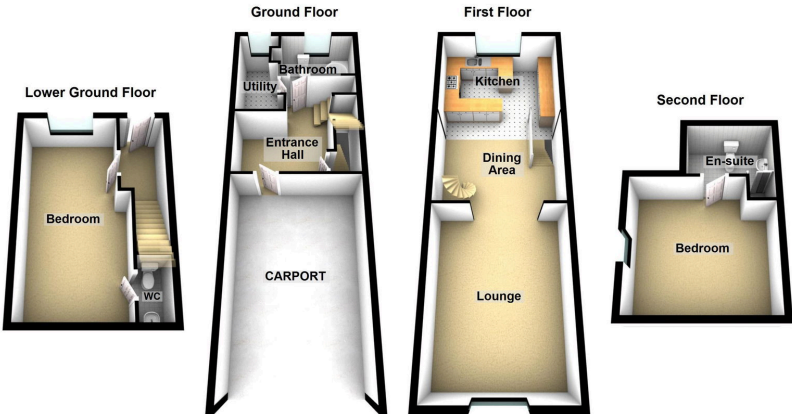

Chadderton Office
 509 Middleton Road,
 Chadderton, Oldham,
 OL9 9SH

chadderton@kirkham-property.co.uk
 t: 0161 626 5688