



Henry Bird Way

Southbridge, Northampton

oriordanbond
SALES & LETTINGS



GROUND FLOOR
422 sq.ft. (39.2 sq.m.) approx.

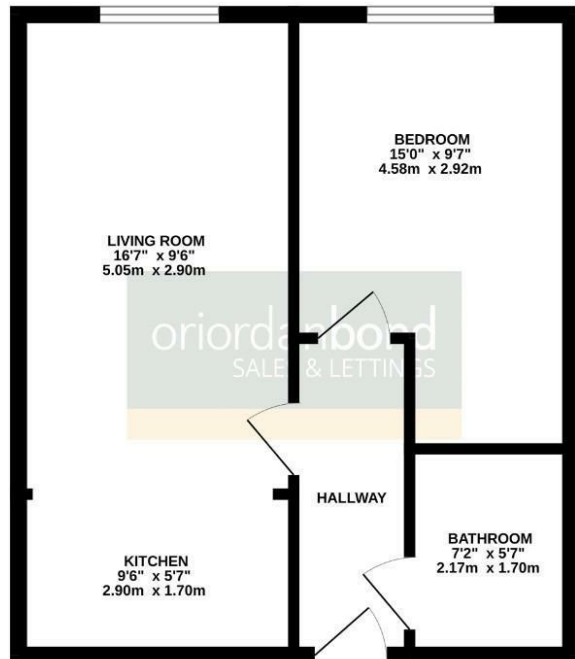

TOTAL FLOOR AREA : 422 sq.ft. (39.2 sq.m.) approx.
Whilst every attempt has been made to ensure the accuracy of the floorplan contained here, measurements of doors, windows, rooms and any other items are approximate and no responsibility is taken for any error, omission or mis-statement. This plan is for illustrative purposes only and should be used as such by any prospective purchaser. The services, systems and appliances shown have not been tested and no guarantee as to their operability or efficiency can be given.
Made with Metropac.co.uk

Henry Bird Way

Southbridge

NN4 8GL

PRICE £115,000

This one bedroom ground floor apartment, offered for sale with no onward chain, is in the very popular area of Southbridge, part of NN4. The apartment is located near to the River Nene and provides good access to Northampton town centre and train station.

The accommodation comprises entrance hall, open plan living/kitchen with built-in oven, hob and extractor over, a double bedroom and a three-piece bathroom suite. Benefits include uPVC double glazing, gas radiator heating and an allocated parking space for one car. (B/422/ -)

Leasehold information: Lease Remaining - 102 years (s of 2026) / Ground Rent - £195 per annum / Service Charge - £700 per annum

Additional information

- Council Tax Band: B
- Energy Efficiency Rating: C

Viewing

Viewing strictly by appointment – details below

Disclaimer

O'Riordan Bond Estate Agents Limited has not tested apparatus, equipment, fittings or services and so cannot verify they are in working order. The buyer is advised to obtain verification from their solicitor or surveyor.

O'Riordan Bond Far Cotton Sales

01604 706007

farcotton@oriordanbond.co.uk

