



Price

£95,000

Leasehold

1x  1x  1x 

**Forest Dene Court,
Cedar Road, Sutton,
Surrey, SM2**

cubitt & west
Helping you move forwards



Main features

- Immaculately kept apartment within popular retirement development
- Resident's & visitor's parking
- Communal lounge and kitchen that hosts social events
- Laundry room on ground floor
- Walking distance to Sutton High Streets & close proximity to amenities

Accommodation

SECOND FLOOR

- Entrance Hall
- Lounge: 14'3 x 11'5 (4.35m x 3.48m)
- Kitchen: 7'3 x 5'9 (2.21m x 1.75m)
- Bedroom: 17'7 maximum x 8'7 (5.36m x 2.62m)
- Shower Room

OUTSIDE

- Communal Gardens
- Residents Permit Parking

Second Floor

Approx. 45.1 sq. metres (485.5 sq. feet)

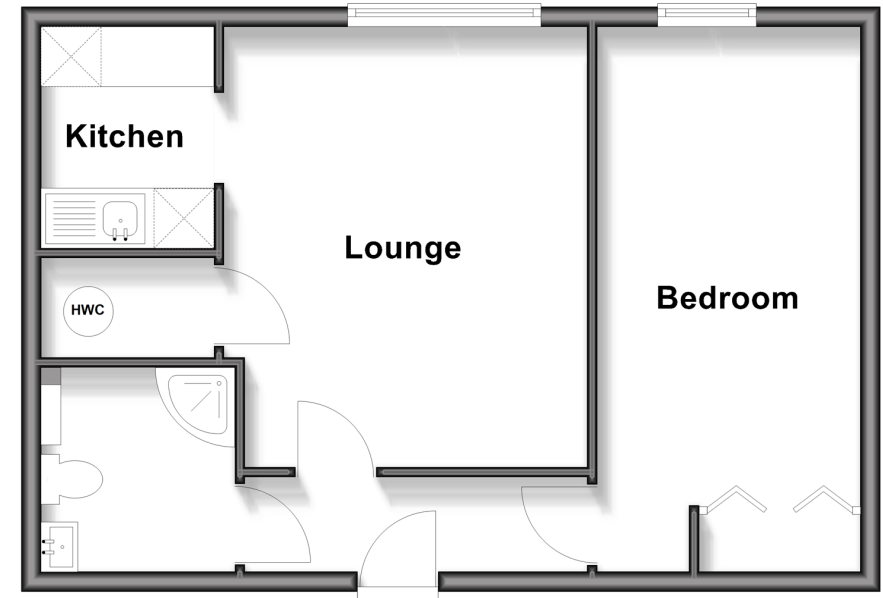

Call Sutton - 020 8661 0330 ■ cubittandwest.co.uk

■ Legal advice should be taken to verify fixtures/fittings, planning, alterations and/or lease details

■ Appliances & services are untested, dimensions are approximate and floor plans are not to scale



22018090/20250602/KWK/KWK