



## 148 HIGH STREET NORTHAMPTON, NN5 4AX

**£150,000**  
**LEASEHOLD**

Stonhills are pleased to offer this well presented one double bedroom ground floor apartment situated in the popular area of Upton. The accommodation comprises open plan living/kitchen area with fitted appliances, double bedroom with wardrobe and bathroom. Benefits include high ceilings, secure parking, light accommodation, close proximity to Upton Country Park, local amenities and good access to the M1. Ideal first time buy or investment.

 **stonhills**  
LAND & ESTATE AGENTS

GROUND FLOOR  
527 sq.ft. (49.0 sq.m.) approx.

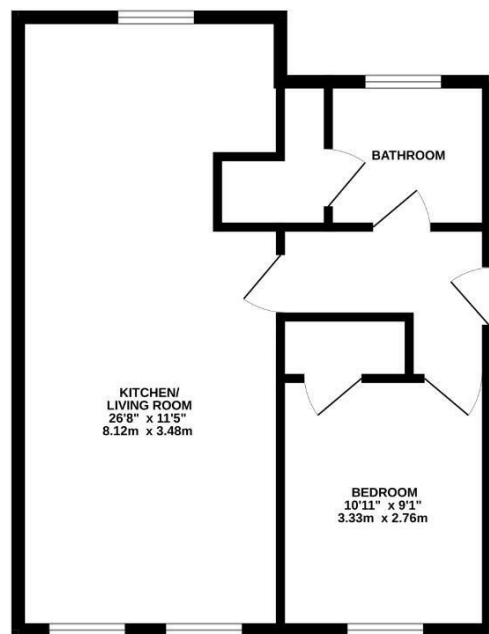

TOTAL FLOOR AREA: 527 sq.ft. (49.0 sq.m.) approx.

Whilst every attempt has been made to ensure the accuracy of the floorplan contained here, measurements of doors, windows, rooms and any other items are approximate and no responsibility is taken for any error, omission or mis-statement. This plan is for illustrative purposes only and should be used as such by any prospective purchaser. The architect, surveyor and agencies have not been asked and do not guarantee, as to their qualifications or experience can be given. Plans made with AutoCAD 2009.

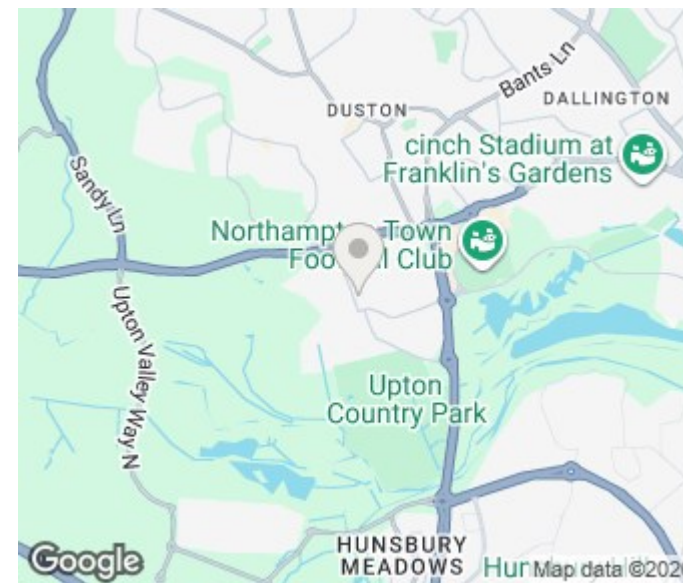

Energy Efficiency Rating		
	Current	Potential
Very energy efficient - lower running costs		
(92 plus) <b>A</b>		
(81-91) <b>B</b>		
(69-80) <b>C</b>		
(55-68) <b>D</b>		
(39-54) <b>E</b>		
(21-38) <b>F</b>		
(1-20) <b>G</b>		
Not energy efficient - higher running costs		
<b>England &amp; Wales</b>	EU Directive 2002/91/EC	

Agents Note: Whilst every care has been taken to prepare these particulars, they are for guidance purposes only. All measurements are approximate and are for general guidance purposes only and whilst every care has been taken to ensure their accuracy, they should not be relied upon and potential buyers/tenants are advised to recheck the measurements

Northampton Office Sales  
39 St Giles Street  
Northampton  
Northamptonshire  
NN1 1JF

01604 624424  
lewis@stonhills.co.uk  
<https://www.stonhills.co.uk/>

