



Hare Hall Lane, RM2 6BD

£1,850 Per Month



****STUNNING PERIOD PROPERTY WITH PRIVATE GARDEN – MINUTES FROM GIDEA PARK STATION (ELIZABETH LINE)****

OC Homes is delighted to offer this exceptional two-bedroom ground-floor flat, featuring a private garden and exquisite period details. This distinctive property includes a spacious lounge, a separate dining area, a fitted kitchen, two generously sized double bedrooms, and a four-piece bathroom suite.

Additional benefits include a private garden, perfectly positioned in the sought-after Gidea Park area, with convenient access to local amenities and public transport. Gidea Park Rail Station, a mere 5-minute walk from the property, offers an ideal location for commuters travelling into London.

- PERIOD FEATURES
- PRIVATE GARDEN
- WALKING DISTANCE TO GIDEA PARK STATION (ELIZABETH LINE)
- GROUND FLOOR
- TWO DOUBLE BEDROOMS
- DINING AREA
- AVAILABLE NOW

AVAILABLE NOW

Viewing

Please contact our OC Homes Gidea Park Office on 01708989888 if you wish to arrange a viewing appointment for this property or require further information.



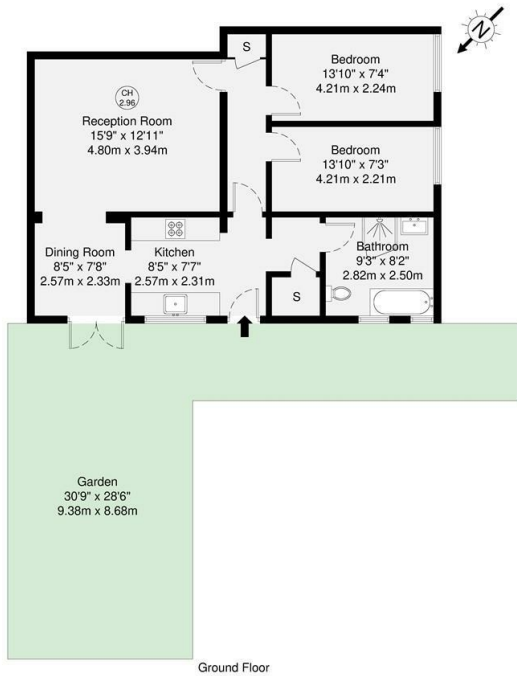

GROSS INTERNAL AREA (GIA) The total area of the property	TOTAL STORAGE SPACE Storage and wardrobe total area	EXTERNAL FEATURES Garden, Balcony, Terrace, Transoms etc.	RESTRICTED HEAD HEIGHT Landing on area under 2.0m
72.3 sq m / 778 sq ft	1.8 sq m / 19 sq ft	81.4 sq m / 876 sq ft	0.0 sq m / 0.0 sq ft

Disclaimer: Floorplan measurements are approximate and are for illustrative purposes only. While we do not doubt the floorplan accuracy and completeness, you or your advisors should conduct a careful, independent investigation of the property in respect of monetary valuation.

Maison VUE



Energy Efficiency Rating	
Current	Potential
69	77

Environmental Impact (CO ₂) Rating	
Current	Potential
67	78



These particulars, whilst believed to be accurate are set out as a general outline only for guidance and do not constitute any part of an offer or contract. Intending purchasers should not rely on them as statements of representation of fact, but must satisfy themselves by inspection or otherwise as to their accuracy. No person in this firm's employment has the authority to make or give any representation or warranty in respect of the property.