

ALLDAY  
& MILLER



Egerton Road, Slough, SL2 2LD  
£525,000

3 2 1 D





Egerton Road, Slough, SL2 2LD

**£525,000**

- Three Bedroom Home
- Bright & Spacious Living Room
- Double Glazed Windows
- Stylish Fitted Kitchen With Generous Storage And Preparation Areas
- Ideal For First Time Buyers & Investors
- Newly Refurbished Throughout
- Excellent Transport Links Including Burnham Station
- Well Proportioned Bedrooms
- Large Secluded Rear Garden
- Freehold



## Description

This well-presented family home offers a delightful blend of comfort and practicality. As you step inside, you are welcomed by a spacious dining room, the reception room is equally inviting, perfect for relaxation, a modern fitted kitchen and a downstairs WC which completes this floor.

Venturing to the first floor, you will find three well-proportioned bedrooms and a family bathroom.

Outside, the private rear garden is mainly laid to lawn, providing a wonderful space for outdoor dining and entertainment. The garden also features access to the garage, adding further convenience for storage.

## Situation

Egerton Road is a well-established and popular residential area offering a convenient and family-friendly setting with excellent access to local amenities, schools and transport links. The property is well positioned for a range of well-regarded primary and secondary schools, as well as nurseries and further education facilities, making it ideal for families. Slough town centre and mainline railway station are easily accessible, providing fast and frequent services to London Paddington, with Elizabeth Line services offering improved connectivity across London, while the M4, M25 and M40 motorways are all within easy reach for commuters. A variety of local shops, supermarkets, cafés and restaurants are close by, with the Queensmere Observatory Shopping Centre offering a wide selection of high-street retailers, and additional shopping, dining and leisure options available in nearby Windsor, Maidenhead and Uxbridge. The area also benefits from nearby parks and green spaces, as well as easy access to Windsor Great Park and other recreational facilities, making it a well-connected and desirable location.





## Floor Plans

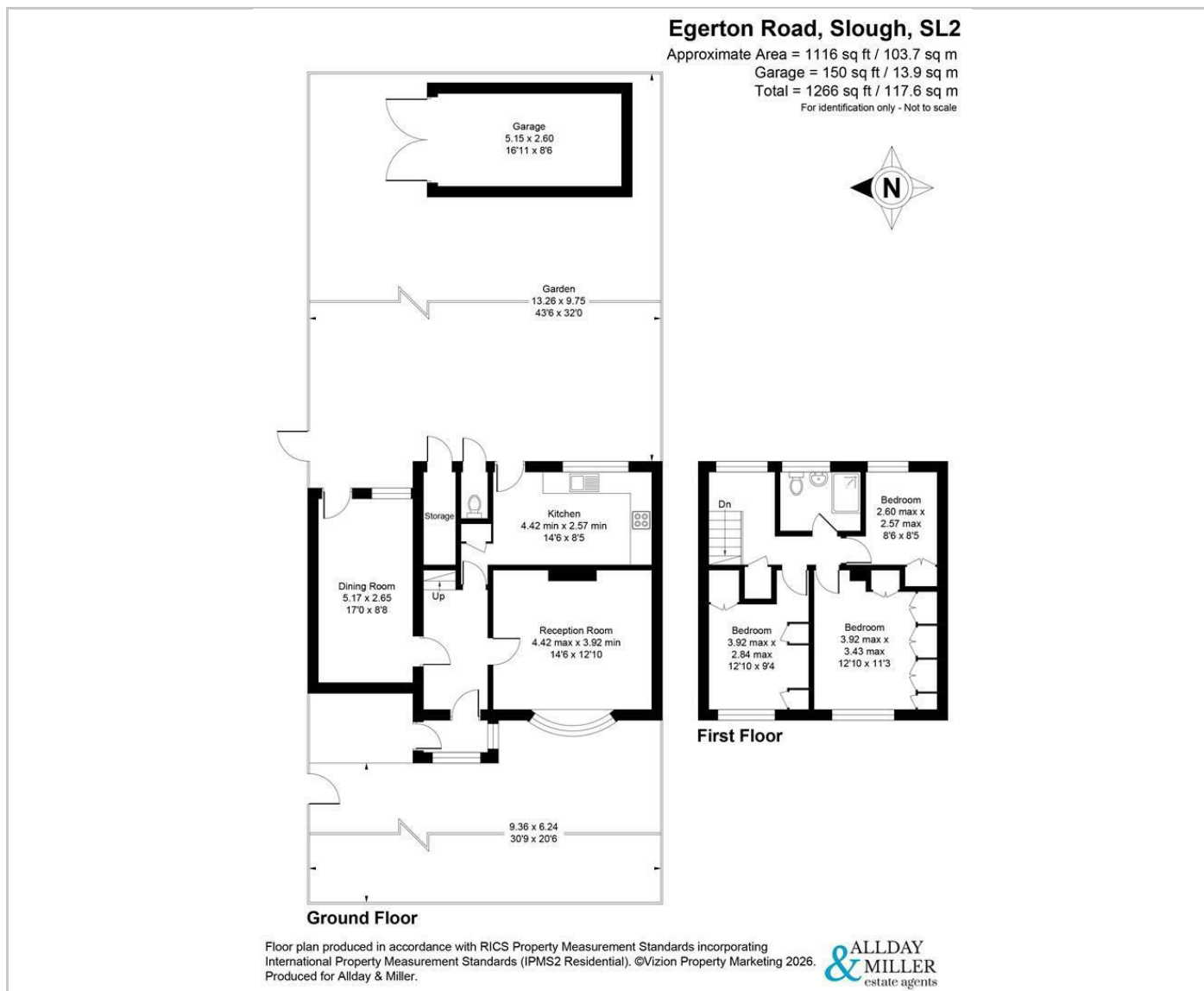

## Area Map

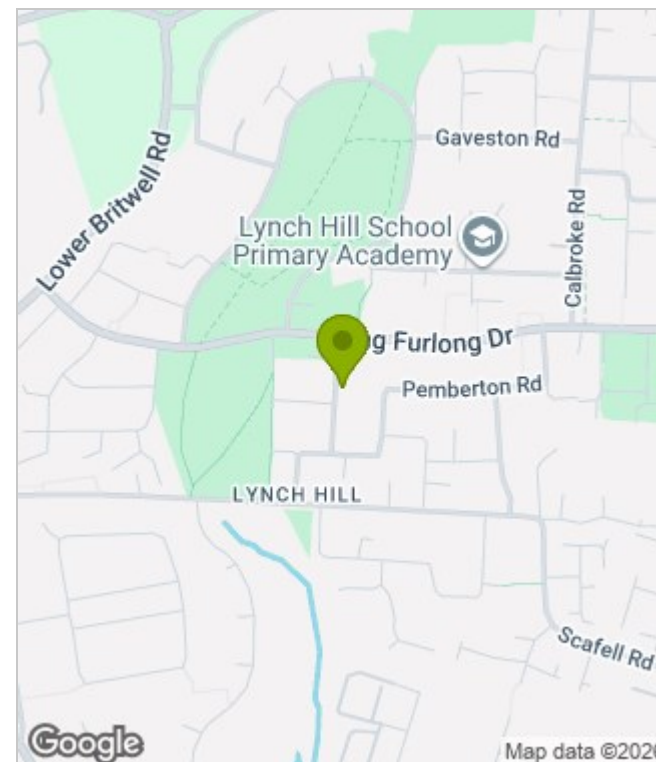

## Energy Performance Graph

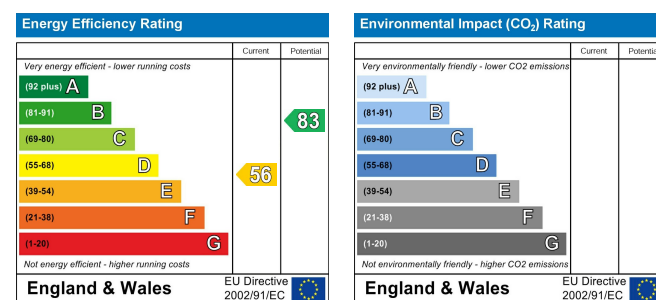

These particulars, whilst believed to be accurate are set out as a general outline only for guidance and do not constitute any part of an offer or contract. Intending purchasers should not rely on them as statements of representation of fact, but must satisfy themselves by inspection or otherwise as to their accuracy. No person in this firm's employment has the authority to make or give any representation or warranty in respect of the property.