

A stone barn conversion with a tiled roof, a chimney, and a garden with a pool and patio. The house is made of light-colored stone and has a brown tiled roof. A chimney is visible on the left side. The garden features a small pool, a patio with a table and chairs, and various plants and bushes. The sky is blue with scattered white clouds.

Symonds  
& Sampson

# Barn View

Lyatts, Hardington Moor, Yeovil, Somerset

# Barn View

Lyatts  
Hardington Moor  
Yeovil  
BA22 9NR



- Deceptively Spacious
- Lovely Gardens
- Stunning Views
- Double Garage and Parking
- Flexible Accommodation
- Internal Viewing Advised

Guide Price **£675,000**

Freehold

Yeovil Sales  
01935 423526  
[yeovil@symondsandsampson.co.uk](mailto:yeovil@symondsandsampson.co.uk)



## THE DWELLING

This is a beautifully presented barn conversion with UPVC double glazing, oil central heating, attractive solid oak doors, extensive oak flooring and also benefiting from fast fibre broadband direct to the property. The phrase deceptively spacious is used extensively in our profession, but this is very much the case with this property, and an internal viewing is absolutely essential.

## ACCOMMODATION

A part glazed entrance door leads to the reception hall having a staircase rising to the super kitchen/dining room, whilst off the hall is the sitting room, being a very good size and having a lovely central feature woodburner with natural stone pillars either side and superb timber beam over, patio doors to the front and attractive french twin glazed doors to the reception hall.

Also on the ground floor is a dining room, a cloakroom with a white suite and a utility room.

The kitchen/breakfast room is absolutely sensational, fitted with a comprehensive range of Silestone quartz worktops with white doors and stainless steel door furniture. Fitted appliances include a stainless steel double oven, dishwasher, an island unit with a four-ring hob with stainless steel/glass hood over and a wine cooler under.

There is an excellent range of base units with drawers and cupboards under and wall cupboards, whilst two pairs of French doors lead to the rear garden, and there is also a large double utility cupboard.

A staircase leads to the next landing, which has an airing cupboard, and in turn a staircase leads to bedroom 4/games room. There are three bedrooms, an en suite to the master, and two having double wardrobes, and an attractive family bathroom fully tiled with a white suite and spa bath.

Finally, on the next floor is bedroom four, which offers lovely country views and could also be used as a games room/study, etc.





## OUTSIDE

At the front of the house, there is parking for 3/4 vehicles, which leads to a double garage with twin up and over doors with light and power connected and a staircase leading to the attic room.

There are pleasant lawned gardens with a pond, deep stocked borders, raised flower beds, an oil tank, gravel pathways and fronting onto fields, whilst to the rear there is a private patio garden.

## SITUATION

Lyatts is a beautiful, rural hamlet on the edge of Hardington Moor, surrounded by the beautiful rolling countryside on the Somerset/Dorset border. The village of Hardington Mandeville, largely constructed of period property, is situated approximately one mile away, with a post office, church and popular public house, The Royal Oak. The property lies approximately 4.5 miles to the southwest of Yeovil and is convenient for a wide range of

shopping/business, and leisure amenities that Yeovil offers.

## DIRECTIONS

What 3 words: [///bypassed.crumb.breathing](#)

## SERVICES

Mains water, electricity and private drainage shared between the three barn conversions, with the costs of maintenance split annually. Oil-fired central heating.

Broadband - Ultrafast FTTP broadband is available.  
 Mobile signal/coverage - Available both indoors and outside  
 (Information from Ofcom  
<https://www.ofcom.org.uk>)

## MATERIAL INFORMATION

Council Tax Band: F

Flood Risk: Very Low

Energy Efficiency Rating		Current	Potential
100-109	A		
81-100	B		
62-80	C	66	76
43-61	D		
22-42	E		
1-21	F		
0-21	G		

A01 Energy efficient - higher energy costs  
 England & Wales  
 EPC Directive  
 2002/91/EC



# Barn View, Lyatts, Hardington Moor, Yeovil

Approximate Area = 1855 sq ft / 172.3 sq m

Garage = 580 sq ft / 53.8 sq m

Total = 2435 sq ft / 226.1 sq m

For identification only - Not to scale

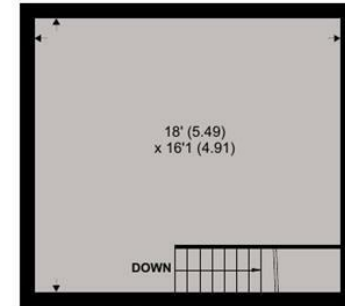

GARAGE FIRST FLOOR

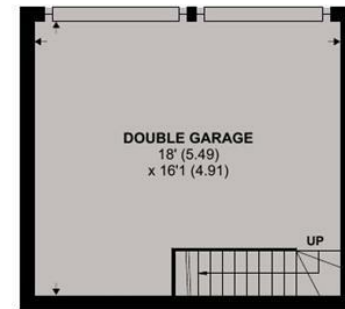

GARAGE GROUND FLOOR



Floor plan produced in accordance with RICS Property Measurement 2nd Edition, Incorporating International Property Measurement Standards (IPMS2 Residential). Produced for Symonds & Sampson. REF: 1314495

© nchecon 2025.



YEO/JS/26.06.2025



01935 423526

yeovil@symondsandsampson.co.uk  
Symonds & Sampson LLP  
2, Court Ash,  
Yeovil, Somerset BA20 1HG



Important Notice: Symonds & Sampson LLP and their Clients give notice that: 1. They have no authority to make or give any representations or warranties in relation to the property. These particulars do not form part of any offer or contract and must not be relied upon as statements or representations of fact. 2. Any areas, measurements or distances are approximate. The text, photographs and plans are for guidance only and are not necessarily comprehensive. It should not be assumed that the properties have all necessary planning, building regulation or other consents and Symonds and Sampson LLP have not tested any services, equipment of facilities. 3. We have not made any investigation into the existence or otherwise of any issues concerning pollution of the land, air or water contamination and the purchaser is responsible for making his/her own enquiries in this regard. 4. The property is sold subject to and with the benefit of all existing wayleaves, easements and rights of way whether public or private, specifically mentioned or not. The vendors shall not be required to define any such rights, privileges or advantages.

SALES | LETTINGS | AUCTIONS | FARMS & LAND | COMMERCIAL | NEW HOMES | PLANNING & DEVELOPMENT