

Property Location

Sunnydene Farm is a 2-acre plot situated between West Camel and Bridgehampton in Somerset. The nearest town is Yeovil which is 6 miles to the south and offers plenty of amenities including shops, restaurants and a cinema. The nearby A303 provides links to London and Exeter.

Sunnydene Farm, Bridgehampton, Somerset

Approximate Gross Internal Area = 90.9 sq m / 978 sq ft
(Including External WC)

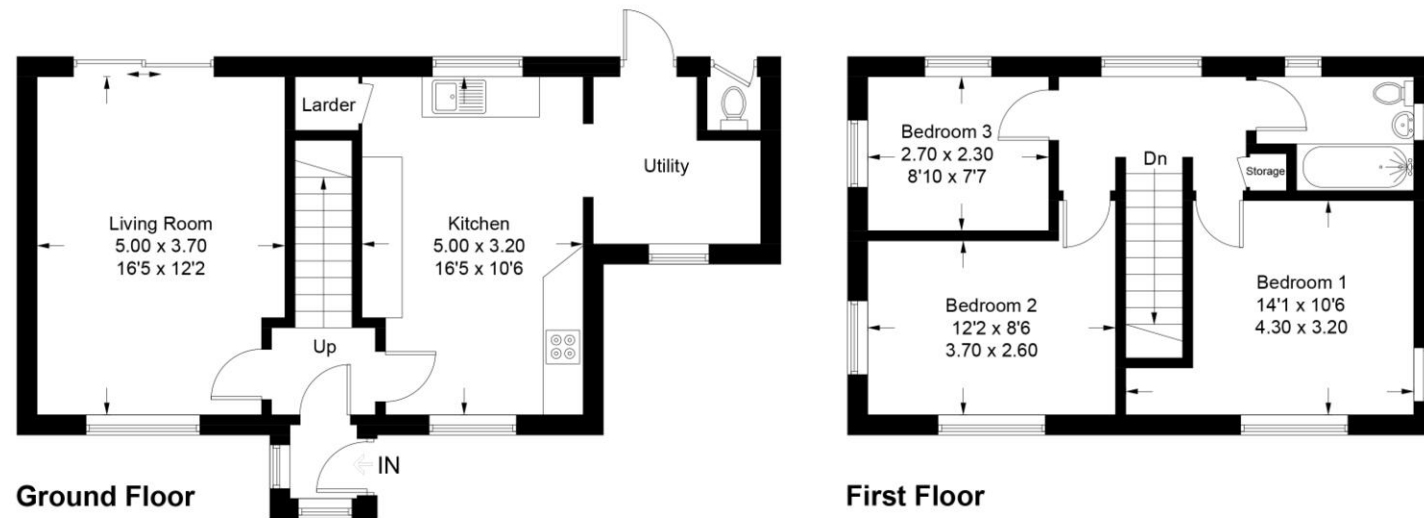

Illustration for identification purposes only, measurements are approximate, not to scale. Fourlabs.co © (ID1262088)



Accuracy: References to the Tenure of a Property are based on information supplied by the Seller. The Agent has not had sight of the title documents. A Buyer is advised to obtain verification from their Solicitor. Items shown in photographs including but not limited to carpets, fixtures and fittings are not included unless specifically mentioned within the sales particulars. They may however be available by separate negotiation. Buyers must check the availability of any property and make an appointment to view before embarking on any journey to see a property. No person in the employment of the agent has any authority to make any representation about the property, and accordingly any information given is entirely without responsibility on the part of the agents, sellers(s) or lessors(s). Any property particulars are not an offer or contract, nor form part of one.

Sonic / Laser Tape: Measurements taken using a sonic / laser tape measure may be subject to a small margin of error. **All Measurements:** All Measurements are Approximate. **Services Not tested:** The Agent has not tested any apparatus, equipment, fixtures and fittings or services and so cannot verify that they are in working order or fit for the purpose. A Buyer is advised to obtain verification from their Solicitor or Surveyor.

Sunnydene Farm, Bridgehampton

Offers In Region Of £475,000



Sunnydene Farm
Somerset
BA22 8HG

Key features:

- Approx. 2 Acre (0.8 Hectare) Plot
- Chain Free
- Three Bedroom Detached House
- Storage and Outbuildings
- Rural Setting
- Close to A303



Why you'll like it

Sunnydene Farm is an approximately 2-acre (0.8 hectare) plot situated in the village of West Camel in Somerset. The plot includes a three-bedroom detached house, large hard-standing driveway, single story outbuildings and sheds. A perfectly located plot offering plenty of scope for renovation subject to relevant planning approval. Viewing is highly recommended.

FARM HOUSE: A three-bedroom detached property featuring a living room, kitchen, utility, three double bedrooms, family bathroom, front and rear gardens. The property is 'sold as seen' and would benefit from modernising and renovations throughout. The Property is situated on the hillside and offers stunning views across the Somerset countryside.

OUTBUILDINGS: Adjacent to the three-bedroom house is a mixture of single-story outbuildings and sheds/stables. Providing ample storage. The outbuildings consist of a large central room which provides access to multiple side rooms and a w/c.

PLOT: The plot rests on a gentle hill between West Camel and Bridgehampton, Somerset. The nearby A303 provides quick access to London and Exeter. Boasting an approximate 2.0-acre (0.8 hectare) plot which could make a fantastic opportunity for renovation, development or agricultural uses.

Score	Energy rating	Current	Potential
92+	A		
81-91	B		
69-80	C		
55-68	D		55 D
39-54	E		
21-38	F	23 F	
1-20	G		

