



Partridge Close, Swindon



**£180,000**

- One Bedroom Semi-detached Home
- Driveway Parking
- Generous Rear Garden
- Desirable Area
- Tenure: Freehold
- Council Tax Band: C
- EPC rating: TBC

Because property is personal with...

**Belvoir**



A fantastic opportunity to purchase this lovely semi-detached home, situated in the highly popular Covingham area of East Swindon. Featuring a generous enclosed rear garden and driveway parking, this property is an ideal first-time purchase or an excellent investment opportunity.

The well-presented accommodation comprises an entrance hallway, a fitted kitchen, and a spacious living room. To the first floor, there is a bedroom with a built-in wardrobe, a bathroom with shower, and benefits from additional storage space to the landing.

Further benefits include uPVC double-glazed windows and doors, as well as side access to the rear garden.

Call now to book a viewing 01793 542060

These particulars are issued in good faith but do not constitute representations of fact or form part of any offer or contract. The matters referred to in these particulars should be independently verified by prospective buyers or tenants. Neither Belvoir nor any of its employees or agents has any authority to make or give any representation or warranty whatever in relation to this property. FLOOR PLANS - The floorplans are intended as a guide only. This is NOT TO SCALE and dimensions are approximate. These particulars have been prepared for the guidance of intending purchasers but no guarantee of their accuracy is given, neither do they form a contract of any part thereof.



## Ground Floor

Approx. 21.3 sq. metres (229.0 sq. feet)

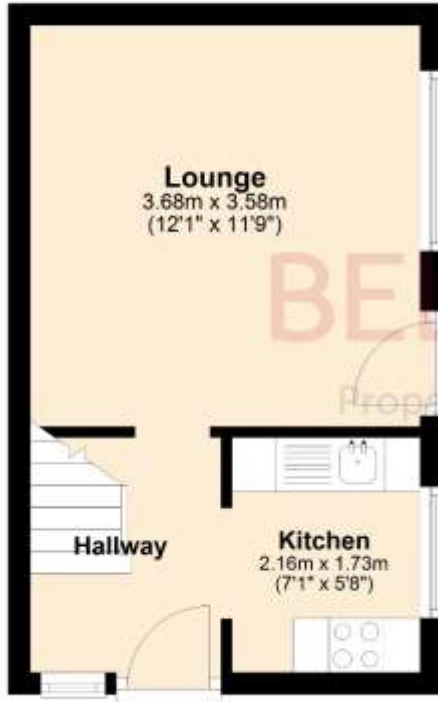

## First Floor

Approx. 21.7 sq. metres (233.9 sq. feet)



Total area: approx. 43.0 sq. metres (463.0 sq. feet)

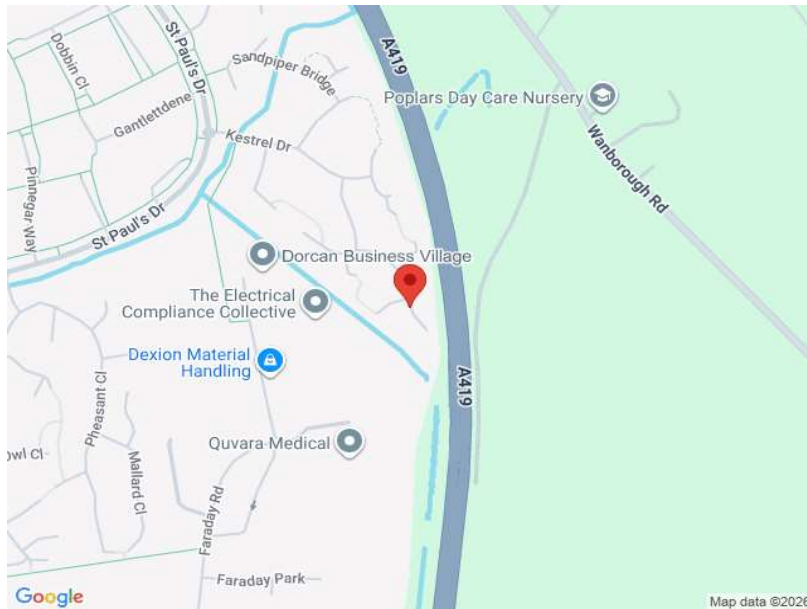

# Belvoir

Belvoir Swindon

01793 542060

swindon@belvoir.co.uk