



North End Road, W14

£525,000

A three bedroom apartment situated in the heart of West Kensington. Offering ample space throughout with a large living area that leads to a private balcony. This property is an ideal rental investment or for a buyer wanting more value for money.

Mortimer House is within reach of West Kensington and Barons Court tube station. You are well connected to Heathrow Airport and you will find numerous supermarkets, cafes and shops close by.

Features

- Leasehold
- No Onward Chain
- Three Bedrooms
- Private Balcony
- Close To Tube
- Lift Service

North End Road, London, W14

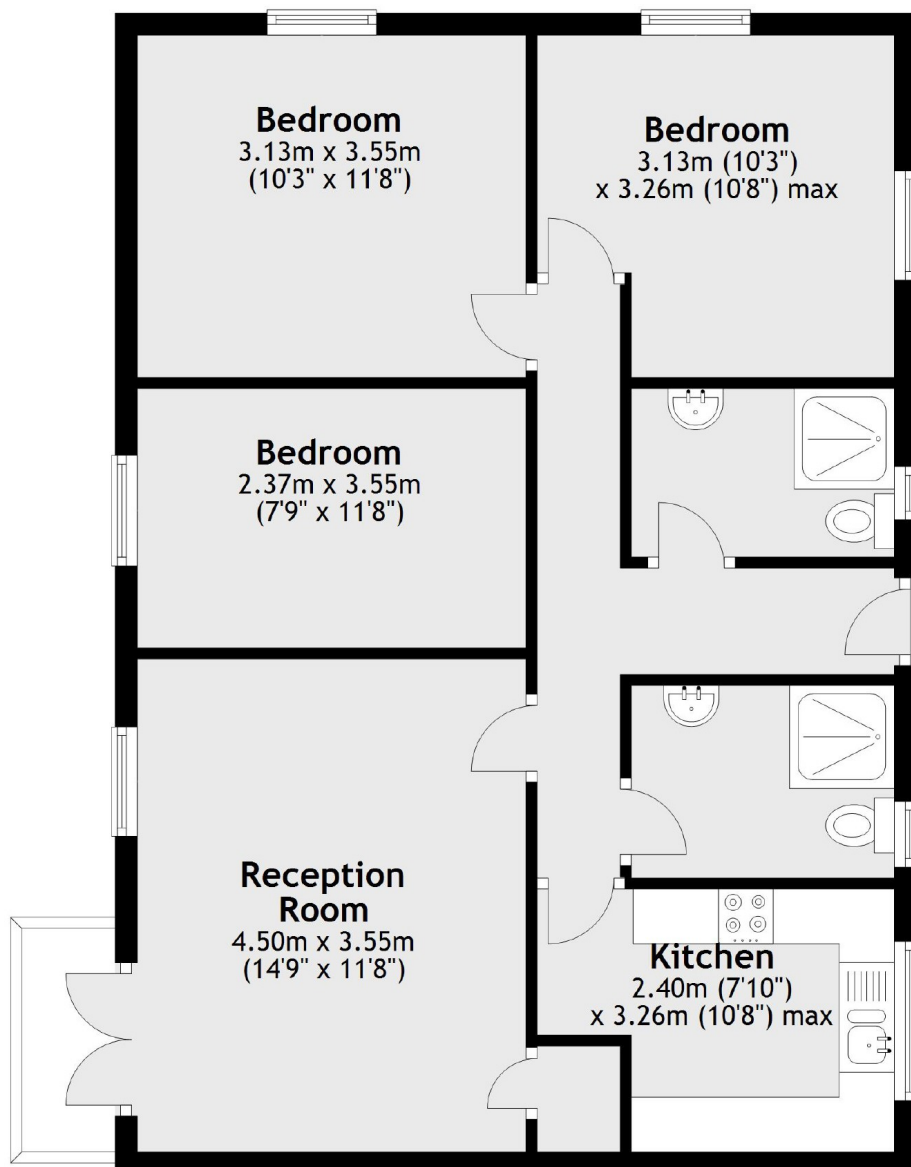

Total area: approx. 70.4 sq. metres (757.6 sq. feet)