

Butler's

thoughtful estate agency



Stonecot Hill, Sutton, SM3 9HE
Guide price £375,000



Floor Plan

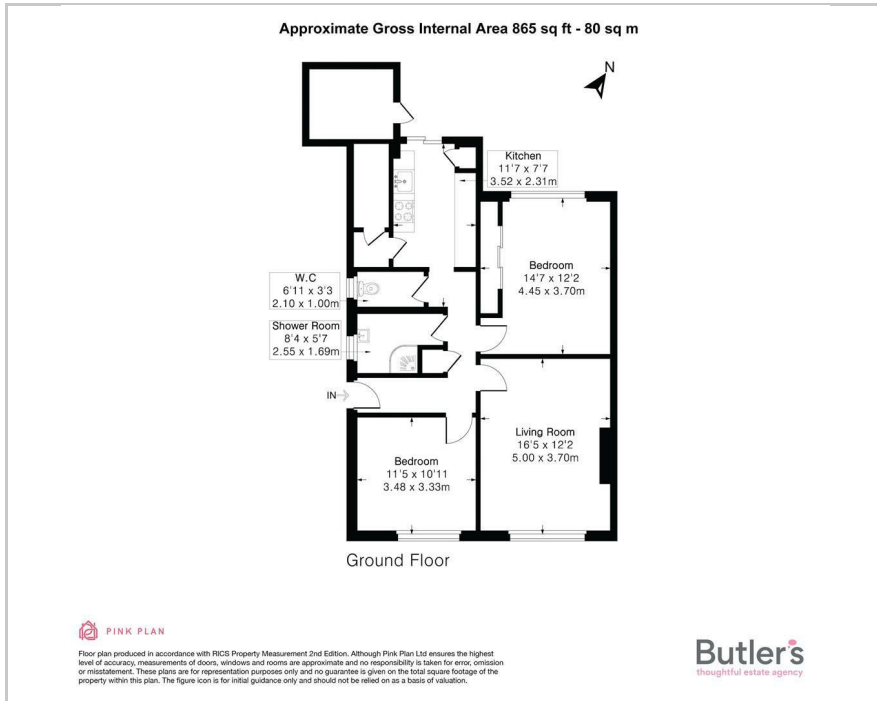

Area Map

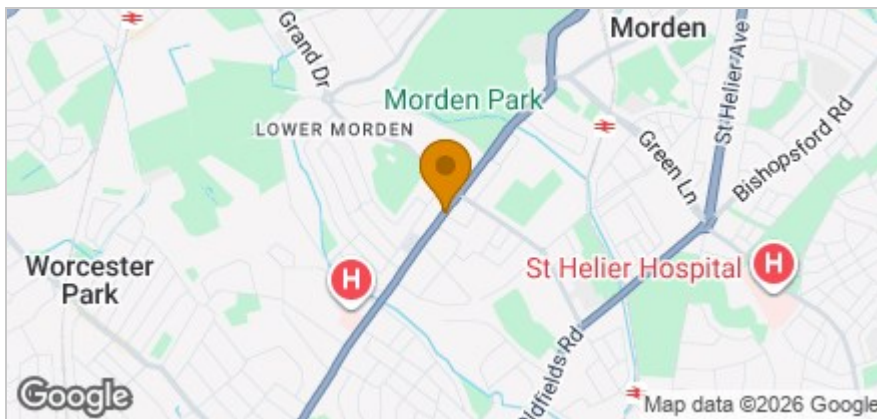

Accommodation

- Spacious 2 bedroom maisonette
- Ground floor with direct access to garden
- Double bedrooms
- Modern kitchen & bathrooms
- Front & rear gardens
- Central position yet offset and shielded from the road
- Large living/dining room
- Close to excellent transport links, amenities & schooling
- External storage room
- Street Parking Available

Viewing

Please contact our Butler's Worcester Park Office on 020 39 069 169 if you wish to arrange a viewing appointment for this property or require further information.

Energy Efficiency Graph

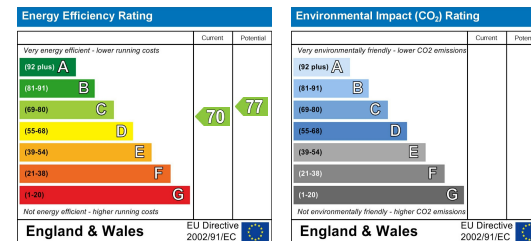

These particulars, whilst believed to be accurate are set out as a general outline only for guidance and do not constitute any part of an offer or contract. Intending purchasers should not rely on them as statements of representation of fact, but must satisfy themselves by inspection or otherwise as to their accuracy. No person in this firm's employment has the authority to make or give any representation or warranty in respect of the property.

64 Central Road, Worcester Park, KT4 8HY

Tel: 020 39 069 169 Email: worcesterpark@butlershomes.co.uk butlershomes.co.uk