



WIL WESTWOODLEBER

**WIL WESTWOODLEBER**  
LET US GUIDE YOU HOME

Rye Road, Hoddesdon, EN11 0HP  
Guide price £399,995



## Rye Road, Hoddesdon, EN11 0HP

Westwood Leber are delighted to bring to the market this beautifully refurbished two-bedroom period terrace, ideally situated in the heart of Hoddesdon.

This stunning home has been thoughtfully renovated and offers a perfect blend of contemporary styling and character features throughout. The ground floor comprises a stylish refitted kitchen with premium Quartz worktops, a spacious dining room, and a bright and welcoming living room with bay window, creating excellent living and entertaining space.

The first floor features two well-proportioned double bedrooms and an impressive refitted four-piece family bathroom suite, finished to a high standard.

Further benefits include a larger-than-average rear garden, gas central heating, double glazing, and well-presented accommodation arranged over two floors.

Located within easy reach of Hoddesdon town centre, local amenities, reputable schools, and excellent transport links, this exceptional home is ideal for first-time buyers, young families, and downsizers alike.

An early viewing is highly recommended to fully appreciate the quality and character of this wonderful home.



WESTWOODLEBER

## Ground Floor

Approx. 31.8 sq. metres (342.1 sq. feet)



## First Floor

Approx. 31.6 sq. metres (340.1 sq. feet)

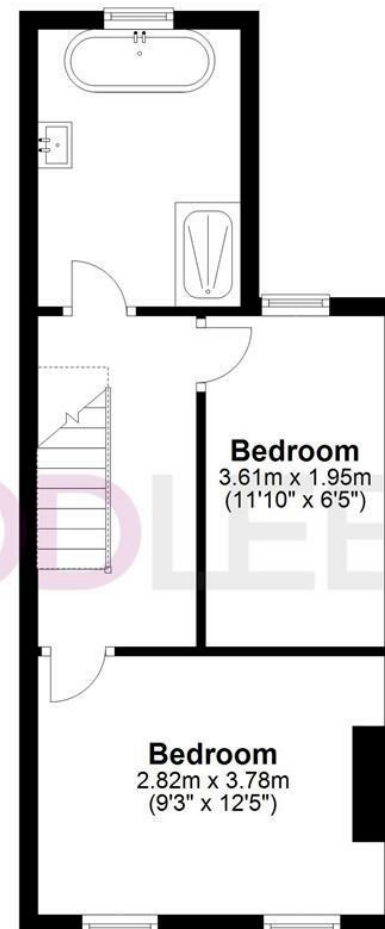

Total area: approx. 63.4 sq. metres (682.2 sq. feet)

THE FLOORPLAN IS FOR ILLUSTRATIVE PURPOSES ONLY AND IS NOT TO SCALE. Measurements and features are approximate and may differ from the actual property. Verify all details independently; no liability is accepted for errors or omissions.

Property marketing provided by [www.fotomarketing.co.uk](http://www.fotomarketing.co.uk)  
Plan produced using PlanUp.



WESTWOODLEBER



WESTWOODLEBER



WESTWOODLEBER



WESTWOODLEBER







