



## Commercial Road, E1

£400,000

Two bedroom apartment set within a popular development in a sought after location. The apartment has a spacious and bright semi-open plan living room with ample space to dine and a fully integrated kitchen. The property has two double bedrooms, one of which with in-built storage. Further storage is found in the hallway as well as the family bathroom. The development has a 24hr concierge and a residents only roof terrace.

Located in Aldgate, offering a vast selection of restaurants, bars, and cafés. This central location makes travel throughout the City easy, with both Aldgate East (Hammersmith&City, District), Liverpool Street (Elizabeth) and Shadwell (Windrush, DLR) all nearby.

### Features

- Two bedrooms
- One bathroom
- Sought after location
- 24hr concierge
- Residents roof terrace
- Great transport links

# Commercial Road, London, E1

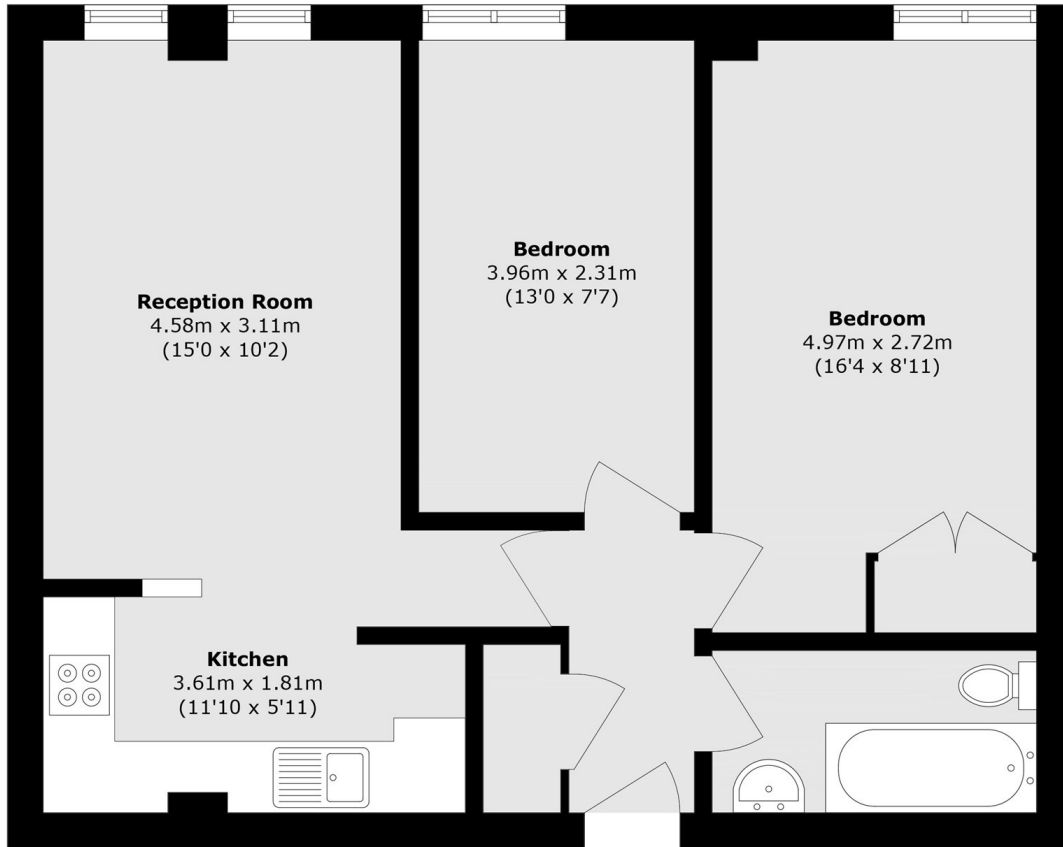

Total area (approx.): 53.9 sq. m (580.1 sq. ft)