



Church Street, Dunster, Minehead, TA24 6SH

welcome to

26 Church Street, Dunster, Minehead

Situated in the heart of the picturesque medieval village of Dunster, this delightful period property offers character, charm, and a truly enviable setting. Just moments from the iconic Dunster Castle and village amenities, enjoying generous gardens and driveway PARKING for Two vehicles. No Chain.



Description

Situated in the heart of the picturesque medieval village of Dunster, this delightful period property offers character, charm, and a truly enviable setting. Just moments from the iconic Dunster Castle and village amenities, Church Street blends historic features with comfortable living.

The property boasts well-proportioned accommodation, featuring a welcoming living space, a well-appointed kitchen, and cosy bedrooms. Period details such as exposed beams and traditional finishes add warmth and personality throughout.

Outside, the home enjoys an enclosed rear garden—perfect for relaxing or entertaining and driveway parking for two vehicles. The surrounding village provides scenic walks, independent shops, and quaint cafés right on your doorstep. Ideal as a characterful main residence, holiday retreat, or investment opportunity in one of Somerset's most sought-after locations.

Front Door

Period timber door leading to

Lounge/Dining Room

17' 9" x 16' (5.41m x 4.88m)

A spacious dual aspect room with two secondary double glazed leded light windows to front, window seat, further leded light window to side, feature fireplace with tiled surrounds, exposed beams, understairs storage cupboard, two radiators, turning staircase to first floor landing.

Kitchen

16' x 8' 4" (4.88m x 2.54m)

Window to rear overlooking rear garden, stable door to rear, attractive range of fitted base and wall units, ample worktop surfaces, inset single drainer stainless steel sink unit, space for slot in cooker, plumbing for washing machine, space for fridge freezer, radiator, fitted storage cupboard.

First Floor Landing

Window to rear, access to loft space, shelved airing cupboard with Ideal combi boiler, doors to

Bedroom One

10' 8" x 10' 6" (3.25m x 3.20m)

Secondary double glazed leded light window to front, radiator.

Bedroom Two

13' x 8' 3" (3.96m x 2.51m)

Secondary double glazed leded light window to front, exposed beams, radiator.

Bathroom

Laded light window to side, white suite comprising panel enclosed bath with shower unit over, low level WC, pedestal wash hand basin, tiled surrounds, radiator, extractor fan.

Outside

The property enjoys lovely enclosed rear gardens, generous in size and comprising patio area to the rear of the kitchen with covered sitting area, ideal for al-fresco dining, gardeners w.c. steps to a good expanse of lawn with useful timber garden store, picket fencing with gate gives access to the driveway at the rear with off street parking for two vehicles and a secure walled boundary to the rear.

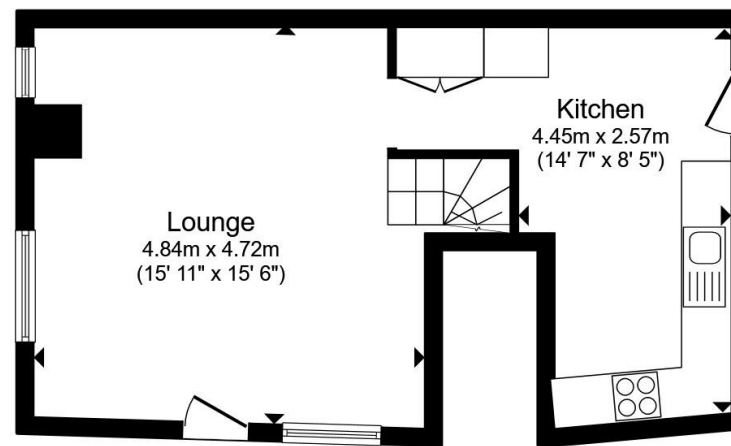

Ground Floor

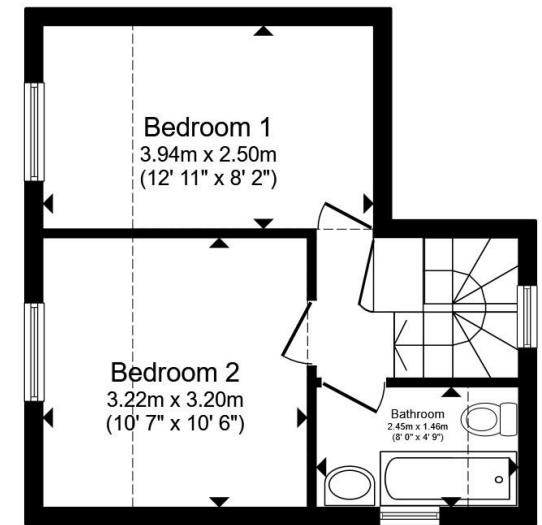

First Floor

Total floor area 65.5 m² (705 sq.ft.) approx

This floor plan is for illustrative purposes only. It is not drawn to scale. Any measurements, floor areas (including any total floor area), openings and orientation are approximate. No details are guaranteed, they cannot be relied upon for any purpose and they do not form part of any agreement. No liability is taken for any error, omission or misstatement. A party must rely upon its own inspection(s). Powered by www.propertybox.io

 fox & sons



view this property online fox-and-sons.co.uk/Property/MIH107719



welcome to

26 Church Street, Dunster, Minehead

- Charming Grade II Listed Semi Detached Cottage
- Positioned In The Heart Of Dunster With Parking
- Spacious Sitting/Dining Room - Fitted Kitchen
- Two Double Bedrooms - Bathroom - Gas Heating
- Lovely Enclosed Gardens - Driveway Parking To Rear

Tenure: Freehold EPC Rating: Exempt
Council Tax Band: C

£325,000



Please note the marker reflects the
postcode not the actual property

view this property online fox-and-sons.co.uk/Property/MIH107719



Property Ref:
MIH107719 - 0002

1. MONEY LAUNDERING REGULATIONS Intending purchasers will be asked to produce identification documentation at a later stage and we would ask for your co-operation in order that there is no delay in agreeing the sale. 2. These particulars do not constitute part or all of an offer or contract. 3. The measurements indicated are supplied for guidance only and as such must be considered incorrect. Potential buyers are advised to recheck measurements before committing to any expense. 4. We have not tested any apparatus, equipment, fixtures or services and it is in the buyers interest to check the working condition of any appliances. 5. Where an EPC, or a Home Report (Scotland only) is held for this property, it is available for inspection at the branch by appointment. If you require a printed version of a Home Report, you will need to pay a reasonable production charge reflecting printing and other costs. 6. We are not able to offer an opinion either written or verbal on the content of these reports and this must be obtained from your legal representative. 7. Whilst we take care in preparing these reports, a buyer should ensure that his/her legal representative confirms as soon as possible all matters relating to title including the extent and boundaries of the property and other important matters before exchange of contracts.

fox & sons



01643 702281



minehead@fox-and-sons.co.uk



13 The Parade, MINEHEAD, Somerset, TA24
5NL



fox-and-sons.co.uk