



## The Green, Bury St. Edmunds, IP28 8QH

Rent - £1,390 PCM

Deposit - £1,603

This detached bungalow is located in the popular village of West Row, just outside Mildenhall. The accommodation includes a generous open-plan living and dining space, a fitted kitchen with adjoining utility room, three bedrooms with built-in storage, and a family bathroom.

Outside, the property offers a private garden mainly laid to lawn with a patio area, along with a large driveway providing parking for multiple vehicles. A single garage adds further practicality and storage.

Ideally positioned, the property benefits from convenient access to both RAF Mildenhall and RAF Lakenheath, making it a great option for those seeking space, parking, and a village setting close to local amenities.

- DETACHED BUNGALOW
- THREE BEDROOMS
- FITTED KITCHEN WITH UTILITY
- GARAGE AND DRIVEWAY
- EPC RATING - D
- CLOSE TO RAF BASES
- SPACIOUS LOUNGE DINER
- BUILT IN WARDROBES
- GENEROUS REAR GARDEN
- COUNCIL TAX BAND - C



Council Tax Band: C - EPC Rating: D 57



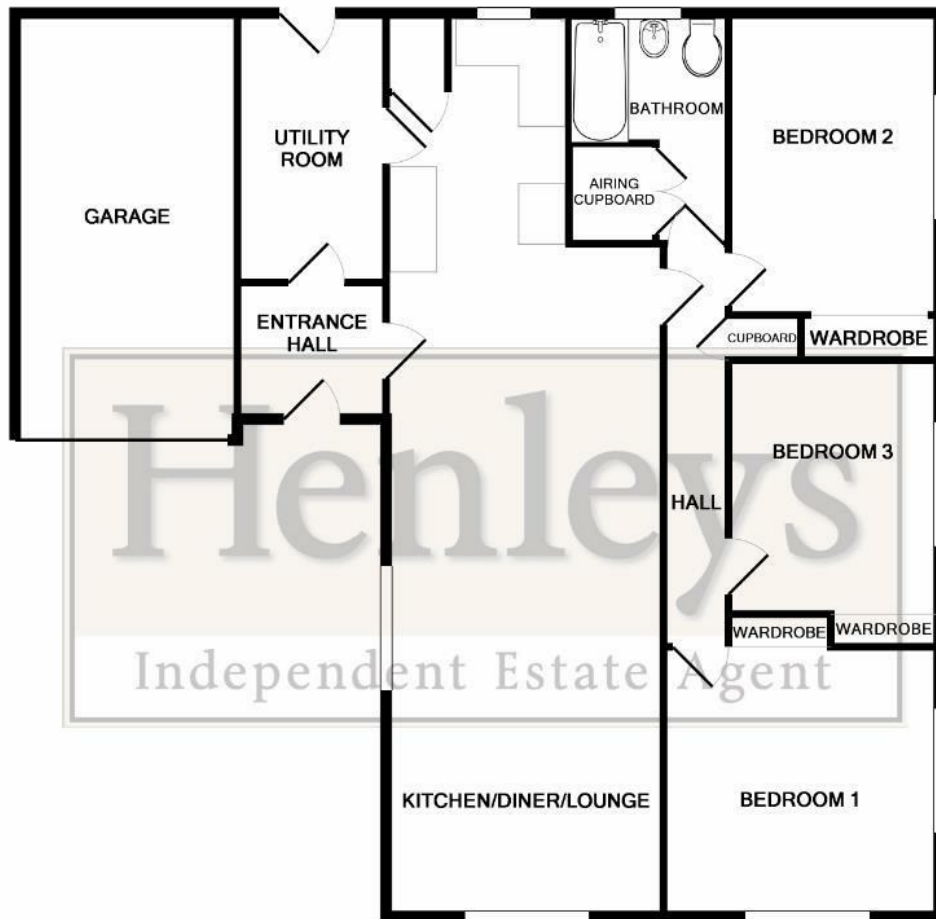

TOTAL APPROX. FLOOR AREA 1175 SQ.FT. (109.1 SQ.M.)

Whilst every attempt has been made to ensure the accuracy of the floor plan contained here, measurements of doors, windows, rooms and any other items are approximate and no responsibility is taken for any error, omission, or mis-statement. This plan is for illustrative purposes only and should be used as such by any prospective purchaser. The services, systems and appliances shown have not been tested and no guarantee as to their operability or efficiency can be given  
Made with Metropix ©2019

