



Birds Hill Road, Oxshott  
£27,000 PCM

**DAVIES**  
PROPERTY PARTNERS



## 15 Birds Hill Road

Oxshott, Leatherhead

Set within just under **1.2 acres** in the highly prestigious Crown Estate in Oxshott, this exceptional home offers an outstanding blend of scale, elegance and modern family living. Approached via electric gates and an extensive driveway, the property makes an immediate impression with its imposing yet welcoming façade.

Council Tax band: H

Tenure: Freehold

EPC Energy Efficiency Rating: C

EPC Environmental Impact Rating: D

- Located in the prestigious Crown Estate in Oxshott
- Set within 1.18 acres of private, landscaped grounds
- Impressive, gated entrance with extensive driveway and ample parking
- Stunning open-plan kitchen, breakfast and family room
- Seven bedrooms including a luxurious principal suite
- Self-contained apartment ideal for au pair or extended family



Call us to arrange a viewing on (01932) 588288



# Birds Hill Road, Oxshott, Surrey, KT22

Approximate Gross Internal Area = 1014.5 sq m / 10920 sq ft  
(Including Garage & Gym)

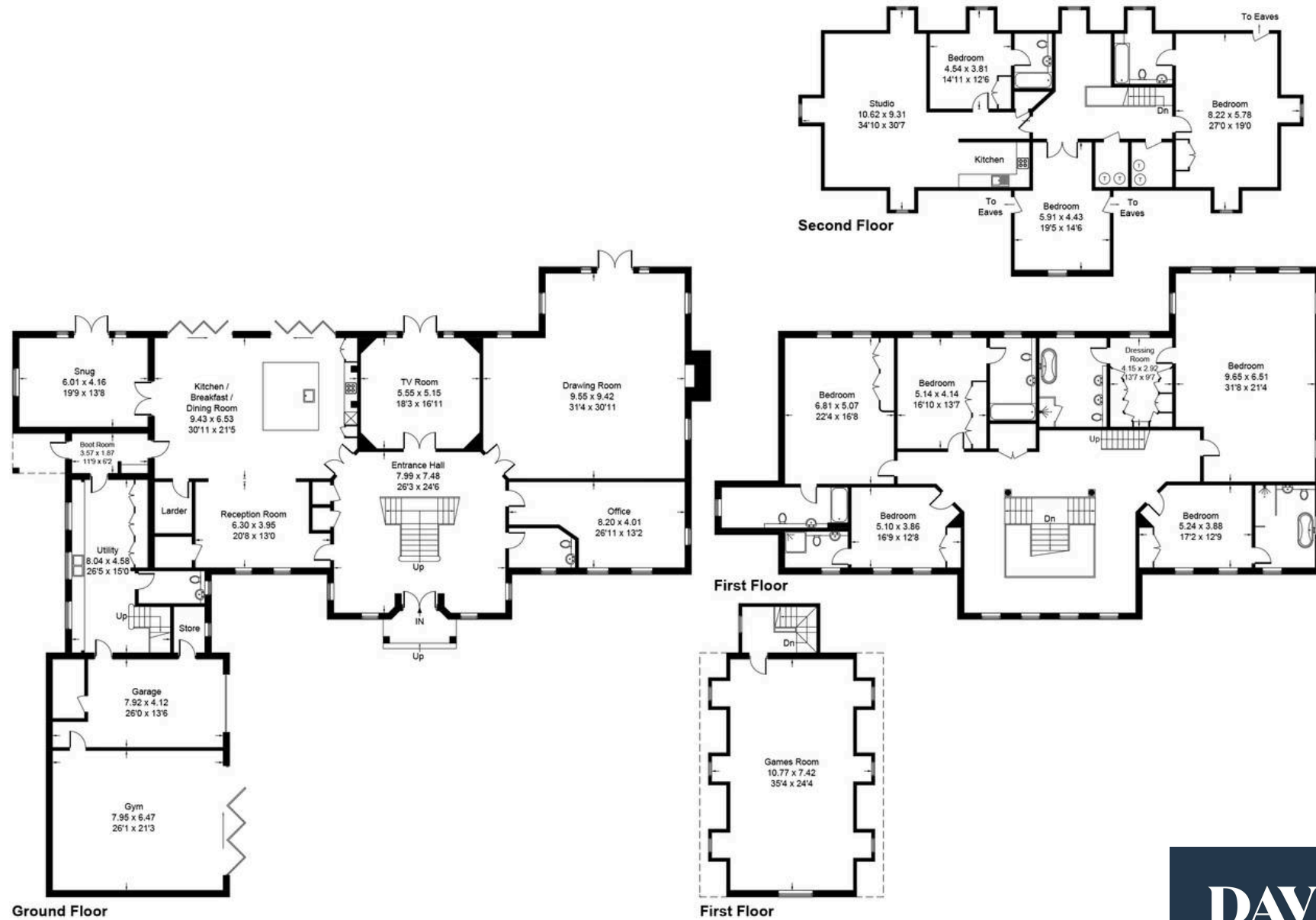
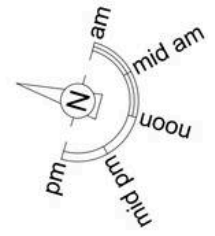

Floor plan produced in accordance with RICS Property Measurement Standards incorporating International Property Measurement Standards (IPMS2 Residential).  
Produced for DAVIES PROPERTY PARTNERS by IDENTIKA LTD

