



Connells

Park Prewett Road
Basingstoke



Property Description

Situated in a popular residential location, this well-presented two bedroom terraced home offers modern living in a welcoming and convenient setting. The property features a spacious lounge, perfect for relaxing or entertaining guests, alongside a contemporary kitchen designed with both style and practicality in mind. A downstairs WC adds to the home's everyday convenience.

Upstairs, you'll find two generously sized bedrooms, each providing ample space for rest and storage. The well-appointed family bathroom serves both bedrooms, ensuring comfort and functionality for all residents.

To the rear, an enclosed garden provides a peaceful outdoor retreat. The property also benefits from an allocated parking space, adding extra convenience for residents and visitors alike.

The home enjoys a fantastic location within easy reach of local shops, reputable schools, and a variety of leisure facilities. Excellent transport links and nearby parks make it an attractive choice for commuters and families seeking both tranquillity and accessibility.



Area

Situated in the popular residential area of Rooksdown, the property is local to convenience stores, schools, cafe's, a pharmacy and the North Hampshire Hospital. There are plenty of parks close by, including Rooksdown Park providing opportunity for walks and fresh air. The Basingstoke Town Centre is just under three miles away, housing the Festival Place Shopping Centre and The Malls with a variety of shops, restaurants, bars, and entertainment facilities. There are bus stops nearby with regular services into the Town Centre. The Basingstoke Train Station has a direct line to London Waterloo and the M3, A33 and A339 are all easily accessible via car, making the location perfect for travel and commuting.







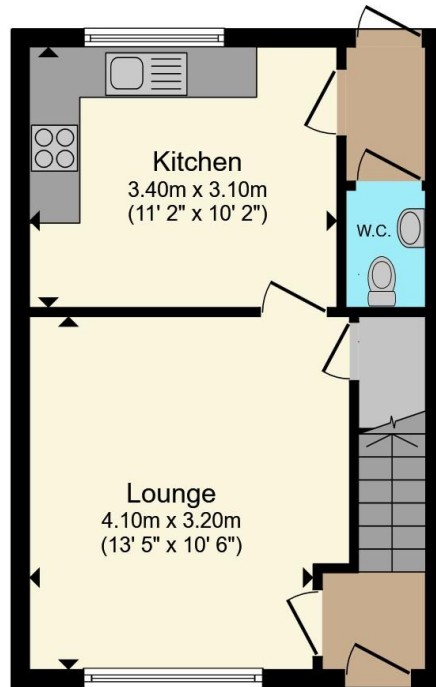

Ground Floor

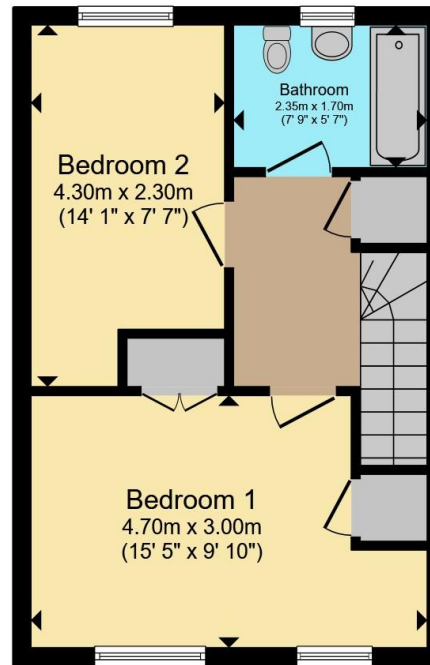

First Floor

Total floor area 69.6 m² (749 sq.ft.) approx

This floor plan is for illustrative purposes only. It is not drawn to scale. Any measurements, floor areas (including any total floor area), openings and orientation are approximate. No details are guaranteed, they cannot be relied upon for any purpose and they do not form part of any agreement. No liability is taken for any error, omission or misstatement. A party must rely upon its own inspection(s). Powered by www.propertybox.io



To view this property please contact Connells on

T 01256 464566
E basingstoke@connells.co.uk

1 Wote Street
 BASINGSTOKE RG21 7NE

EPC Rating: Council Tax
 Awaited Band: C

Tenure: Freehold

view this property online connells.co.uk/Property/BTK314914



1. MONEY LAUNDERING REGULATIONS Intending purchasers will be asked to produce identification documentation at a later stage and we would ask for your co-operation in order that there will be no delay in agreeing the sale. 2. These particulars do not constitute part or all of an offer or contract. 3. The measurements indicated are supplied for guidance only and as such must be considered incorrect. Potential buyers are advised to recheck measurements before committing to any expense. 4. We have not tested any apparatus, equipment, fixtures, fittings or services and it is in the buyers interest to check the working condition of any appliances.

Connells Residential is registered in England and Wales under company number 1489613, Registered Office is Cumbria House, 16-20 Hockliffe Street, Leighton Buzzard, Bedfordshire, LU7 1GN. VAT Registration Number is 500 2481 05.

See all our properties at www.connells.co.uk | www.rightmove.co.uk | www.zoopla.co.uk

Property Ref: BTK314914 - 0002