

Towers Wills

Town & Country

📞 01935 577 032 | 01460 298 530 | ✉ info@towerswills.co.uk



6, Aldondale Gardens, Yeovil, Somerset BA20 1QU

£325,000

Towers Wills welcome an absolutely stunning three-bedroom home enjoying glorious views across Nine Springs Country Park. Beautifully presented throughout, the accommodation comprises an entrance hall, modern kitchen/diner with integrated appliances, spacious living room with balcony, master bedroom with en-suite, two further bedrooms and a family bathroom. Outside benefits include driveway parking and a large rear garden. Internal inspection is highly recommended.

Accommodation:

The location makes Aldondale Gardens a hidden gem that many will have admired from afar whilst enjoying a stroll through the beautiful Nine Springs Country Park. Occupying an enviable position with uninterrupted views across the park, this exceptional home offers a rare opportunity to enjoy a lifestyle immersed in nature, whilst remaining conveniently close to local town amenities. A viewing is essential to fully appreciate both the quality of the accommodation and the spectacular setting on offer.

Stepping inside, a welcoming reception hallway leads through to the heart of the home; a stunning open-plan kitchen and dining space designed with modern family living and entertaining in mind. The kitchen is beautifully appointed with a range of fitted units and integrated appliances including a dishwasher, induction hob with cooker hood over, single oven and integrated microwave. A breakfast bar provides a natural gathering point and seamlessly connects the kitchen to the dining area, where there is ample space for a large dining table, perfect for hosting family and friends.

The spacious living room is wonderfully relaxing area enhanced by the glorious outlook beyond. Large patio doors frame the views across Nine Springs, whilst opening onto the balcony, undoubtedly one of the property's standout features. Whether enjoying a morning coffee, an evening glass of wine or simply taking in the changing seasons, this elevated vantage point provides the perfect place to appreciate the surrounding countryside. The ground floor further benefits from luxurious underfloor heating throughout and a beautifully fitted family bathroom comprising a bath with shower over, wash hand basin set within a vanity unit, WC, heated towel rail and stylish tiling.

The first floor offers three well-proportioned bedrooms. The master bedroom enjoys fitted wardrobes and a luxurious en-suite shower room featuring a walk-in shower enclosure, vanity wash hand basin, WC, skylight and heated towel rail. Bedroom two is a comfortable double room enjoying the same stunning outlook across the park, whilst bedroom three provides an ideal guest bedroom, nursery or home office.

Outside:

Outside, the property continues to impress. A driveway provides off-road parking and there's a private gravel road with additional parking, whilst gated side access leads to the rear garden. The balcony has been thoughtfully extended to create a private wraparound private sun terrace, offering additional outdoor seating and entertaining space. Steps lead down to a sheltered area and a highly practical basement level with power and lighting, providing excellent utility space with plumbing for a washing machine, space for a tumble dryer and useful storage facilities.

The garden itself is a true delight, predominantly laid to lawn with raised planted borders and mature shrubs adding colour and interest throughout the seasons. Beyond, a spacious decked seating area enjoys a tranquil

Key Features

- Immaculately Presented Throughout
- Semi-Detached
- Three Bedrooms
- Master with En-suite
- Driveway Parking
- Large Garden
- Glorious Views across Nine Springs

Contact Us

Towers Wills Estate Agents - Yeovil

114, Hendford Hill
Yeovil

Somerset

BA202RF

T: 01935 577032

E: info@towerswills.co.uk

Energy Efficiency

Score	Energy rating	Current	Potential
92+	A		
81-91	B		
69-80	C		71 C
55-68	D		
39-54	E		
21-38	F	32 F	
1-20	G		

setting overlooking a gently flowing stream and the natural beauty of Nine Springs Country Park, creating a peaceful retreat that feels a world away from everyday life.

A truly special home in an outstanding setting, offering an enviable blend of modern comfort, versatile living space and breathtaking surroundings. Internal inspection is highly recommended.



Floor Plan

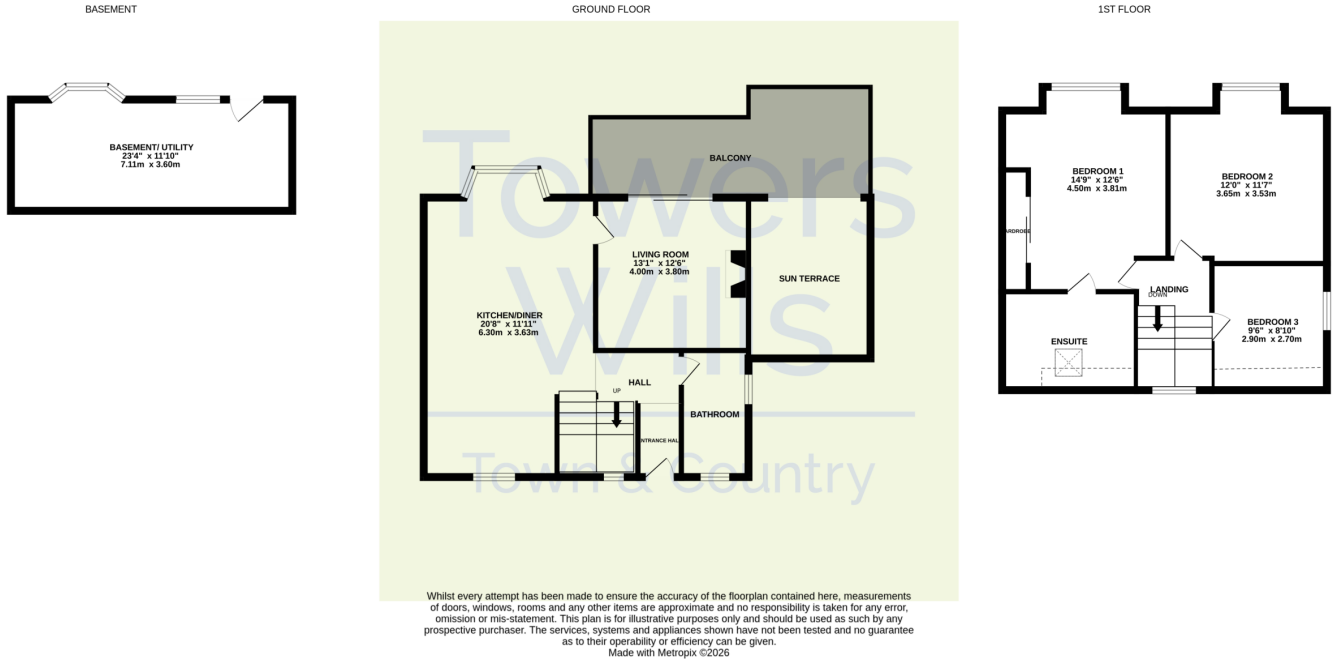

Please Note No tests have been undertaken of any of the services and any intending purchasers should satisfy themselves in this regard. Towers Wills Ltd for themselves and for the vendor of this property whose agents they are, give notice that, (i) these particulars do not constitute any part of an offer or contract, (ii) all statements contained within these particulars are made without responsibility on the part of Towers Wills or the vendor, (iii) whilst made in good faith, none of the statements contained within these particulars are to be relied upon as a statement of representation or fact, (iv) any intending purchaser must satisfy him/herself by inspection or otherwise as to the correctness of each of the statements contained within these particulars, (v) the vendor does not make or give either Towers Wills or any person in their employment any authority to make or give representation or warranty whatsoever in relation to this property.

Photographs / Floor Plans Photographs are reproduced for general information and it must not be inferred that any item is included for sale with this property. Please note floor plans are not to scale and are for identification purposes only. The photographs used in these particulars may have been taken with the use of a wide angle lens. If you have any queries as to the size of the accommodation or plot, please address these with the agent prior to making an appointment to view