



35 Boughey Road, Newport, TF10 7QF
Offers In The Region Of £249,995

This semi-detached house on Boughey Road is a fantastic opportunity for anyone seeking a spacious and modern home in Newport. With its generous living areas, modern kitchen and bathroom, and a lovely garden, it is sure to impress. Don't miss the chance to make this charming property your own.

Front Exterior

The front exterior presents a neat, gravelled area with a small circular, grass lawn and flower bed. This welcoming frontage offers parking space for multiple vehicles.

Hallway

The hallway welcomes you into the home with wood-effect flooring and subtle wall colours, leading through to the main living areas and stairs to the first floor. A practical layout provides easy access to the cloakroom and kitchen.

Lounge 11'2" x 19'1" (3.39m x 5.82m)

This spacious lounge features two large windows allowing ample natural light to fill the room. The neutral carpeting paired with light wall tones provides a calm and welcoming atmosphere, ideal for relaxing or entertaining.

Kitchen 9' x 8'1" (2.74m x 2.47m)

The kitchen is well-appointed with sleek, black, gloss cabinetry and integrated appliances including a gas oven and hob. Further space is available for a fridge-freezer and plumbing for a washing machine or dishwasher. Access to the garden is available through a door to the rear.

Dining Room 13'4" max x 10'8" (4.07m max x 3.25m)

Adjoining the kitchen, the dining room is bright with natural light from sliding patio doors leading directly to the rear garden. The room comfortably holds a large dining table and features a warm wooden floor and neutral walls, creating an inviting space for meals and gatherings. There is also the added benefit of a storage cupboard.

WC

A useful ground-floor cloakroom, with stylish subway tiled walls, basin and low-level flush WC.

Landing

The first-floor landing serves as a connecting space between bedrooms and the shower room. Featuring a storage cupboard and loft hatch leading to the partially boarded loft space.

Bedroom 1 9'1" x 12'5" (2.76m x 3.79m)

This bright and airy bedroom offers sufficient space for a double bed and features a large window that fills the room with daylight. Neutral décor and carpeting create a peaceful retreat, complemented by access to an adjacent dressing area, enhancing storage and functionality.

Study/Dressing Area 9'1" x 6'4" (2.76m x 1.92m)

The dressing area adjoins the largest bedroom and provides excellent space for wardrobes and storage. It features a window allowing natural light and a laminate floor for easy maintenance.

Bedroom 2 8'2" x 8'4" (2.48m x 2.53m)

A secondary bedroom with a cosy feel, featuring a window that allows natural light. The room is neutrally decorated and carpeted, suitable for a double bed and additional furniture as required.

Bedroom 3 8'2" x 10'5" (2.48m x 3.19m)

Another bedroom on the first floor, offering space for a single or small double bed with additional furniture.

Shower Room

The shower room has been tastefully updated, ensuring a fresh and stylish environment. Featuring a modern, white vanity unit fitted with a basin and low-level flush WC. A large walk-in shower enclosure with a mains-fed shower unit. Finished off with grey shower panelling, a chrome heated towel rail and grey wood-effect laminate flooring.

Rear Garden

The rear garden features a paved patio area ideal for outdoor seating and entertaining. Beyond the patio, a lawn is enclosed by a combination of high wooden fences and brick walls, offering privacy and a safe space for children or pets.

Floor Plan

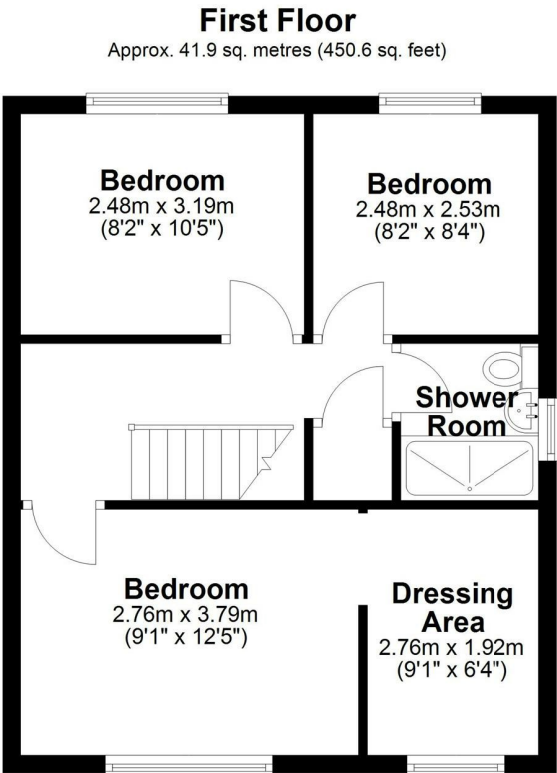
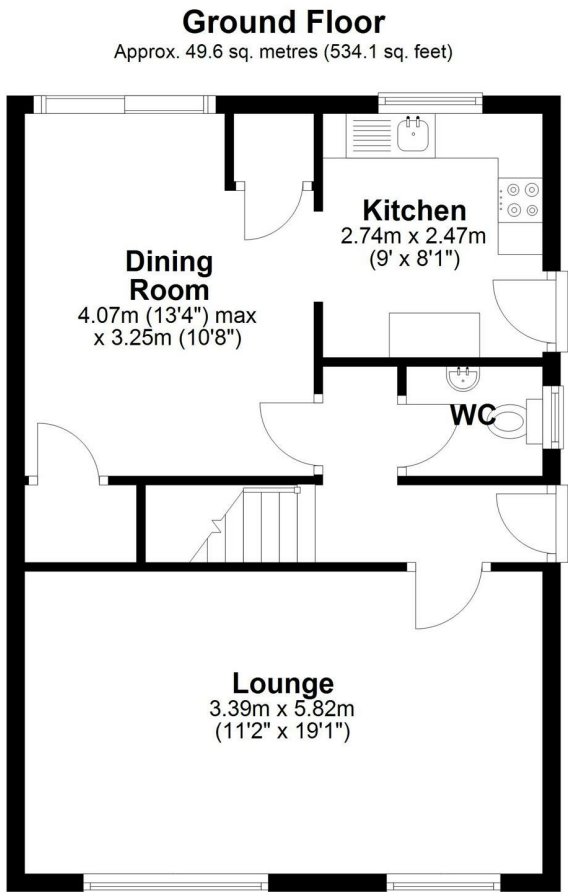

Total area: approx. 91.5 sq. metres (984.7 sq. feet)

Area Map

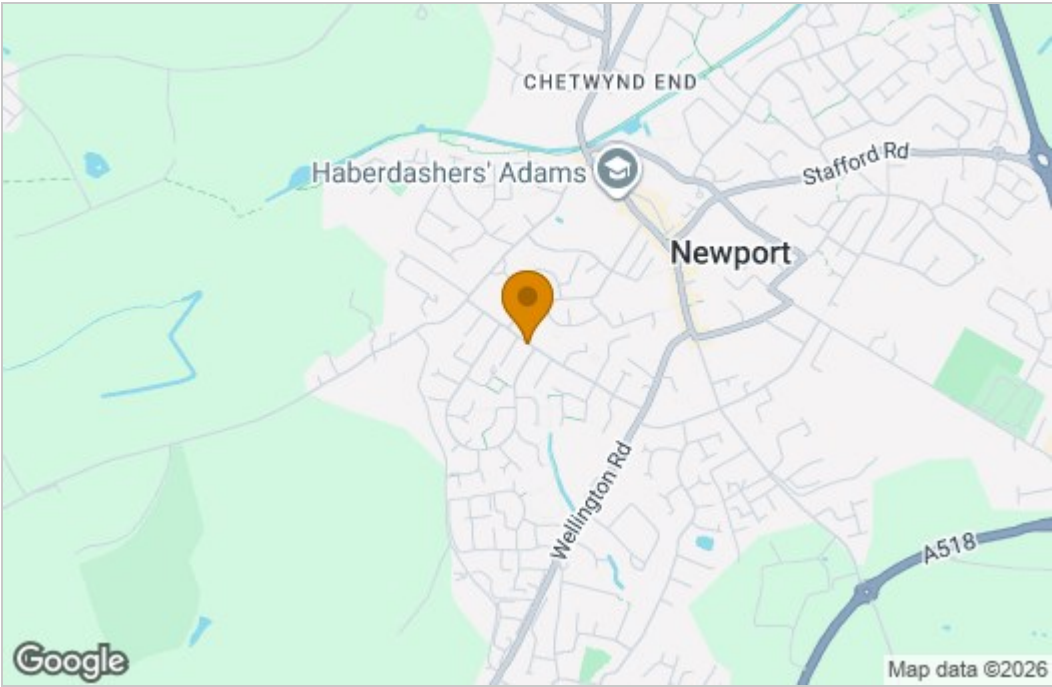

Energy Efficiency Graph

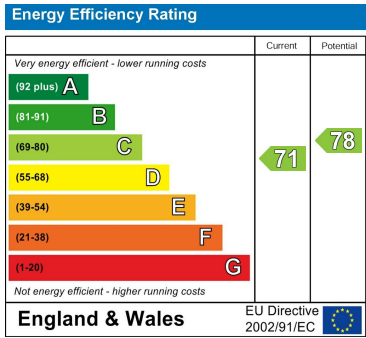

These particulars, whilst believed to be accurate are set out as a general outline only for guidance and do not constitute any part of an offer or contract. Intending purchasers should not rely on them as statements of representation of fact, but must satisfy themselves by inspection or otherwise as to their accuracy. No person in this firms employment has the authority to make or give any representation or warranty in respect of the property.