

158 Warton Terrace
Heaton
Newcastle upon Tyne
NE6 5DX

Offers Over
£185,000



158 Warton Terrace
Heaton
Newcastle upon Tyne
NE6 5DX

- Two Bedroom Ground Floor Flat
- Off Street Parking to the Rear Yard
- Nearby Shops & Bus Routes
- Sealed Unit Double Glazed Windows
- EPC C
- Great Modern Kitchen & Shower Room
- Immaculately Presented
- Gas Central Heating
- Council Tax Band A





Ground Floor

Approx. 61.3 sq. metres (659.4 sq. feet)

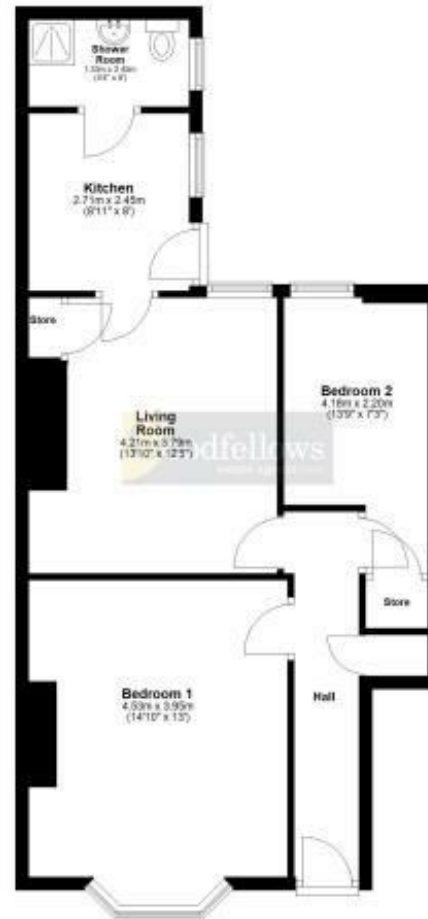

Total area: approx. 61.3 sq. metres (659.4 sq. feet)

Whilst every attempt has been made to ensure the accuracy of the floor plan contained here, measurements of doors, windows, rooms and any other items are approximate and no responsibility is taken for any error, omission, or mis-statement. The Plan is for illustrative purposes only. Version 1

Plan produced using PlanUp.

EPC Rating: C
Council Tax Band: A

Whilst every care has been taken to prepare these particulars, they are for guidance purposes only. All measurements are approximate and whilst every care has been taken to ensure their accuracy, they should not be relied upon and potential buyers/tenants are advised to recheck the measurements. The agent has not tested any equipment, services, fixtures or fittings and makes no representation regarding their condition.

CONTACT

246 Chilingham Road, Heaton,
Newcastle upon Tyne, NE6 5LQ

E: heaton@goodfellowsestateagents.com
T: 0191 2654400

Goodfellows
estate agents.com