



**Connells**

Bird Close  
Belgrave Village Birmingham

# Bird Close Belgrave Village Birmingham B12 9AP

for sale offers in the region of  
**£385,000**

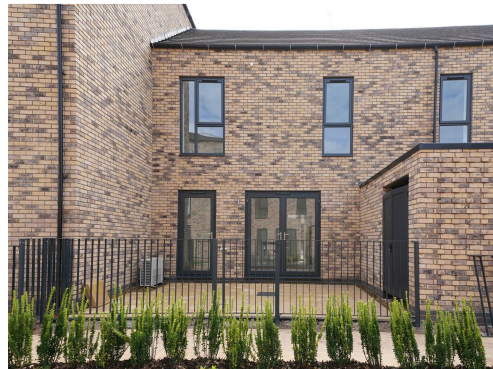

## Property Description

Located off Belgrave Middleway, you will find a thriving community called Belgrave Village. Occupying a site that had stood vacant for over 20 years, this development is an exciting contribution to Birmingham city centre.

Just moments away from Birmingham's thriving commercial centre, New Street Station and Grand Central shopping centre, Belgrave Village is a landmark development providing 438 city centre homes in a combination of one and two-bedroom apartments and two, three and four-bedroom houses.

Residents of Belgrave Village can benefit from living within a green oasis whilst being in Birmingham city centre.

## Entrance Hallway

## Kitchen/Diner/Lounge

22' Max x 22' 11" Max ( 6.71m Max x 6.99m Max )

## Bedroom 1

12' 11" x 9' 1" ( 3.94m x 2.77m )

Access to ensuite

## Ensuite

## Bedroom 2

13' 3" x 9' 2" ( 4.04m x 2.79m )

## Bedroom 3

9' 2" x 9' 4" ( 2.79m x 2.84m )

## Family Bathroom

## Outside

Communal Gardens.  
Private Larger Rear Terrace  
Allocated Parking Space.



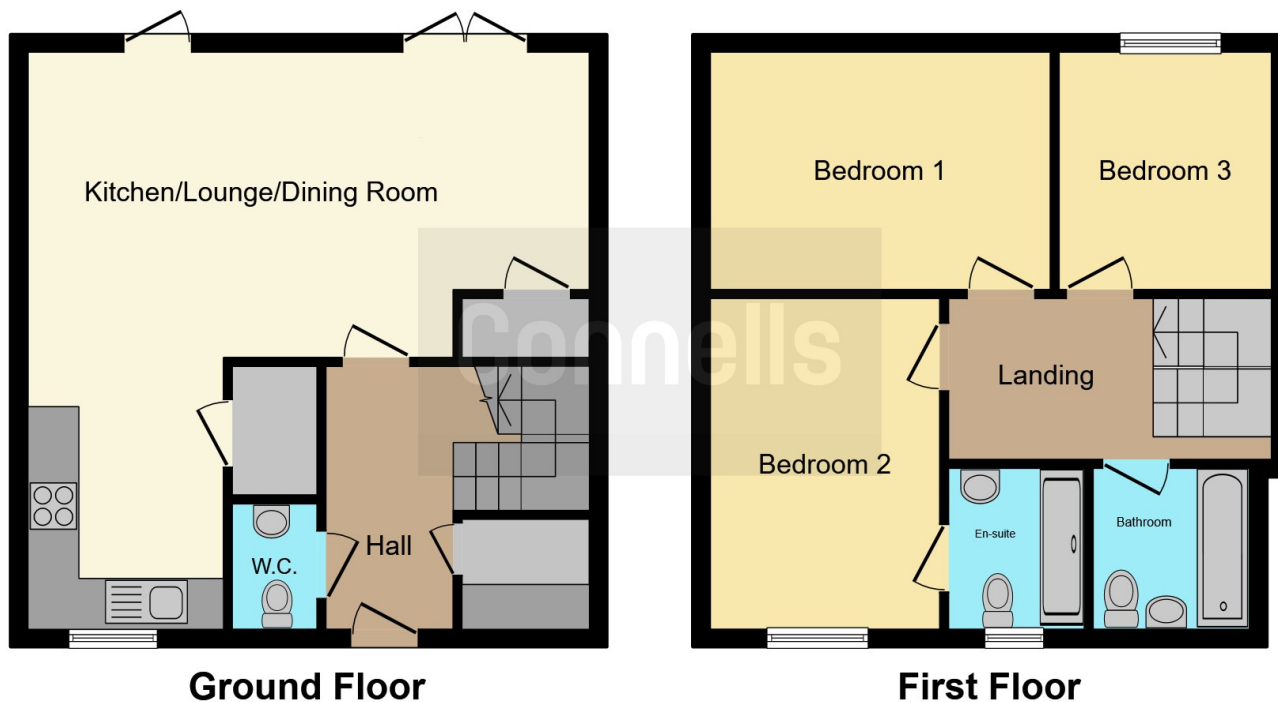

This floor plan is for illustrative purposes only. It is not drawn to scale. Any measurements, floor areas (including any total floor area), openings and orientation are approximate. No details are guaranteed, they cannot be relied upon for any purpose and they do not form part of any agreement. No liability is taken for any error, omission or misstatement. A party must rely upon its own inspection(s). Powered by [www.focalagent.com](http://www.focalagent.com)

To view this property please contact Connells on

**T 0121 212 0800**  
**E [birminghamcity@connells.co.uk](mailto:birminghamcity@connells.co.uk)**

145 Great Charles Street Queensway  
 BIRMINGHAM B3 3LP

EPC Rating: B

**view this property online [connells.co.uk/Property/DIG112001](http://connells.co.uk/Property/DIG112001)**



Tenure: Freehold



1. MONEY LAUNDERING REGULATIONS Intending purchasers will be asked to produce identification documentation at a later stage and we would ask for your co-operation in order that there will be no delay in agreeing the sale. 2. These particulars do not constitute part or all of an offer or contract. 3. The measurements indicated are supplied for guidance only and as such must be considered incorrect. Potential buyers are advised to recheck measurements before committing to any expense. 4. We have not tested any apparatus, equipment, fixtures, fittings or services and it is in the buyers interest to check the working condition of any appliances.

Connells Residential is registered in England and Wales under company number 1489613, Registered Office is Cumbria House, 16-20 Hockliffe Street, Leighton Buzzard, Bedfordshire, LU7 1GN. VAT Registration Number is 500 2481 05.

**See all our properties at [www.connells.co.uk](http://www.connells.co.uk) | [www.rightmove.co.uk](http://www.rightmove.co.uk) | [www.zoopla.co.uk](http://www.zoopla.co.uk)**

Property Ref: DIG112001 - 0003